



Elmfield Way, W9

£525,000

A first floor flat in a purpose-built block. The property offers two double bedrooms, two bathrooms and separate kitchen with a spacious reception room which leads out to the balcony. Further benefits include good storage and a private parking space.

Elmfield Way is a residential road with quick access to multiple transport links and local shops, cafés and amenities nearby. The flat benefits from views of the Regents Canal that is opposite to the development, which is great for walks and cycling and leads to Little Venice which is a short distance away.

Features

- Two Double Bedrooms
- Two Bathrooms
- Allocated Secure Parking
- New Build Development
- Private Roof Terrace
- 24hrs Security Desk

Elmfield Way, Maida Vale, W9

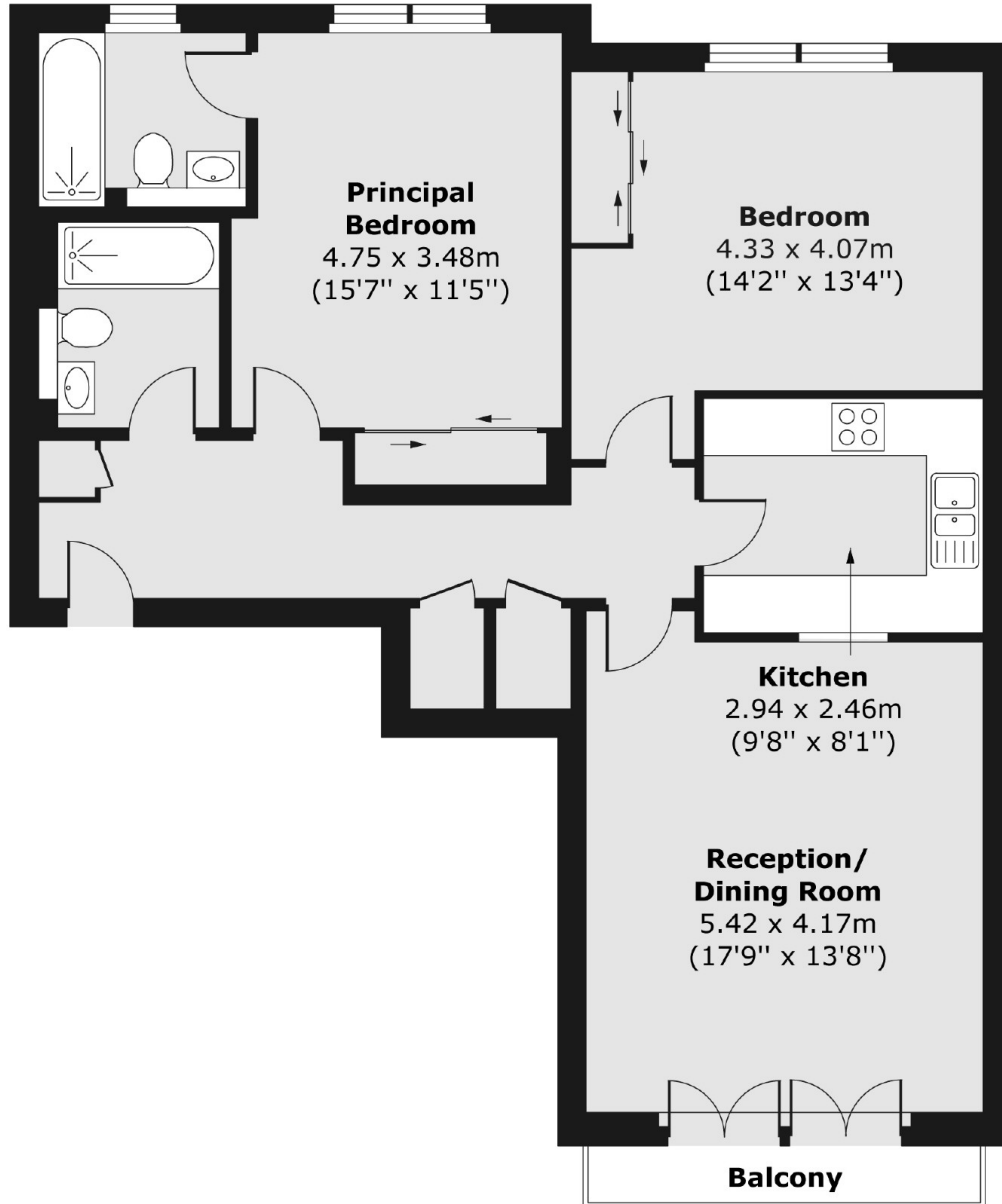

Total area (approx.) 82.17 sq. m (884 sq. ft)
Balcony area (approx.) 2.47 sq. m (27 sq. ft)

Dexters

Maida Vale
298 Elgin Avenue
London
W9 1JS
Sales
020 7266 2020

Energy Rating: C. We aim to make our particulars both accurate and reliable. However they are not guaranteed; nor do they form part of an offer or contract. If you require clarification on any points then please contact us, especially if you're traveling some distance to view. Please note that appliances and heating systems have not been tested and therefore no warranties can be given as to their good working order.

 **RICS** | Regulated
Estate Agent
and Letting Agent

[dexters.co.uk](https://www.dexters.co.uk)