



## Ashmore Road, W9

£500,000

This first-floor flat, part of a Victorian conversion, features two double bedrooms. The property includes ample storage, a spacious reception and dining room, and a separate kitchen. It also offers a well-sized bathroom, high ceilings, and newly refurbished sash windows.

Ashmore Road offers excellent access to Queen's Park and Westbourne Park, with numerous transport links to Central London. It is also within a mile of Little Venice, Portobello, and Paddington Recreation Ground.

### Features

- Victorian Conversion
- Recently Refurbished
- Chain Free
- High Ceilings
- Great Transport Links
- EPC Rating C

# Ashmore Road, Maida Vale, W9

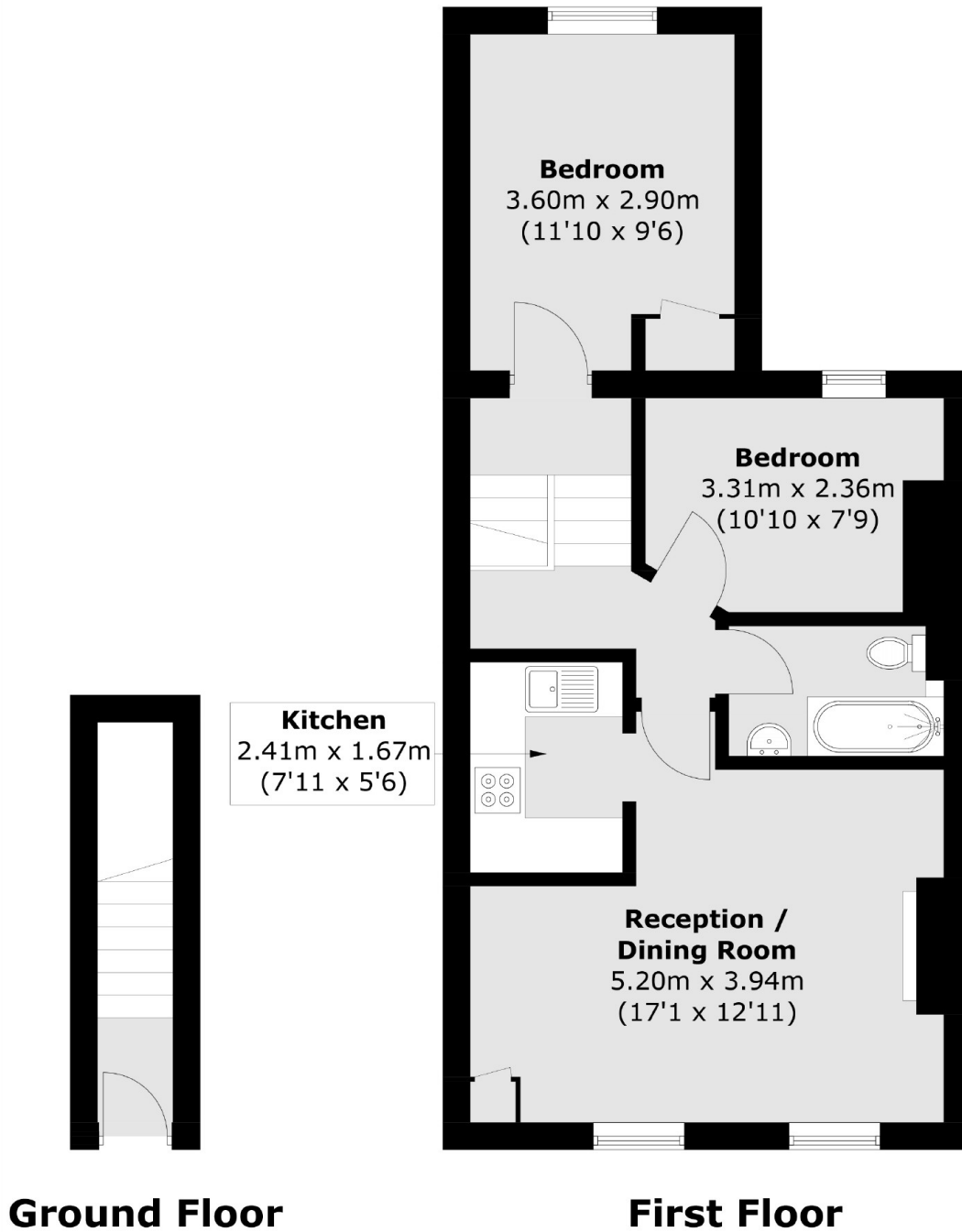

Total area (approx.): 56.8 sq. m (611.4 sq. ft)