



Harrow Road, W9

£649,950

A three-bedroom, one-bathroom split-level flat offers over 1010 square feet of contemporary living space in a purpose-built complex. Situated on the ground and first floor it comes with a private entrance and garden.

The Closest Tube Station is Westbourne Park (Circle and Hammersmith and City Lines) other Tube Stations are Warwick Avenue (Bakerloo Line), Royal Oak Tube Station (Circle and Hammersmith and City Lines)

Features

- Private Entrance
- Rental Investment
- Private Garden
- Split-Level
- Separate Kitchen
- Chain Free

Harrow Road, Maida Vale, W9

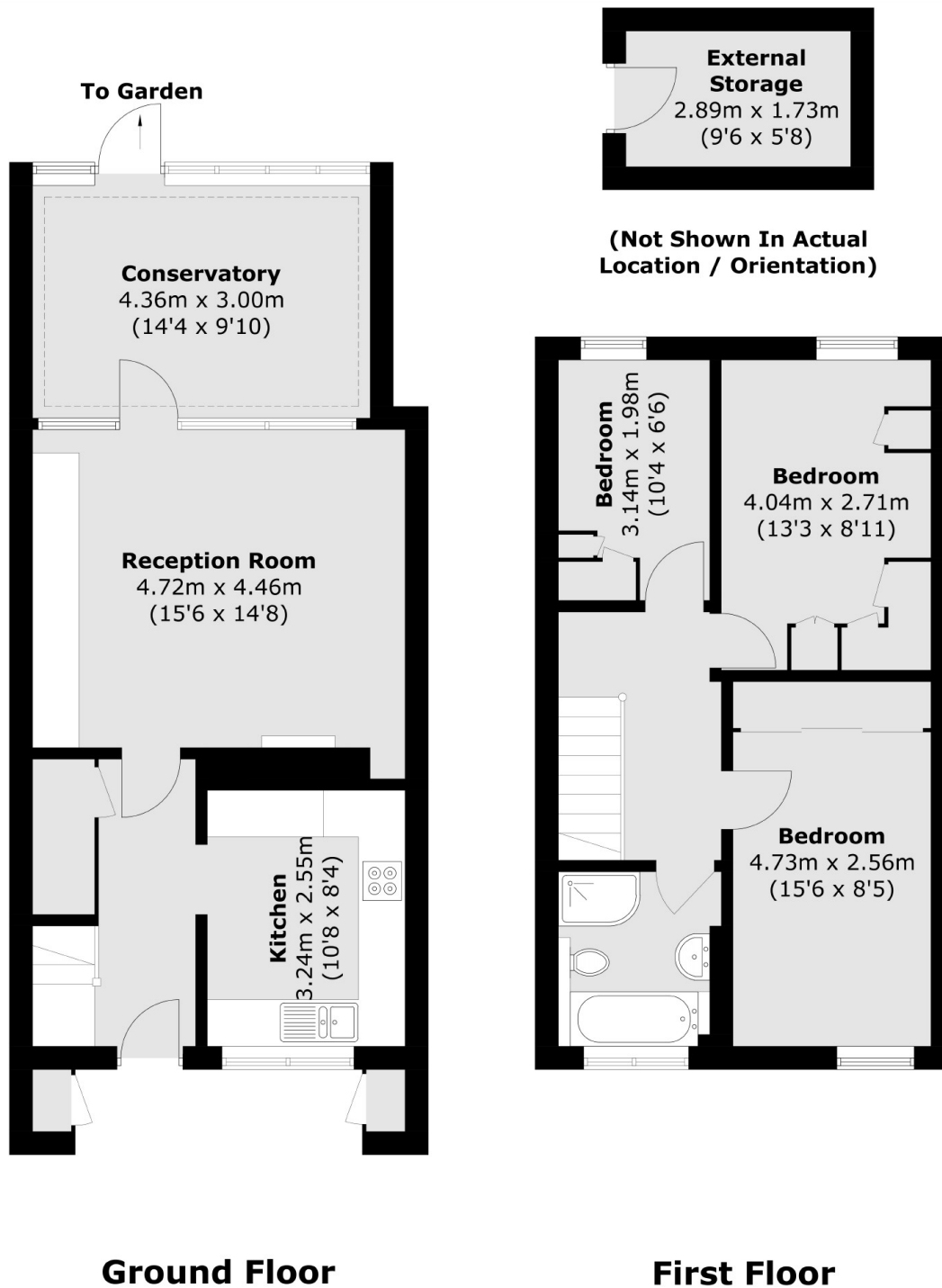

Total area (approx.): 94.6 sq. m (1,018.3 sq. ft)
External Storage & Cupboards area (approx.): 6.0 sq. m (64.6 sq. ft)