



Sutherland Avenue, W9

£2,700,000

Dexters



Sutherland Avenue, W9

Spanning over 1990 sq ft is this beautiful three bedroom maisonette, situated on the raised ground and lower ground floors of a Victorian terrace, located in the heart of Maida Vale.

The ground floor features a stunning reception room with three metre ceiling height, a feature fireplace and large french doors which open onto a private balcony, overlooking the charming communal gardens. There is also a large kitchen/dining room on this floor.

On the lower ground floor are three bedrooms, two of which are en suite. The principal bedroom is outstanding, with large windows, a walk-in wardrobe and doors which open onto a lovely, private patio garden, with steps leading to the landscaped communal gardens (with a tennis court).

Tree-lined with period buildings, Sutherland Avenue is one of the most popular roads in Maida Vale, offering easy access to Formosa Street, Warwick Avenue and Little Venice, for a great selection of shops, bars cafés, and restaurants.

Features

- Three Bedroom Maisonette
- Private Balcony & Patio
- Communal Gardens
- Tennis Court
- Share of Freehold
- Over 1990 Sq Ft







Sutherland Avenue, Maida Vale, W9

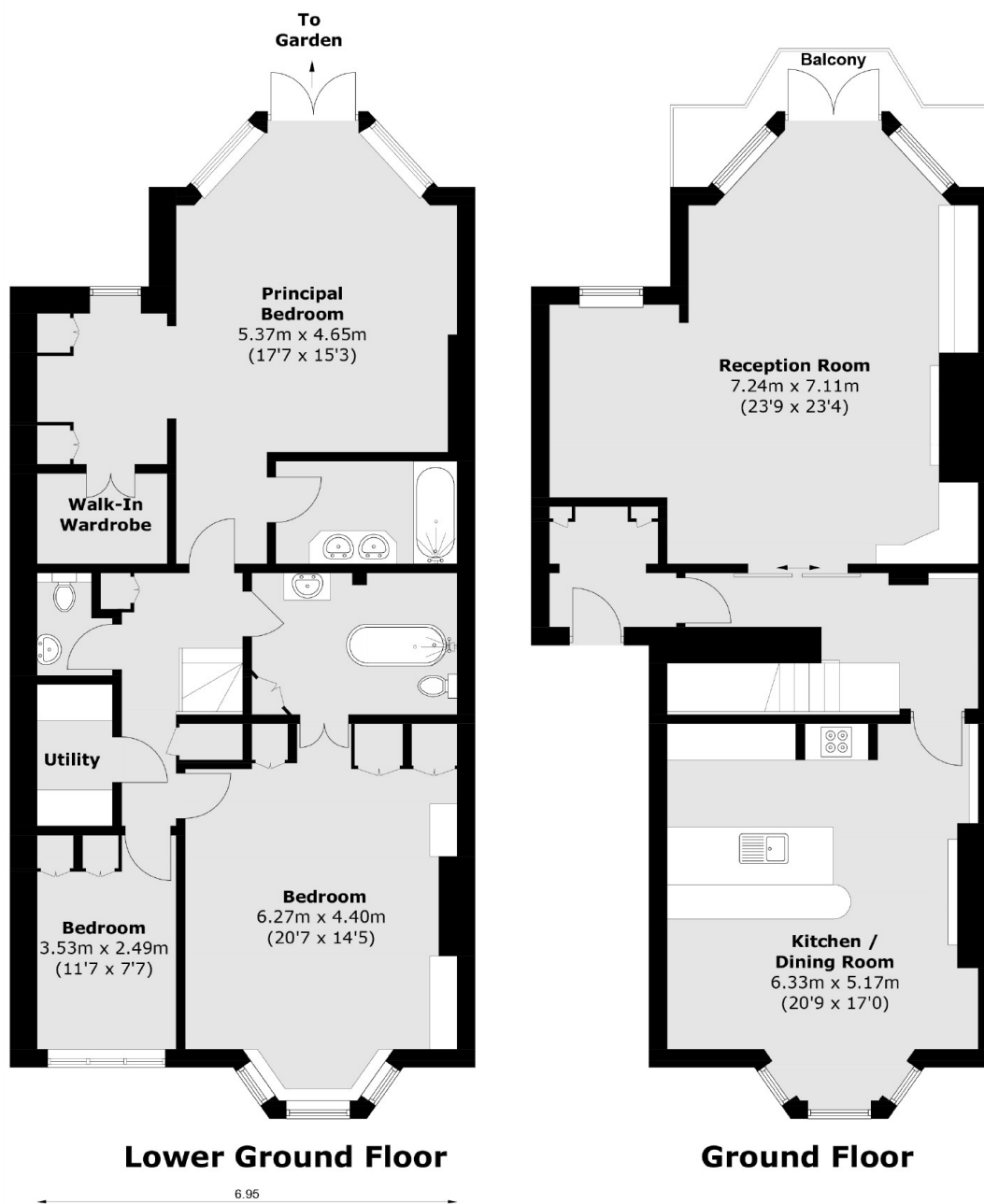

Total area (approx.): 185.6 sq. m (1,997.8 sq. ft)
Balcony: 5.4 sq. m (58.1 sq. ft)