



Ashmore Road, W9

£775,000

A stunning two double bedroom apartment recently refurbished to an excellent condition throughout. The apartment has a large open plan reception room/kitchen, with bi-folding doors that open onto a private patio area.

Ashmore Road is tree-lined and just around the corner from Queen's Park station (Bakerloo line and Overground). The local cafés, restaurants and shops of Little Venice are also nearby.

Features

- Two Double Bedrooms
- Private Patio
- Recently Renovated
- Share Of Freehold
- Open Plan Kitchen
- Great Transport Links

Ashmore Road, Maida Vale, W9

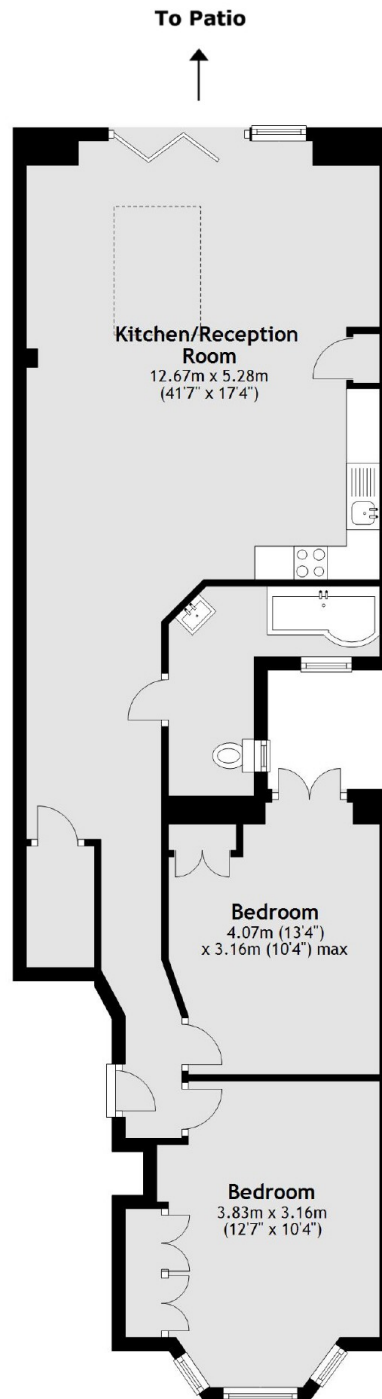

Total area: approx. 83.3 sq. metres (896.5 sq. feet)