

Ashmore Road, W9

£542 Per week

A two double bedroom garden flat in an end-of-terrace, period conversion building. In good condition throughout, with an open plan kitchen and living room, private rear garden and its own front door.

Ashmore Road is a quiet residential road, just one road away from Queen's Park and within a short walking distance of Maida Vale and Notting Hill.

Features

- Two Double Bedrooms
- Private Rear Garden
- Good Condition
- Own Front Door
- End Of Terrace
- Newly Refurbished

Ashmore Road,
Maida Vale, W9

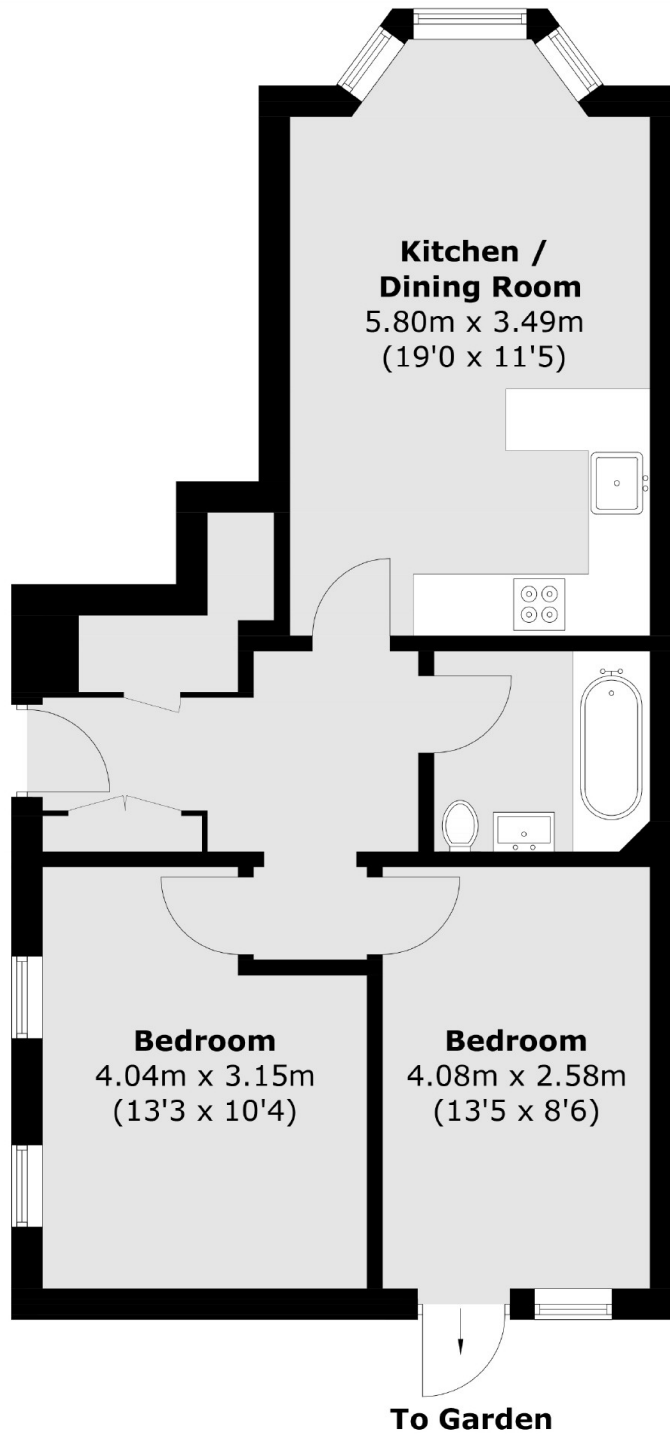

Total area (approx.): 58 sq. m (624.3 sq. ft)

Dexters

Maida Vale
298 Elgin Avenue
London
W9 1JS
Lettings
020 7266 2021

Energy Rating: Westminster City. We aim to make our particulars both accurate and reliable. However they are not guaranteed; nor do they form part of an offer or contract. If you require clarification on any points then please contact us, especially if you're traveling some distance to view. Please note that appliances and heating systems have not been tested and therefore no warranties can be given as to their good working order.

 **RICS** | Regulated
Estate Agent
and Letting Agent

dexters.co.uk