



## Brompton Square, London SW3

Price £3,500 per week - Part Furnished







## Description

A well-presented five storey, five bedroom house situated on the west side of this popular Knightsbridge square. The house is situated well into the square, and has an attractive west facing private garden.

The house further benefits from three reception rooms, a fully fitted kitchen, separate utility room, four bathrooms (one en suite) and a balcony and terrace on the upper floors.

Brompton Square is a prestigious address situated just to the north of Brompton Road, close to the shopping and transport facilities of Knightsbridge and South Kensington.

Rent is payable on a monthly basis and you may be required to pay more than a month's rent in advance, depending on your circumstances. You will be required to pay a 1 week holding deposit following a successful offer. Utility bills, council tax, telephone line and broadband are not included in the rent. As well as paying the rent, you may also be required to make some additional permitted payments. If your tenancy does not qualify as an AST, additional fees may apply. Please visit [jll.co.uk/fees](http://jll.co.uk/fees) for details of fees which may be payable when renting a property.

- Five bedrooms
- Four bathrooms (one en suite)
- Three reception rooms
- Separate utility room
- Five storey house
- Balcony
- Terrace
- Fully fitted kitchen
- Part-furnished
- EPC: E

# Floorplan

2,600 sq ft | 242 sq m

## Brompton Square, SW3

Approximate Internal Area = 2600 sq ft / 241.54 sq m

Vault = 64 sq ft / 5.95 sq m

Balconies = 58 sq ft / 5.39 sq m

Terrace = 51 sq ft / 4.74 sq m

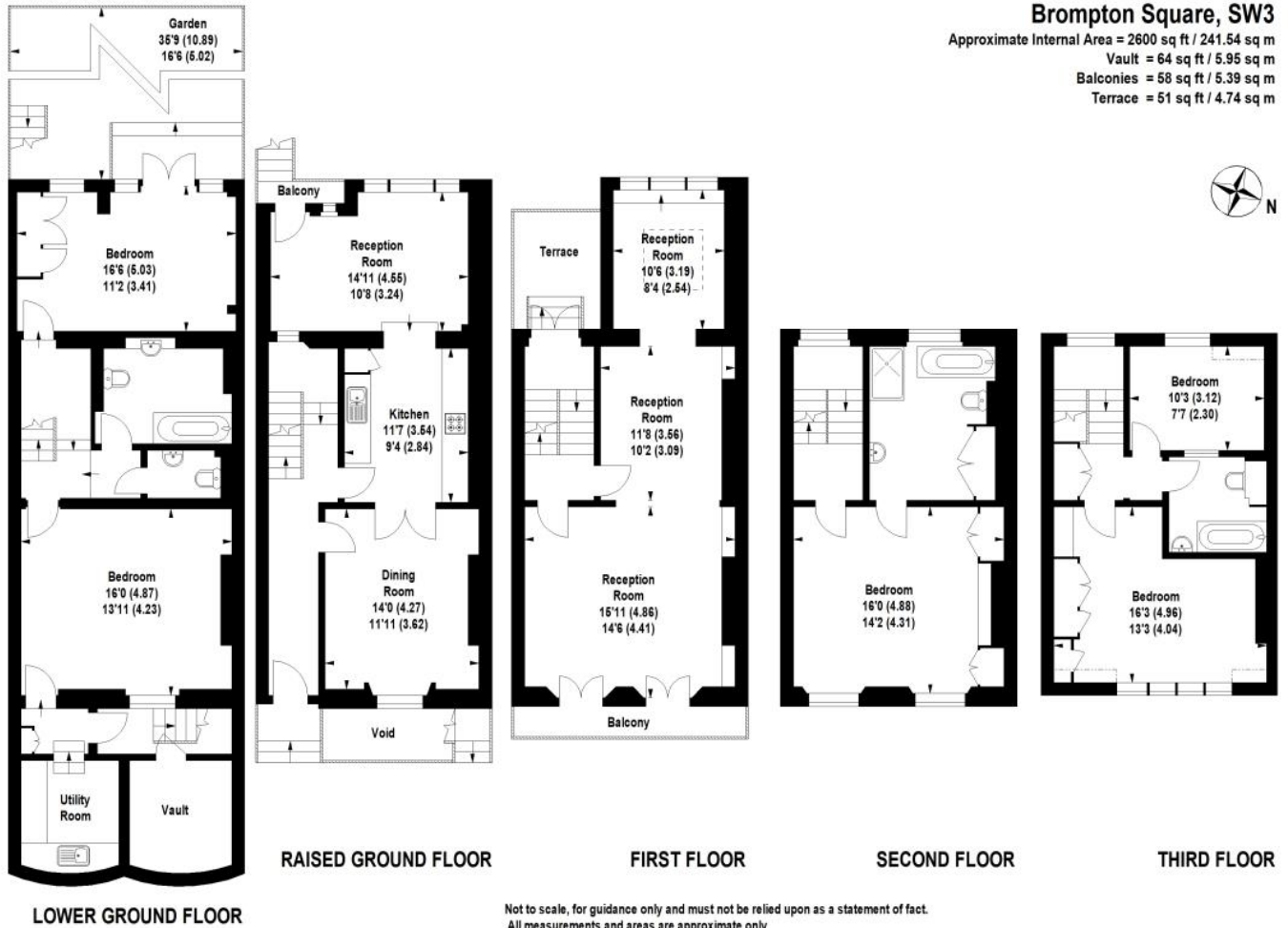

Knightsbridge  
174 Brompton Road,  
London SW3 1HP  
+4420 7306 1600  
SalesKnightsbridge@jll.com

*Urban living, your way.*

[jll.co.uk/residential](http://jll.co.uk/residential)

© 2019 Jones Lang LaSalle IP, Inc. All rights reserved. All information contained herein is from sources deemed reliable; however, no representation or warranty is made to the accuracy thereof.

