

Mark Stephenson's

ESTATE & LETTING AGENTS



18 Heron Close, Thornton-Le-Dale, Pickering, YO18 7SN

£377,000

- Available chain free
- Built originally as a 4 bed
- Excellent ground floor space
- Single attached garage
- Scope to enlarge we feel
- Extral large gardens
- Now 3 but easily reinstated
- Mains gas c/heating
- Some updating required

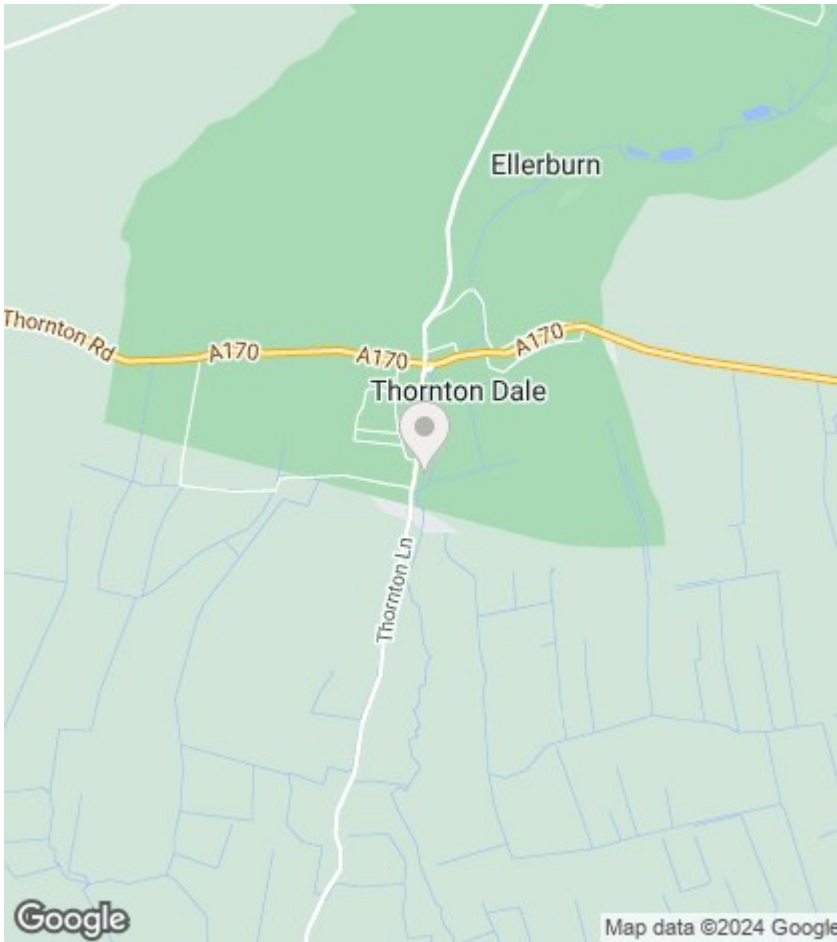

Directions

Viewings

Viewings by arrangement only. Call 01751 476900 to make an appointment.

Council Tax Band:

E

EPC Rating:

D

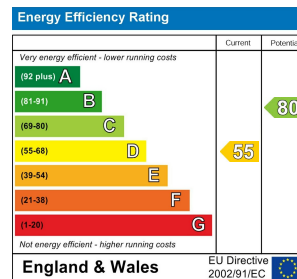

Total = 1498 sq ft - 139 sq m

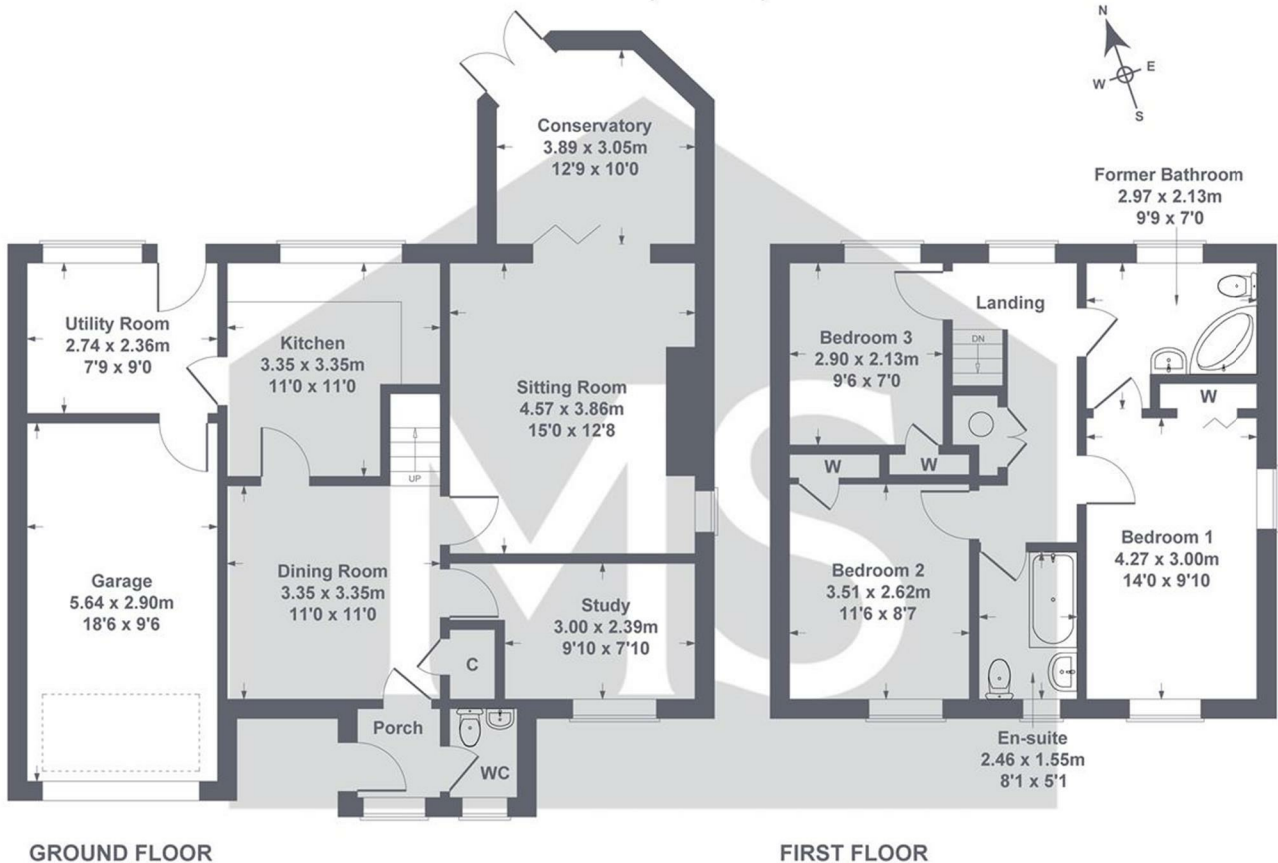

SKETCH PLAN FOR ILLUSTRATIVE PURPOSES ONLY

All measurements walls, doors, windows, fittings and appliances, their