



Lordship Close, Orwell, Royston
SG8 5TH

Pocock+Shaw

18 Lordship Close
Orwell
Royston
Hertfordshire
SG8 5TH

An immaculately presented and updated two bedroom bungalow for the over 60's sold on a 75% shared basis with SCDC. Located in the centre of the highly sought after village of Orwell.

- Porch and entrance hall
- Sitting room
- Two bedrooms
- Well fitted kitchen
- Shower wet room
- Electric underfloor heating and storage heaters
- Courtyard style rear garden
- No upward chain

Shared Ownership £213,750



Located in the centre of the highly sought after village of Orwell, this immaculately presented and updated two bedroom bungalow is for the over 60's and sold on a 75% shared basis with SCDC. Set in the corner of this small cul de sac, with communal parking and a small low maintenance courtyard style rear garden. No upward chain.

Entrance porch Glazed entrance door to:

Reception hall Access to loft space.

Store room 4'6" x 4'0" (1.37 m x 1.22 m) Power and light connected.

Sitting room 15'11" x 10'5" (4.85 m x 3.17 m) Window to the front, wall mounted electric storage heater.

Bedroom one 14'11" x 8'8" (4.55 m x 2.64 m) Window to the front, wall mounted electric storage heater.

Bedroom two 7'11" x 8'10" (2.41 m x 2.69 m) Window to the rear, wall mounted electric storage heater.

Kitchen 11'4" x 7'4" (3.45 m x 2.24 m) Fitted range of units with contrasting marble effect work surface. Inset single drainer stainless steel sink unit, range of matching base units. Inset four burner ceramic hob, and single oven beneath. Matching wall mounted cupboards. Window to the rear, and wall mounted electric heater. Serving hatch to sitting room

Shower wet room White suite with wall mounted wash basin and double drawers beneath. Close coupled wc and walk in shower area. Window to the rear, single airing cupboard.

Outside To the front there is a small open plan garden area. Pedestrian access to the rear, with gated access to the rear garden. Low maintenance with hard paving, and flower borders.

Storage shed 7'0" x 5'0" (2.13 m x 1.52 m) Brick construction.

Tenure Leasehold - 125 year lease from 02/10/2006
Service charge: £644.51 per quarter
Buildings insurance: £14.94
Ground rent: £6.50 per quarter

Services All mains services with the exception of gas.

Council Tax Band C

Viewing By Arrangement with Pocock + Shaw



EPC awaited

Ground Floor

Approx. 58.6 sq. metres (631.2 sq. feet)

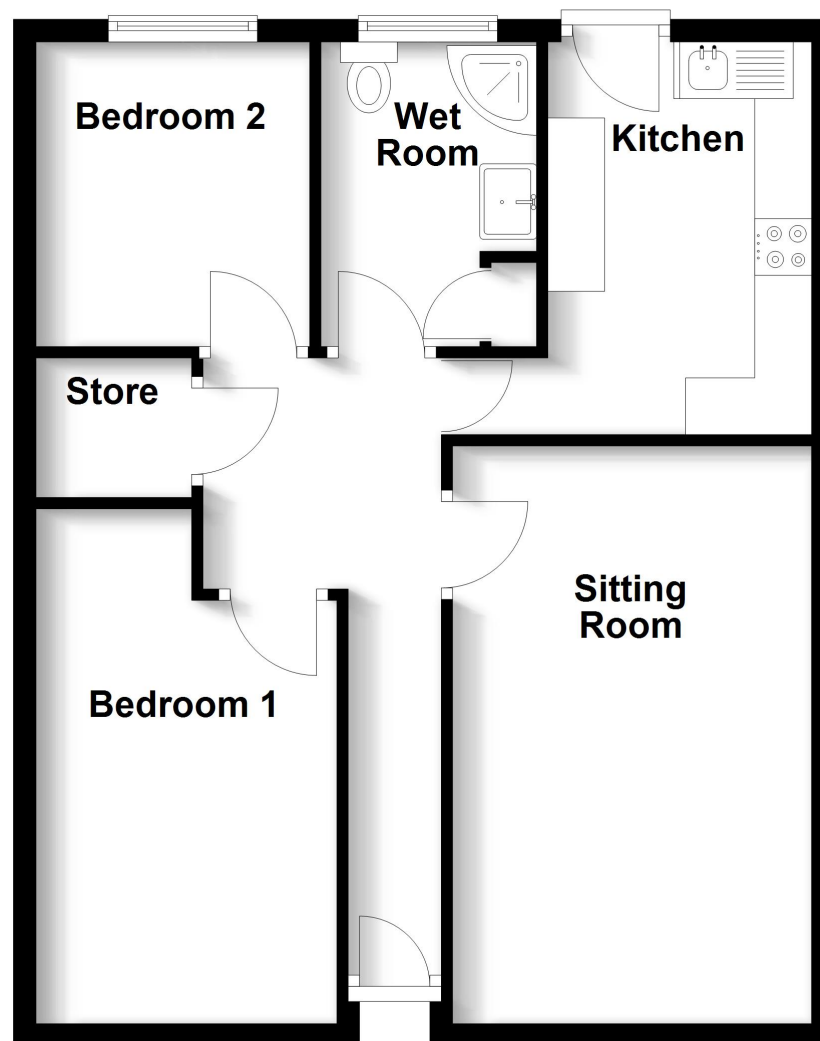

Agent's note: (i) Unless otherwise stated on the front page the information contained within these particulars has been provided and verified by the owner or his/her representative(s) and is believed to be accurate. All measurements are approximate. (ii) The vendor(s) reserve(s) the right to remove any fixtures, fittings, carpets, curtains or appliances unless specific arrangements are made for their inclusion in the sale. (iii) None of the electrical, heating or plumbing systems have been tested

Pocock + Shaw