



MEYER COURT, BUTTS ROAD

HEAVITREE, EXETER, EX2 5PW



Robert Williams

SALES | LETTINGS | AUCTIONS

“ Built by renowned retirement specialist McCarthy & Stone circa 2007 is this purpose built one bedroom apartment ”.



Meyer Court, Butts Road

HEAVITREE, EXETER, EX2 5PW

A one bedroom retirement apartment for over 60's built by McCarthy & Stone circa 2007 with living room, kitchen, shower room and one bedroom. The block is currently managed by Churchill Living.

The property is being sold with no onward chain.

The Property

The internal accommodation features one double bedroom with built in wardrobes, modern shower room, well fitted kitchen with integrated appliances, extensive store cupboard and large living room. The development has unallocated residents parking, communal gardens, laundry and guest suite. The service charge includes communal area upkeep, gardening, window cleaning, lift, 24 hour care line, house manager and water/sewerage charges.

The Location

This property is situated in the Heavitree area of Exeter with its good range of local shops, including supermarkets and a post office. There is a regular bus service to the city centre and easy access out of the city with local road links to the M5 and other major routes. The RD&E hospital is located nearby.

1		bedrooms	1		bathrooms
1		receptions	0		car spaces

Local Authority: Exeter Council

Council Tax Band: B

Tenure: Leasehold

Heating: Electric Storage Heaters

Services: Mains water and drainage

Energy Efficiency Rating: B





29, Meyer Court

Approximate Gross Internal Area = 50.6 sq m / 545 sq ft

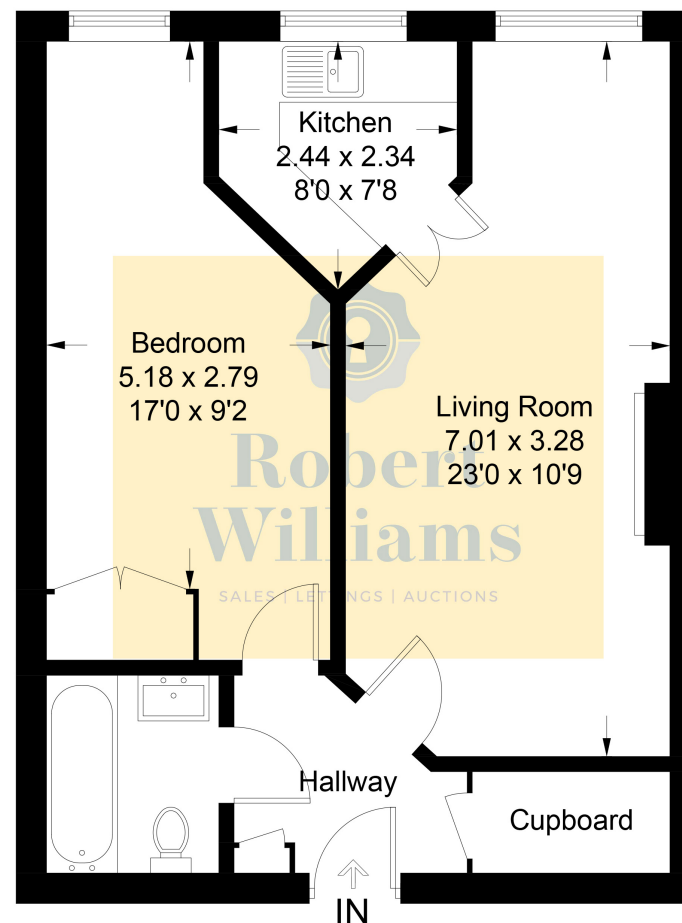

Illustration for identification purposes only, measurements are approximate, not to scale. Fourlabs.co © (ID1197805)



Robert Williams

SALES | LETTINGS | AUCTIONS

Robert Williams Estate Agents, 2 Southernhay West, Exeter, EX1 1JG

Tel: 01392 204800 • sales@robertwilliams.co.uk • robertwilliams.co.uk

IMPORTANT: we would like to inform prospective purchasers that these sales particulars have been prepared as a general guide only. A detailed survey has not been carried out, nor the services, appliances and fittings tested. Room sizes should not be relied upon for furnishing purposes and are approximate. If floor plans are included, they are for guidance only and illustration purposes only and may not be to scale. If there are any important matters likely to affect your decision to buy, please contact us before viewing the property.