



TOWER WALK

ALPHINGTON, EXETER, EX2 8FW



Robert Williams

SALES | LETTINGS | AUCTIONS

“Immaculate three bedroom semi detached family home with parking located in a quiet residential area of Alphington”.



Tower Walk

ALPHINGTON, EXETER, EX2 8FW

A well presented semi-detached house in a quiet cul-de-sac in Alphington. The property briefly comprises spacious lounge diner, fitted kitchen with back door to a good sized garden. Upstairs is a main bedroom, second bedroom and third bedroom/office, bathroom. Two parking spaces are available one directly in front and the other in a parking area behind. The property is being sold with no onward chain.

THE PROPERTY





The ground floor accommodation features an 'L' shaped living room that flows through the modern fitted kitchen with door leading out to the rear garden.

To the first floor is three bedrooms and a family bathroom.

Outside the property has side access to the rear garden which is largely laid to lawn with a couple of landscaped areas laid to shingle and a timber storage shed.

THE LOCATION

The location in Alphington is very convenient, a short walk from the local shop/post office. The nearby churches, pub and doctor's surgery are all within easy reach and there is a bus stop virtually outside the door with regular services to and from the city centre. A large Sainsbury superstore and the Marsh Barton trading estate are also close by and there is easy access to the A38, A30 and M5.

3		bedrooms	1		bathrooms
1		receptions	2		car spaces

Local Authority: Exeter Council

Council Tax Band: C

Tenure: Freehold

Heating: Gas Central Heating

Services: Mains water and drainage

Energy Efficiency Rating: D



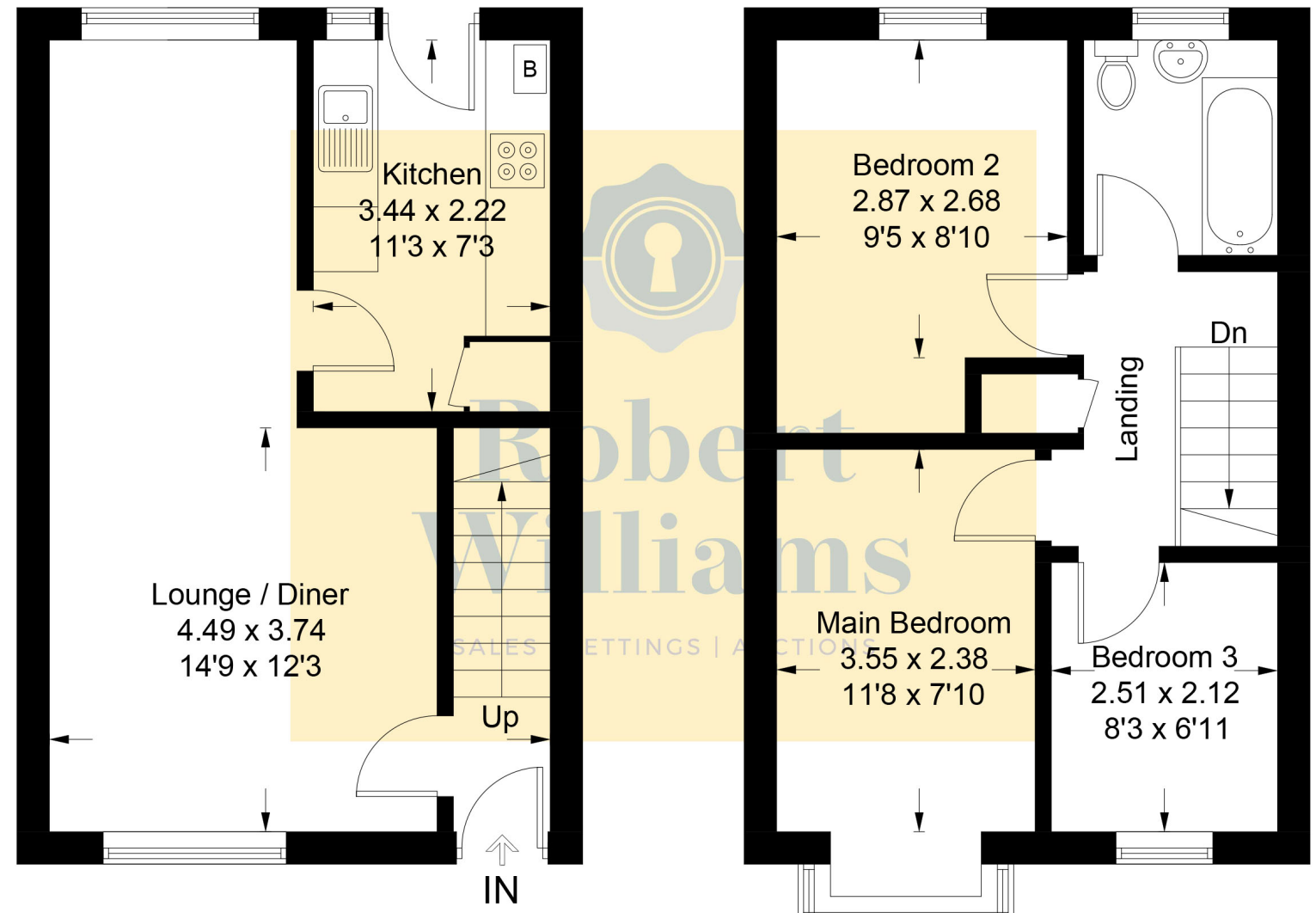

Robert Williams

SALES | LETTINGS | AUCTIONS

Robert Williams Estate Agents, 2 Southernhay West, Exeter, EX1 1JG

Tel: 01392 204800 • sales@robertwilliams.co.uk • robertwilliams.co.uk

IMPORTANT: we would like to inform prospective purchasers that these sales particulars have been prepared as a general guide only. A detailed survey has not been carried out, nor the services, appliances and fittings tested. Room sizes should not be relied upon for furnishing purposes and are approximate. If floor plans are included, they are for guidance only and illustration purposes only and may not be to scale. If there are any important matters likely to affect your decision to buy, please contact us before viewing the property.