



The Lodge Linthwaite, Huddersfield, HD7 5TG

£475,000

🛏 5 🚿 2 🛋 4



- 5 Bedroom Character Home with Adjoining Annex / 1 Bedroom Cottage
- Private South Facing Gardens • Double Garage
- Spacious Accommodation
- Stunning Views
- Sought After Village
- 4 Reception Rooms to the Main House
- Annex / Ancillary Accommodation / Investment Potential
- Local Services / Open Countryside / Commutable Location



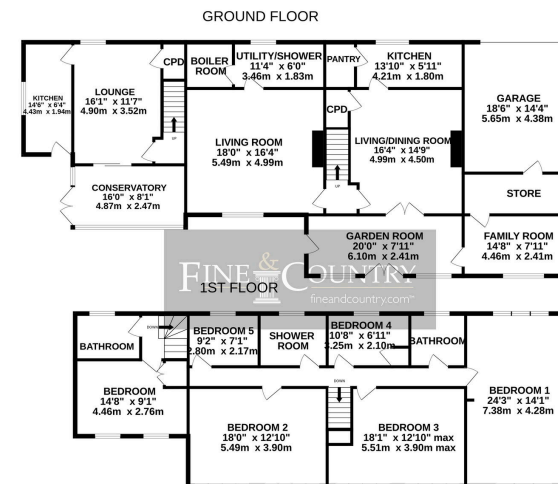

Whilst every attempt has been made to ensure the accuracy of the floorplan contained here, measurements of doors, windows, rooms and any other items are approximate and no responsibility is taken for any error, omission or mis-statement. This plan is for illustrative purposes only and should be used as such by any prospective purchaser. The services, systems and appliances shown have not been tested and no guarantee as to their operability or efficiency can be given.
Made with Metropix ©2025

Occupying a delightful plot, enjoying private south facing gardens and stunning views to the front aspect, a spacious 5 bedroom character home with annexed 1 bedroom cottage and a sought after village location.

Score	Energy rating	Current	Potential
92+	A		
81-91	B		
69-80	C		80 C
55-68	D	63 D	
39-54	E		
21-38	F		
1-20	G		

House 42, Locke, 44 Shambles St,
Barnsley S70 2SH
Tel: +44 (0)01226 729009
barnsley@fineandcountry.com

Unit 2 Former Council Offices, Eastgate
Honley, Holmfirth HD9 6PA
Tel: +44 (0)1484 550620
huddersfield@fineandcountry.com

The Balance Floor 7, 2 Pinfold Street
Sheffield, South Yorkshire S1 2GU
Tel: +44 (0)114 404 0044
sheffield@fineandcountry.com