

Priory Villas Richmond DL10 4LH Offers in the region of £290,000



CARVER
RESIDENTIAL
Sales · Lettings · Property Management

New price Commanding one of the most spectacular views in Richmond, this extended, three bedroomed semi-detached home overlooks the grass fields and tree lined banks of the river Swale with magnificent views of Richmond Castle and the Historic Market Town to the front.

The accommodation has been in the same family for decades and has been a much-loved family home which is now ready for a new owner to make their own.

The property offers an adaptable floorplan with an extended rear lounge situated next to the updated kitchen with High gloss wall and base units complimented by oak effect worksurfaces and fitted with a built in single oven, ceramic hob and extractor hood, the inner hallway leads to a further "formal" sitting room where a walk in bow window really makes the most of the views whilst a open fireplace creates a warm and cozy feature.

To the first floor are two fantastic double bedrooms each with a walk in bow window, an updated four piece bathroom with walk in shower enclosure, bath, w/c and vanity unit with sink, bedroom three is a compact single room or handy office space.

Externally there are gardens to the front and rear along with a detached garage. The property also overlooks open countryside to the rear and is situated just a stone's throw from The Station, Open 7 days a week, and home to a 3 screen Cinema, Café | Bar, art galleries and an array of independent businesses, and just

½ a mile away is the historic cobbled marketplace of Richmond.

Properties in this street are RARELY AVAILABLE so book your viewing early.







- No Onward Chain
- Rarely Available
- Stunning Views
- Not Overlooked Front or Rear
- Amazing Location
- Pedestrian Access to the Front & Access & Garage to the Rear





CARVER
RESIDENTIAL
Sales · Lettings · Property Management



Ground Floor

Approx. 56.5 sq. metres (608.0 sq. feet)

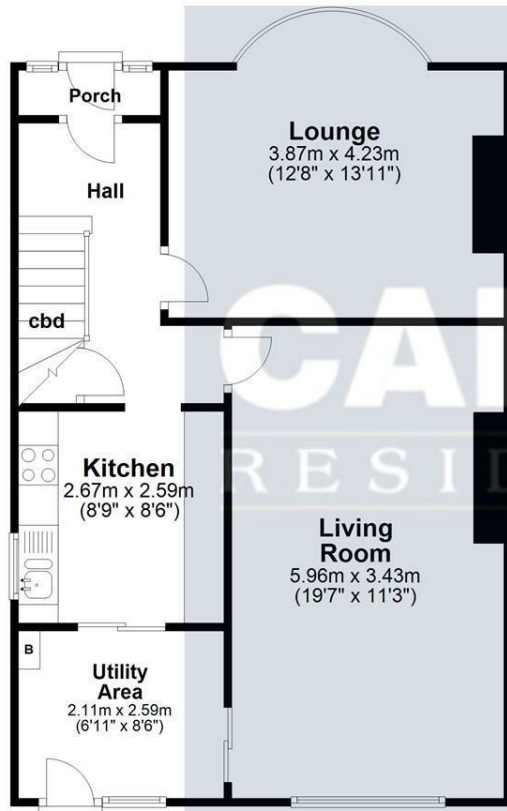

First Floor

Approx. 43.3 sq. metres (466.1 sq. feet)

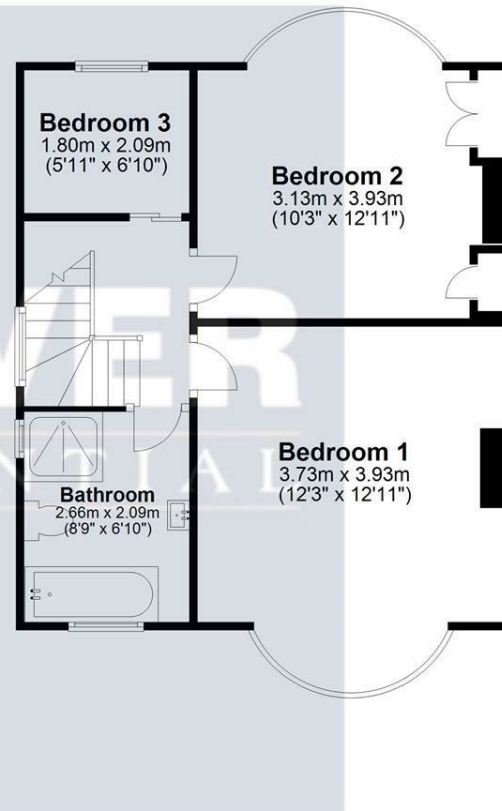

Total area: approx. 99.8 sq. metres (1074.1 sq. feet)

Sketch Plan: Not To Scale. For Illustrative Purposes Only. Created by HJ Cadplan Ltd.
Plan produced using PlanUp.

Energy Efficiency Rating		Current	Potential
Very energy efficient - lower running costs			
(92 plus) A			
(81-91) B			81
(69-80) C		68	
(55-68) D			
(39-54) E			
(21-38) F			
(1-20) G			
Not energy efficient - higher running costs			
England & Wales		EU Directive 2002/91/EC	

We can search 1,000s of mortgages for you

It could take just 15 minutes with one of our specialist advisers:
Call: 01325 380088. Visit: Any of our Offices. Online: www.mortgageadvicebureau.com/carver



Your home may be repossessed if you do not keep up repayments on your mortgage. There will be a fee for mortgage advice. The actual amount you pay will depend upon your circumstances. The fee is up to 1% but a typical fee is 0.3% of the amount borrowed

MAB 6202



These particulars do not constitute any part of an offer or contract. None of the statements contained in these particulars are to be relied on as statements or representations of fact and any intending purchaser must satisfy himself by inspection or otherwise to the correctness of each of the statements contained in these particulars. The vendor does not make or give, and neither Nick & Gordon Carver Residential or Commercial, Nick & Gordon Carver, nor any person in their employment has any authority to make or give any representation or warranty whatever in relation to this property

80 High Street
Yarm, TS15 9AH
Tel: 01642 420090
yarm@carvergroup.co.uk

14 Duke Street, Darlington
County Durham, DL3 7AA
Tel: 01325 357807
sales@carvergroup.co.uk

26 Market Place, Richmond
North Yorkshire, DL10 4QG
Tel: 01748 825317
richmond@carvergroup.co.uk

43 Dalton Way, Newton Aycliffe
County Durham, DL5 4DJ
Tel: 01325 320676
aycliffe@carvergroup.co.uk

219 High Street, Northallerton
North Yorkshire, DL7 8LW
Tel: 01609 777710
northallerton@carvergroup.co.uk