



CARVER
RESIDENTIAL
Sales · Lettings · Property Management

Neville Close
Evenwood, DL14 9SQ

Offers over £375,000

House - Detached
5 Bedroom/s
4 Bathroom/s

This 5 BEDROOM three-storey property offers well-proportioned and flexible living accommodation ideal for both a family and multi-generational buyer. Upon entering, you are greeted by a large living room, complete with a solid fuel stove, creating a warm and inviting atmosphere. The property boasts three reception rooms, including a delightful conservatory that invites natural light and provides a serene space to relax. The sitting room seamlessly opens to the dining room, making it perfect for entertaining guests or enjoying family meals. The well-appointed kitchen/breakfast room, accompanied by a utility room and a convenient WC, ensures that daily living is both practical and enjoyable. The first floor features a spacious principal bedroom, equipped with built-in wardrobes and an en-suite bathroom/shower/WC, providing a private retreat. Two additional bedrooms, each with en-suite facilities, offer comfort and privacy for family members or guests. The second floor hosts two further bedrooms with a good degree of eaves storage, complemented by a further bathroom/WC, making this home exceptionally accommodating.

Outside, the property benefits from a driveway with gardens to both the side and rear of the property and picturesque views over fields to the rear, enhancing the sense of peace and tranquillity that this location provides. This remarkable home is not just a property; it is a lifestyle choice, perfect for those who appreciate space, comfort, and the beauty of the surrounding countryside. With its thoughtful design and ample amenities, this residence is sure to impress.





Agents Notes

Tenure:- Freehold

Mains gas, (central heating to radiators), electricity & drainage

uPVC double glazing throughout

Council Tax:- Band E

Local Authority:- Durham County Council

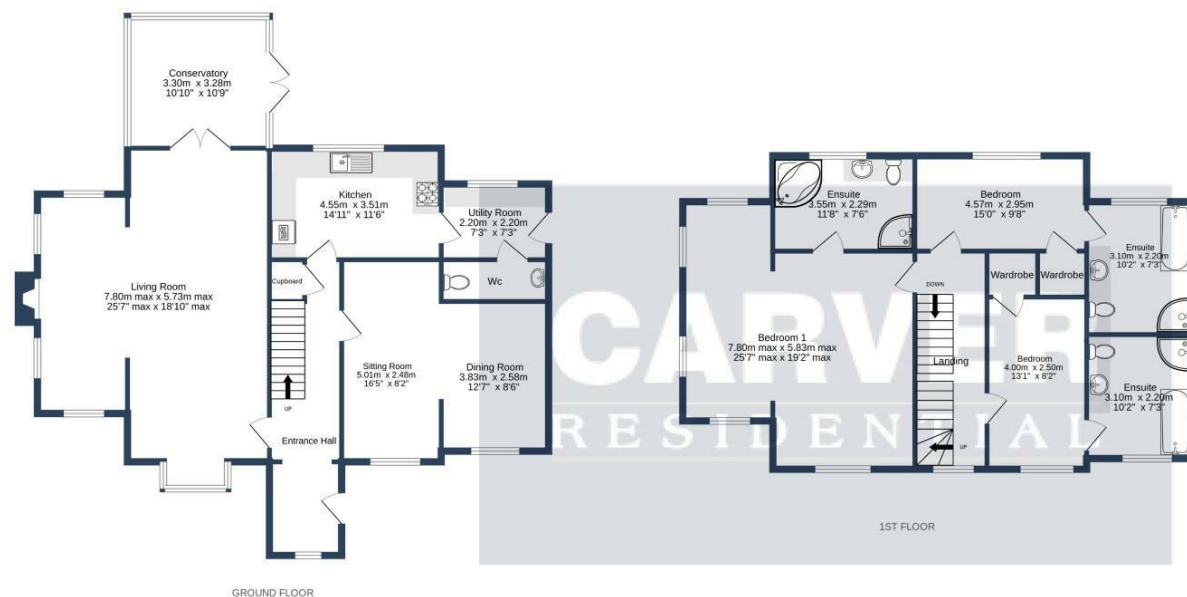

NEVILLE CLOSE, EVENWOOD. DL14 9SQ.

Whilst every attempt has been made to ensure the accuracy of the floorplan contained here, measurements of doors, windows, rooms and any other items are approximate and no responsibility is taken for any error, omission or mis-statement. This plan is for illustrative purposes only and should be used as such by any prospective purchaser. The services, systems and appliances shown have not been tested and no guarantee as to their operability or efficiency can be given.
Made with Metropix ©2025

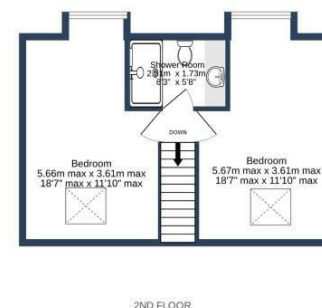

Energy Efficiency Rating		
	Current	Potential
Very energy efficient - lower running costs		
(92 plus) A		
(81-91) B		
(69-80) C		
(55-68) D		
(39-54) E		
(21-38) F		
(1-20) G		
Not energy efficient - higher running costs		
England & Wales		
EU Directive 2002/91/EC		

We can search 1,000s of mortgages for you

It could take just 15 minutes with one of our specialist advisers:
Call: 01325 380088. Visit: Any of our Offices. Online: www.mortgageadvicebureau.com/carver



Your home may be repossessed if you do not keep up repayments on your mortgage. There will be a fee for mortgage advice. The actual amount you pay will depend upon your circumstances. The fee is up to 1% but a typical fee is 0.3% of the amount borrowed

MAB 6202



These particulars do not constitute any part of an offer or contract. None of the statements contained in these particulars are to be relied on as statements or representations of fact and any intending purchaser must satisfy himself by inspection or otherwise to the correctness of each of the statements contained in these particulars. The vendor does not make or give, and neither Nick & Gordon Carver Residential or Commercial, Nick & Gordon Carver, nor any person in their employment has any authority to make or give any representation or warranty whatever in relation to this property



14 Duke Street, Darlington
Co Durham, DL3 7AA
01325 357807
sales@carvergroup.co.uk

63 Dalton Way, Newton Aycliffe
Co Durham DL5 4NB
01325 320676
aycliffe@carvergroup.co.uk

41 Market Place, Richmond
North Yorkshire, DL10 4QL
01748 825317
richmond@carvergroup.co.uk

219 High Street, Northallerton
North Yorkshire DL7 8LW
01609 777710
northallerton@carvergroup.co.uk

www.carvergroup.co.uk