

# EGERTON ESTATES



## **Bodelan , Tyn Y Gongl, LL74 8SD**

**Offers Around £440,000**

A spacious detached dormer style house having recently undergone considerable modernisation, with the special feature of having a modern and independent one bedroom Annex. Situated on the edge of the ever popular seaside village of Benllech, the property enjoys a private situation with ample off road parking and garage, giving a total of 3/4 bedrooms, 2 bathrooms and 2/3 reception rooms.

Since 2021, the present owners have undertaken extensive modernisation to include rewiring, two replacement kitchens and one bathroom, majority of doors and windows and recovering areas of flat roof.

The annex is ideally suited for a relative or alternatively can be used as a holiday let in this popular tourist location being about a mile to Benllech's renowned sandy beach and coastline.

Well worthy of internal inspection

### **Entrance Porch**

Being communal to both the main house and Annex, and having a double glazed entrance door and with two inner doors to either part of the accommodation

### **Main House**

#### **Hallway**

With a staircase to the first floor, radiator.

#### **Living Room 17'10" x 10'11" (5.46 x 3.35)**

A naturally light room having a wide front aspect enjoying a sunny southerly aspect over the front garden area. Inglenook recess housing a multifuel stove on a slate hearth. Coved ceiling, 2 radiators, tv connection.

#### **Kitchen/Breakfast Room 17'0" x 11'11" (5.19 x 3.64)**

Having an extensive range of recently fitted units in a Parisienne blue finish with contrasting worktop surfaces and tiled surround. 1.5 bowl sink unit with monobloc tap under a rear aspect window. Recess for an electric cooker with fitted extractor over. Ample room for a dining table, radiator.

#### **Side Porch/Utility 7'6" x 5'6" (2.30 x 1.70)**

With a double glazed outside door and inner door to the garage. Door through to an Utility area with sink unit and space under for a washing machine together with a WC.

#### **Dining Room/Bedroom 3 11'10" x 11'10" (3.62 x 3.62)**

Having recently fitted double opening "french style" double glazed doors to a private rear garden area. Fitted cupboard with shelving, radiator.

#### **Bathroom 8'9" x 6'10" (2.69 x 2.10)**

Having a modern white suite but with some aspects in need of upgrading, and to include a panelled bath, shower cubicle with electric shower control, wash basin and WC. Radiator.

#### **First Floor Landing**

A spacious area with radiator, and eaves access for storage running the the full length.

#### **Bedroom 1 12'0" x 11'9" (3.68 x 3.59)**

Having a gable window enjoying a fine rural outlook and with radiator under.

#### **Bedroom 2 17'2" x 11'3" (5.25 x 3.43)**

Having a central divide between the bedroom area and dressing room area, with cupboard, 2 radiators.

### **Annex**

Being self contained to the main house, and having undergone extensive modernisation within the last 3 years.

### **Hallway**

With a laminated timber floor covering which extends through much of the annex, radiator

#### **Living/Dining Room 18'9" x 11'10" extending to 15'1" (5.73 x 3.61 extending to 4.60)**

Again a naturally light room with two patio doors and enjoying a sunny southerly aspect over the front garden. Timber laminated floor covering, radiator.

#### **Kitchen 9'7" x 9'5" (2.94 x 2.89)**

With a recently fitted range of base and wall units in a contemporary grey laminated finish with contrasting worktop surfaces and tiled surround. Integrated ceramic hob with extractor over and oven under, small breakfast bar area with nearby radiator. 1.5 bowl sink unit with monobloc tap under a side aspect window.

#### **Shower Room 8'5" x 5'6" (2.57 x 1.68)**

A contemporary suite in white comprising of a panelled bath with fixed head thermostatic shower over. Raised wash basin on a timber vanity cupboard, WC. Towel radiator, linen cupboard with shelving.

#### **Utility Room 5'2" x 5'2" (1.60 x 1.58)**

Having modern storage cupboards, and a stainless steel sink unit. Recess for a washing machine, laminate flooring.

#### **Bedroom 12'11" x 11'9" (3.94 x 3.60)**

With built in wardrobes and central bed recess, radiator.

### **Outside**

A part shared entrance leads to a private drive with off road parking to the rear and this drive extends around to the front where there is additional parking and access to the GARAGE.

To the rear is a private partitioned patio area with access off the main house dining room, being a private area to sit outside.

The front of the house is a particularly sunny area having a southerly aspect with a large tarmacadam area and access to the garage and a small patio area for the Annex. There is a timber fence with gate that leads to a private garden area for the Annex with a wide recently paved patio area and lawned garden area. This area enjoys good privacy adjoining farmland.

#### **Garage 16'6" x 9'6" (5.05 x 2.91)**

With up and over door and interior door to the main house, with power and light.

There is a former second GARAGE 5.45 X 3.26 to the rear now used as a Store/Workshop with power and light and Worcester oil fired central heating boiler.

### **Services**

Mains water, drainage and electricity.

Oil fired central heating (one boiler for main house and annex).

Double glazed windows and doors (most post 2021)

### **Tenure**

The property is understood to be freehold and this will be confirmed by the vendor's conveyancer.

### **Council Tax**

Band E

### **Energy Efficiency**

Band D

# Floor Plan

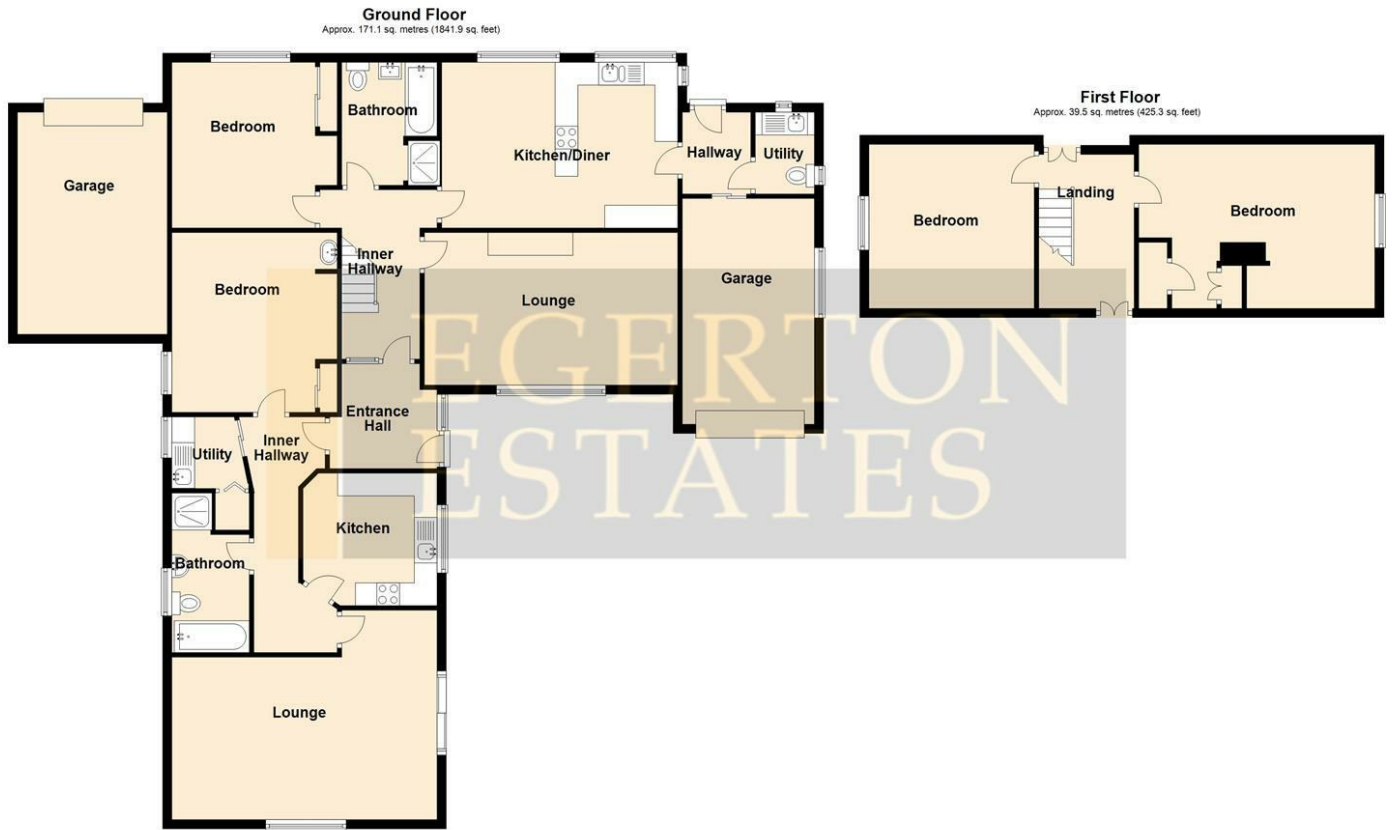

Total area: approx. 210.6 sq. metres (2267.2 sq. feet)  
This floor plan is for illustrative purposes only and may not be representative of the property. The measurements are approximate and are for illustrative purposes only. Plan produced using PlanUp.

**Bodelan, Tyn Y Gongl**

# Area Map

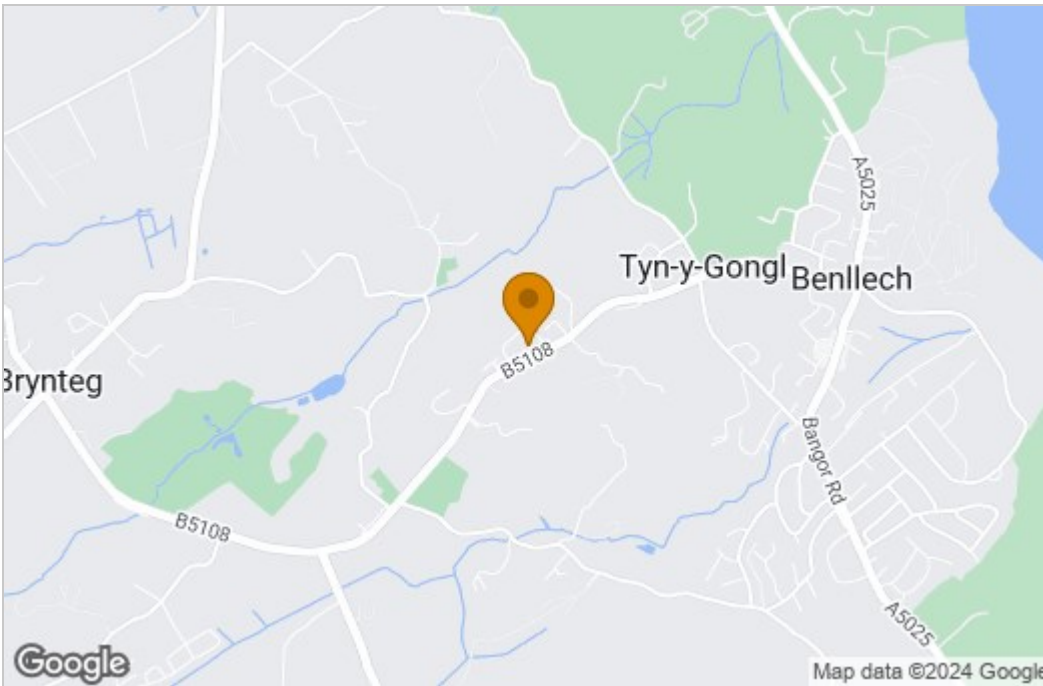

# Energy Efficiency Graph

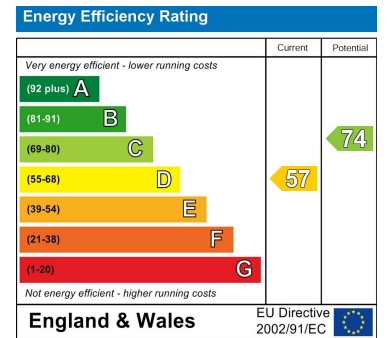

These particulars, whilst believed to be accurate are set out as a general outline only for guidance and do not constitute any part of an offer or contract. Intending purchasers should not rely on them as statements of representation of fact, but must satisfy themselves by inspection or otherwise as to their accuracy. No person in this firm's employment has the authority to make or give any representation or warranty in respect of the property.

The Property Centre, Padworth House, Benllech, Anglesey, LL74 8TF  
Tel: 01248 852177 Email: enquiries@egerton-estates.co.uk <https://www.egerton-estates.co.uk>