



North Lodge Drive, Papworth Everard Cambridge  
**£350,000 Freehold**

**Sharman  
Quinney**



# Key Features



- 17" Kitchen/Diner
- Additional Multifunctional Room Downstairs
- Off Road Parking
- 16" Lounge
- Built-In Wardrobes in ALL 3 Bedrooms

Papworth Everard is a large village with a thriving community offering a pharmacy and doctors' surgery, a convenience store with Post Office, a veterinary surgery, a coffee shop, a unisex hair salon and a library. Papworth lies just 10 miles west of Cambridge and 6 miles south of Huntingdon. Transport in the village includes frequent busses to Cambridge, Huntingdon, St Neots and St. Ives.

Ground Floor

Entrance Hall  
Leads to;

Cloakroom  
Fitted with two-piece suite comprising of, wash hand basin and WC, window to front.



### Kitchen/Diner

2.89m x 5.34m (9' 6" x 17' 6")

Fitted with a matching range of base and eye level units, French Doors leading to the garden.

### Study/Bedroom 4

2.94m x 2.68m (9' 8" x 8' 10")

Multifunctional room with Bay window to front.

### Utility Room

2.10m x 1.83m (6' 11" x 6' 0")

Space for a washing machine and tumble dryer, door to garden, radiator.

### First Floor

#### Bedroom One

3.79m x 2.28m (12' 5" x 7' 6")

Window to rear, built-in wardrobes.

#### En-suite

Fitted with a three-piece suite comprising of shower cubicle, wash hand basin and WC, window to rear.

#### Lounge

5.08m x 4.52m (16' 8" x 14' 10")

L shaped room with 2 windows to front.

### Second Floor

#### Bedroom Two

4.97m x 3.38m (16' 4" x 11' 1") 4.97m x 3.38m



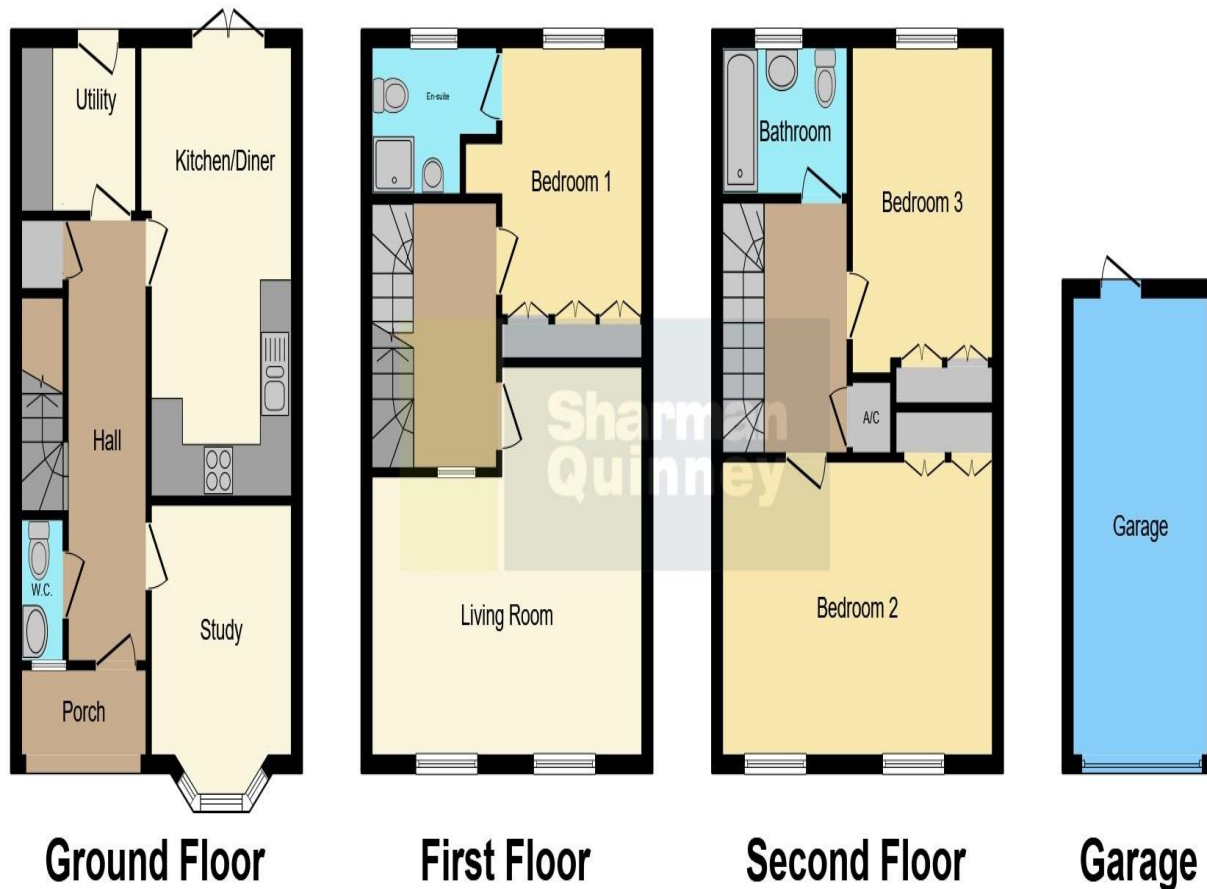

(16' 4" x 11' 1")

Built in wardrobes, with 2 windows to front.

Bedroom Three

3.54m x 2.58m (11' 7" x 8' 6")

Built-in wardrobes with window to rear.

Family Bathroom

Fitted with three-piece suite comprising bath with overhead shower, wash hand basin and WC, window to rear.

Garden

Enclosed rear garden with gated access to rear.

Door to single garage and parking to the rear.

This floor plan is for illustrative purposes only. It is not drawn to scale. Any measurements, floor areas (including any total floor area), openings and orientation are approximate. No details are guaranteed, they cannot be relied upon for any purpose and they do not form part of any agreement. No liability is taken for any error, omission or misstatement. A party must rely upon its own inspection(s). Powered by [www.focalagent.com](http://www.focalagent.com)

To view this property call Sharman Quinney on:  
**01954 710620**



# Selling your property?

Contact us to arrange a **FREE** home valuation.

 01954 710620

 13 High Street, Cambourne, CAMBRIDGE,  
Cambridgeshire, CB23 6JX

 [cambourne@sharmanquinney.co.uk](mailto:cambourne@sharmanquinney.co.uk)

 [www.sharmanquinney.co.uk](http://www.sharmanquinney.co.uk)



 SCAN ME



Sharman Quinney Holdings Limited is registered in England and Wales under company number 4174227, Registered Office is Cumbria House, 16-20 Hockliffe Street, Leighton Buzzard, Bedfordshire, LU7 1GN. VAT Registration Number is 500 2481 05.

1: These particulars do not constitute part or all of an offer or contract. 2: The measurements indicated are supplied for guidance only and as such must be considered incorrect. 3: Potential buyers are advised to recheck the measurements before committing to any expense. 4: Sharman Quinney has not tested any apparatus, equipment, fixtures, fittings or services and it is the buyers interests to check the working condition of any appliances. 5: Sharman Quinney has not sought to verify the legal title of the property and buyers must obtain verification from their legal representative. 6: Intending purchasers will be asked to produce identification documentation at a later stage and we would ask your co-operation in order that there will be no delay in agreeing the sale. Ref: CSQ203857 - 0001

