

WE VALUE



YOUR HOME



Henfield View, Warborough
Price Guide £775,000



Situated in a pleasant cul-de-sac in Warborough, this well-presented four-bedroom family home is offered to the market with no onward chain. A gated, landscaped driveway provides ample off-street parking and a welcoming approach to the property. Inside, the ground floor features a kitchen/diner with underfloor heating, a comfortable lounge, and a spacious reception/sunroom. A separate utility room and a shower room complete this level. Upstairs, four bedrooms include a principal bedroom with a Juliet balcony overlooking the garden, complemented by an en-suite. A family bathroom serves the remaining bedrooms. All bathrooms benefit from underfloor heating. The generously sized garden offers a versatile, insulated garden studio at the far end, complete with power, lighting, a log burner, wired internet, and water—ideal for a home office or creative space.





- BEAUTIFULLY PRESENTED THROUGHOUT
- NO ONWARD CHAIN
- FOUR BEDROOM FAMILY HOME
- GARDEN/RECEPTION ROOM WITH LOG BURNER
- GENEROUSLY SIZED REAR GARDEN
- EXPANSIVE FRONT GARDEN/DRIVEWAY PROVIDING AMPLE OFF-STREET PARKING
- GARDEN STUDIO
- SEPARATE UTILITY & DOWNSTAIRS SHOWER ROOM
- UNDERFLOOR HEATING TO KITCHEN/DINER & ALL BATHROOMS
- DESIRABLE CUL-DE-SAC LOCATION

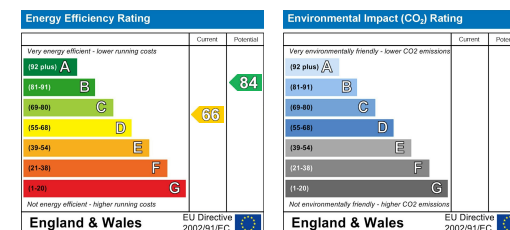

Energy Efficiency Graph

Floor Plan

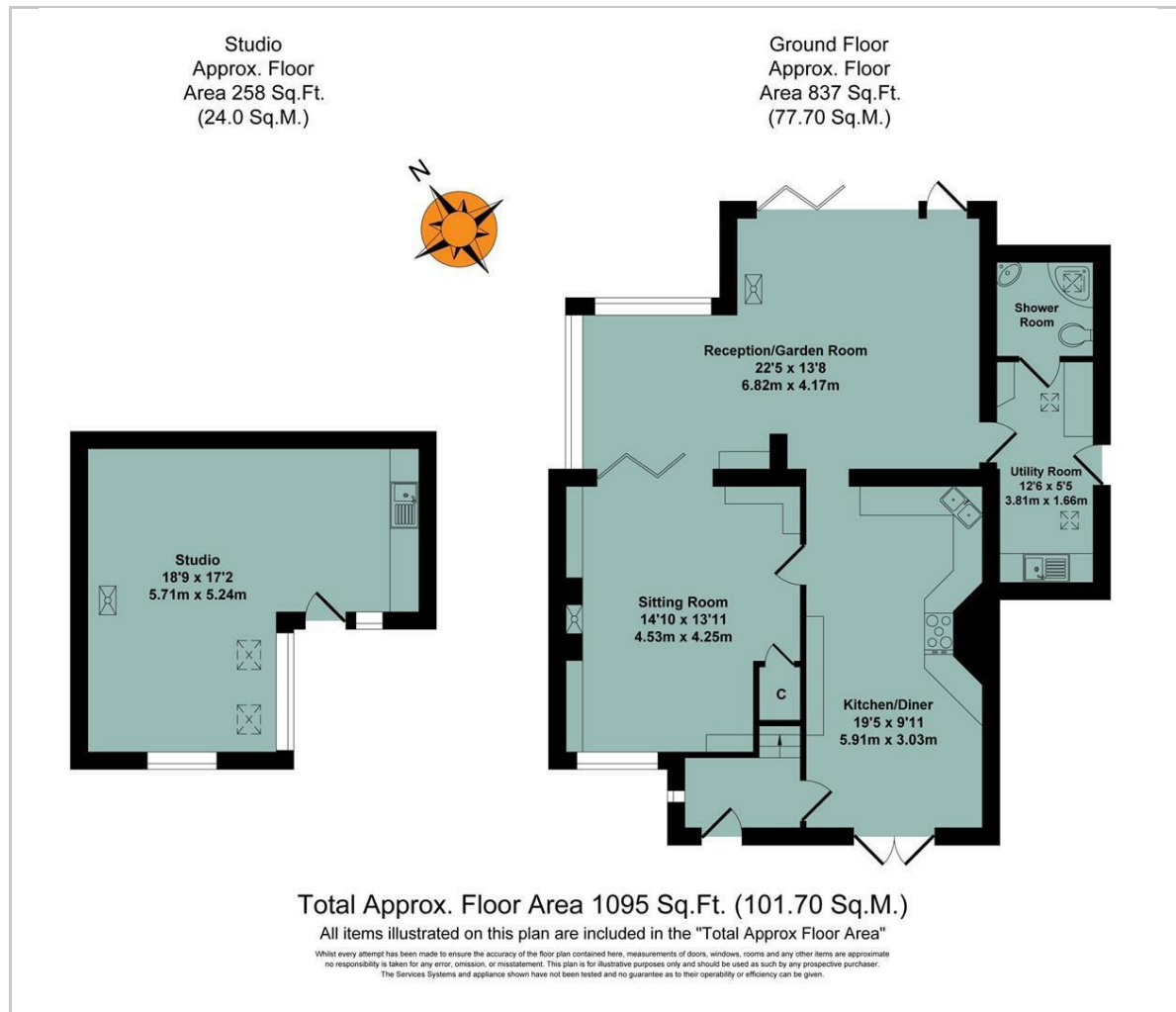

Area Map



Viewing

Please contact our In House Sales & Lettings Office on 01491 839999 opt.1
if you wish to arrange a viewing appointment for this property or require further information.

These particulars, whilst believed to be accurate are set out as a general outline only for guidance and do not constitute any part of an offer or contract. Intending purchasers should not rely on them as statements of representation of fact, but must satisfy themselves by inspection or otherwise as to their accuracy. No person in this firm's employment has the authority to make or give any representation or warranty in respect of the property.

28 St Martins Street, Wallingford, Oxfordshire, OX10 0AL
Tel: 01491 839999 opt.1 Email: sales@inhouseestateagents.co.uk www.inhouseestateagents.co.uk