

WE VALUE



YOUR HOME



Westfield Close, Benson
£425,000



Located within a pleasant cul-de-sac in the village of Benson, this three-bedroom home features a generous kitchen/diner, a separate lounge, a conservatory, and both a family bathroom and a downstairs shower room. The west-facing rear garden provides outdoor space to enjoy, with a garage and off-street parking adding convenience. Just a short distance from the village amenities, this property is offered with no onward chain, making it an ideal choice for families looking to settle in this vibrant community.



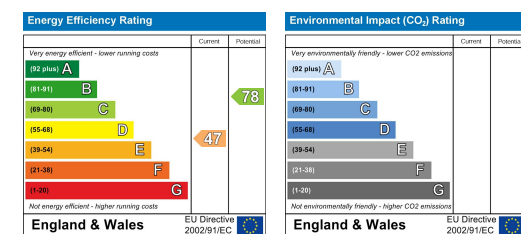

Energy Efficiency Graph

Floor Plan

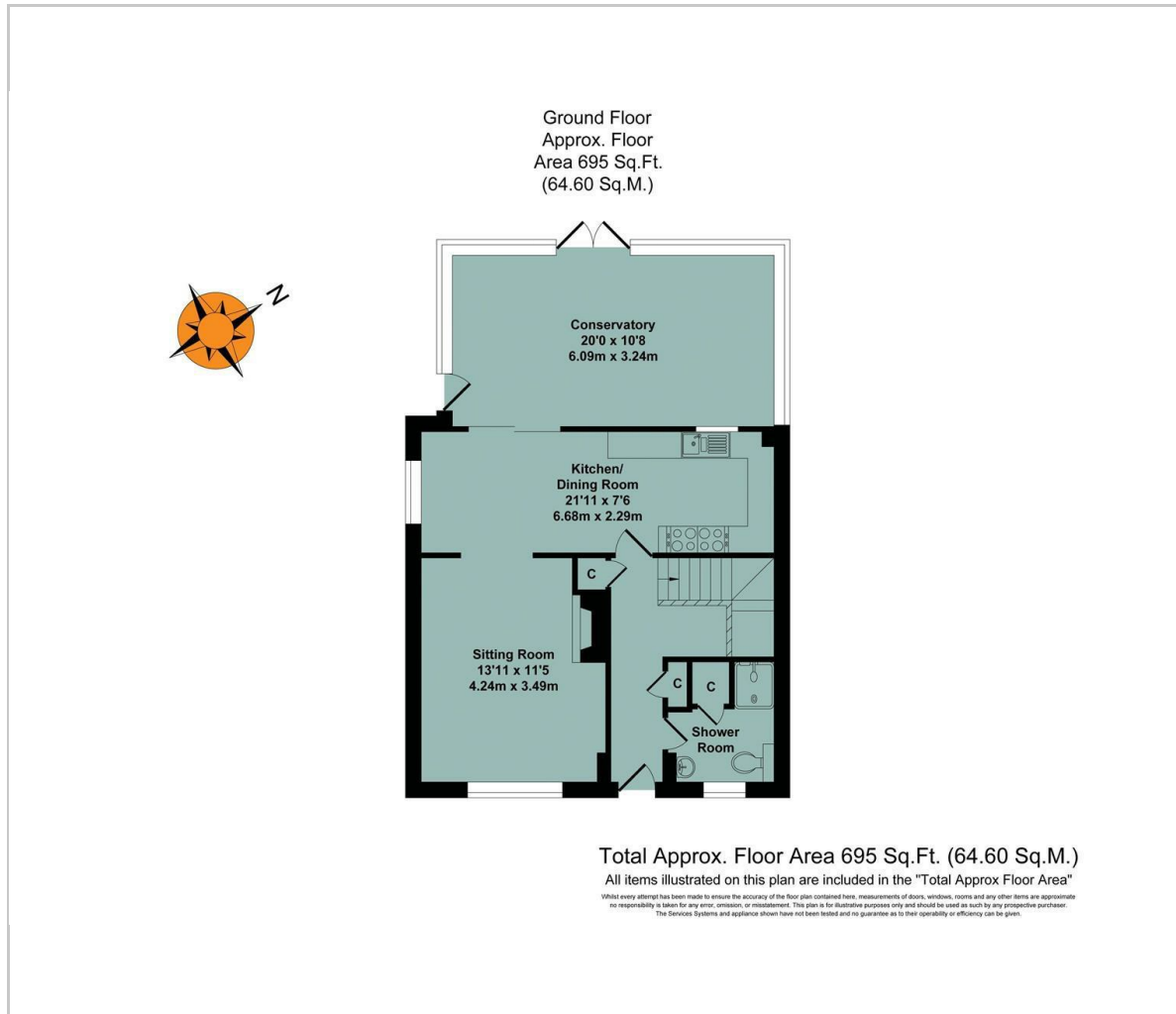

Area Map

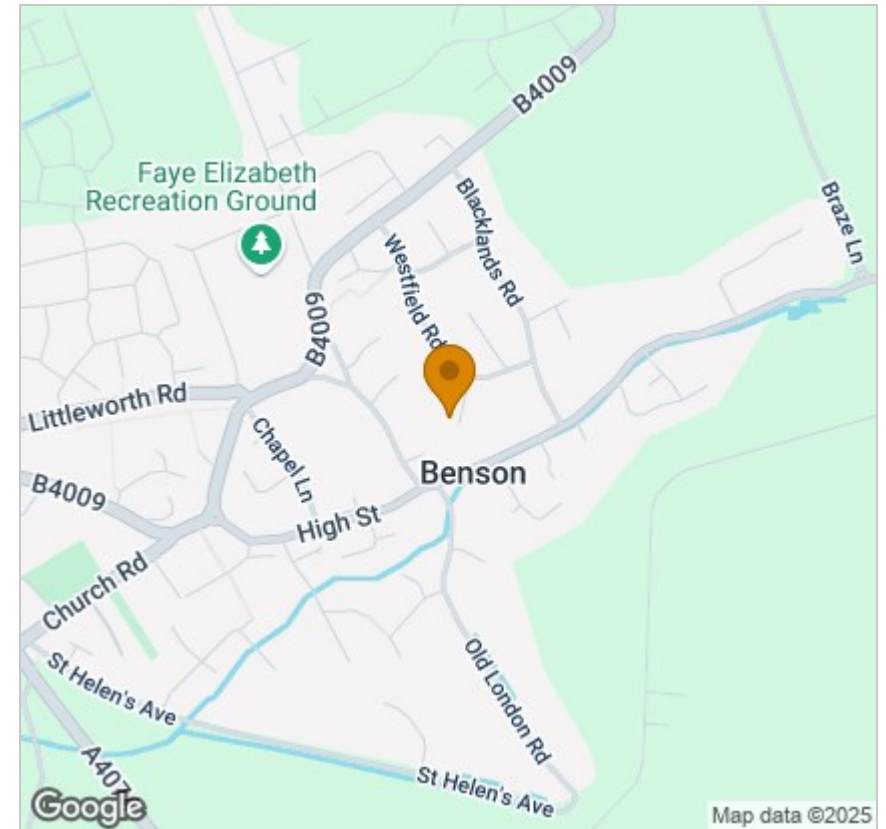

Viewing

Please contact our In House Sales & Lettings Office on 01491 839999 opt.1
if you wish to arrange a viewing appointment for this property or require further information.

These particulars, whilst believed to be accurate are set out as a general outline only for guidance and do not constitute any part of an offer or contract. Intending purchasers should not rely on them as statements of representation of fact, but must satisfy themselves by inspection or otherwise as to their accuracy. No person in this firm's employment has the authority to make or give any representation or warranty in respect of the property.

28 St Martins Street, Wallingford, Oxfordshire, OX10 0AL
Tel: 01491 839999 opt.1 Email: sales@inhouseestateagents.co.uk www.inhouseestateagents.co.uk