

WE VALUE



YOUR HOME



Laurel Close, Chalgrove  
Offers Over £300,000





Stylishly presented and well-designed with an open-plan interior, this two-bedroom property boasts a spacious living area, featuring a log burner in the lounge and a lovely flow through to the dining area and kitchen. With two double bedrooms, a southeast-facing rear garden, and a garage, the home offers comfort and convenience, all within easy reach of local amenities and major transport links.







- OPEN PLAN LIVING AREA
- STYLISHLY PRESENTED
- GARAGE
- TWO DOUBLE BEDROOMS
- SOUTH-EAST FACING REAR GARDEN
- TUCKED AWAY LOCATION WITH COUNTRYSIDE VIEWS

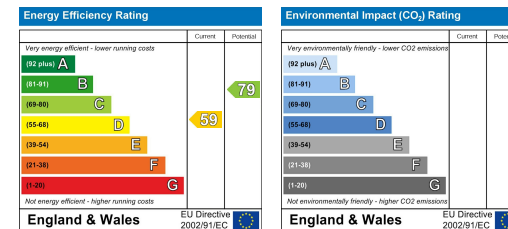

Energy Efficiency Graph

## Floor Plan

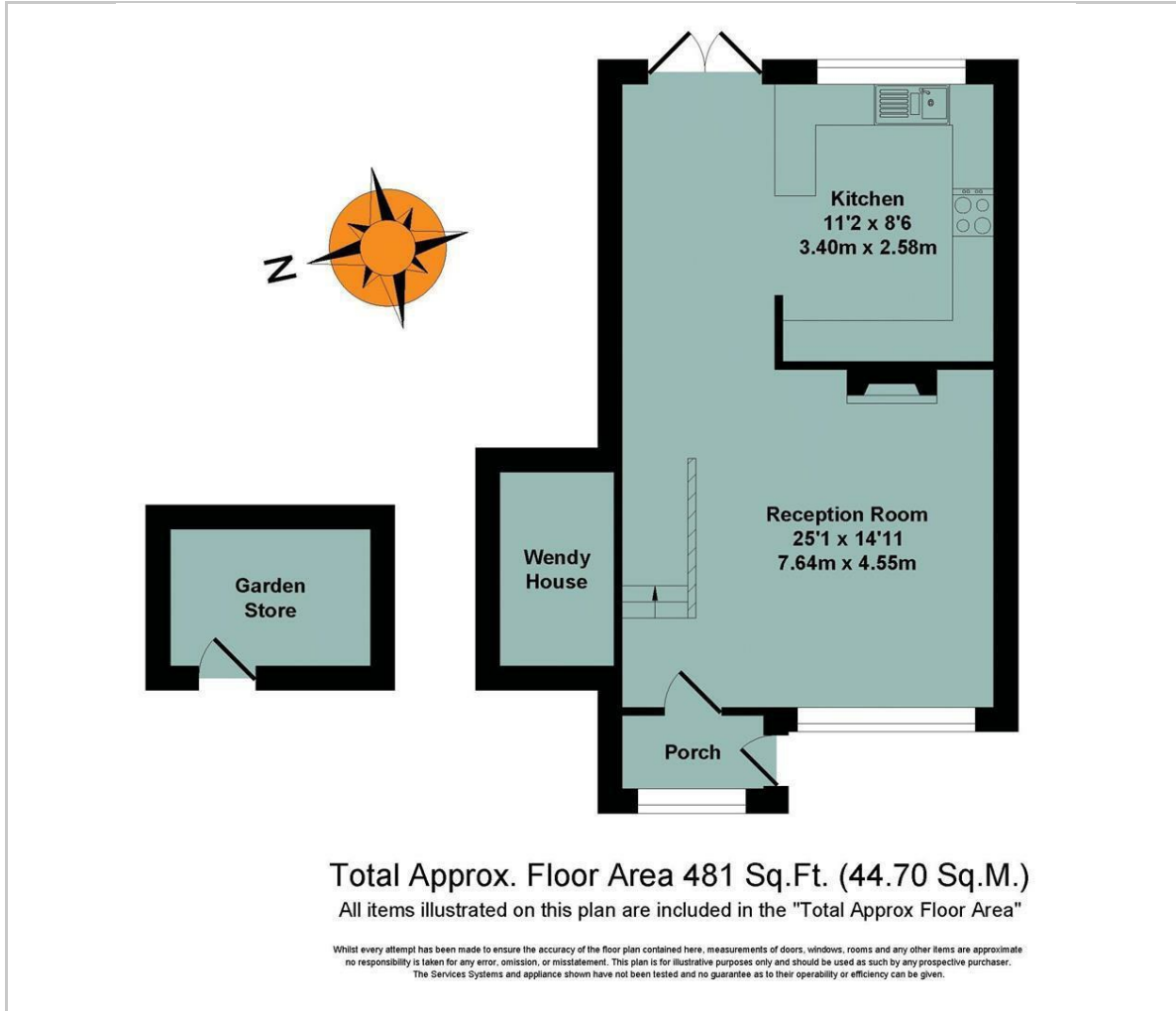

## Area Map



## Viewing

Please contact our In House Sales & Lettings Office on 01491 839999 opt.1 if you wish to arrange a viewing appointment for this property or require further information.

These particulars, whilst believed to be accurate are set out as a general outline only for guidance and do not constitute any part of an offer or contract. Intending purchasers should not rely on them as statements of representation of fact, but must satisfy themselves by inspection or otherwise as to their accuracy. No person in this firm's employment has the authority to make or give any representation or warranty in respect of the property.

28 St Martins Street, Wallingford, Oxfordshire, OX10 0AL  
Tel: 01491 839999 opt.1 Email: [sales@inhouseestateagents.co.uk](mailto:sales@inhouseestateagents.co.uk) [www.inhouseestateagents.co.uk](http://www.inhouseestateagents.co.uk)