

WE VALUE



YOUR HOME



The Moorlands, Benson  
£575,000



Situated on an enviable corner plot towards the end of a cul-de-sac, this well-presented and extended family home has a wealth of homely features and a stylish modern layout. The open-plan kitchen/dining room provides a fantastic heart to the home and opens up to the south-west facing garden via the tri-fold doors (the perfect setting for summer entertaining!) The cosy lounge is fitted with a wood burner and to the upstairs space, are four bedrooms with an en-suite to the main and family bathroom. The sunny, landscaped rear garden provides a relaxing outdoor space and with a garage and plenty of off-street on the private drive, all located just a short stroll from the many village amenities and countryside surroundings, this property really does tick all the boxes.





- CUL-DE-SAC LOCATION
- WELL-PRESENTED THROUGHOUT
- OPEN-PLAN KITCHEN/DINING AREA WITH TRI-FOLD DOORS
- SPACIOUS LOUNGE WITH LOG BURNER
- MAIN BEDROOM WITH WETROOM STYLE EN-SUITE
- OFF-STREET PARKING & GARAGE
- CLOAKROOM & UTILITY ROOM
- SOUTH-WEST FACING LANDSCAPED REAR GARDEN

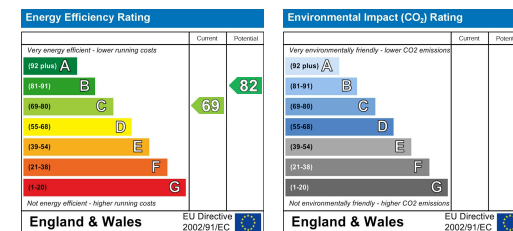

Energy Efficiency Graph

## Floor Plan

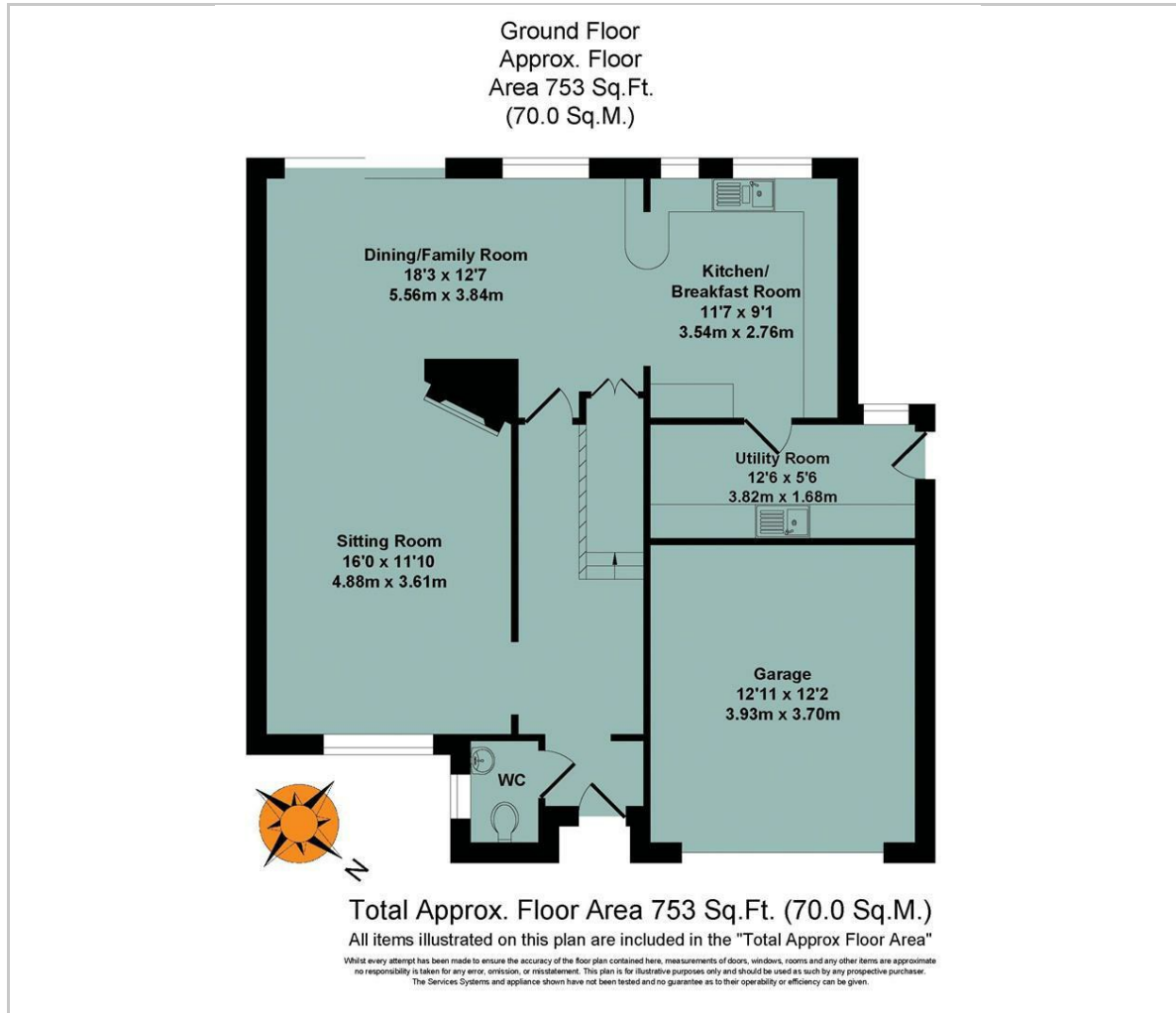

## Area Map

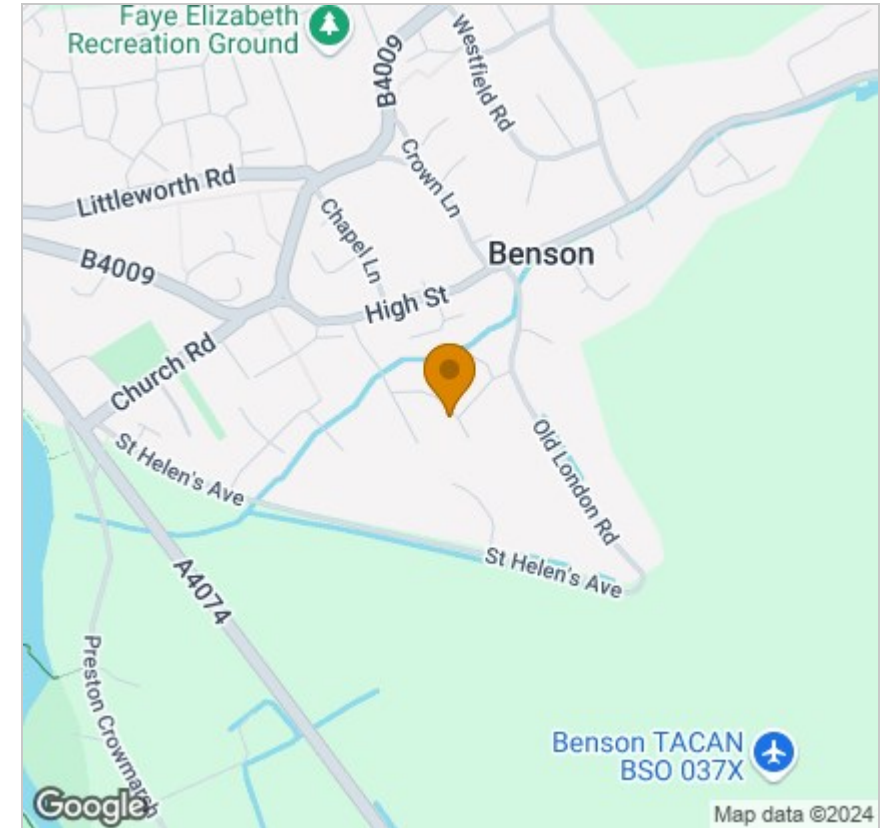

## Viewing

Please contact our In House Sales & Lettings Office on 01491 839999 opt.1  
if you wish to arrange a viewing appointment for this property or require further information.

These particulars, whilst believed to be accurate are set out as a general outline only for guidance and do not constitute any part of an offer or contract. Intending purchasers should not rely on them as statements of representation of fact, but must satisfy themselves by inspection or otherwise as to their accuracy. No person in this firm's employment has the authority to make or give any representation or warranty in respect of the property.

28 St Martins Street, Wallingford, Oxfordshire, OX10 0AL  
Tel: 01491 839999 opt.1 Email: [sales@inhouseestateagents.co.uk](mailto:sales@inhouseestateagents.co.uk) [www.inhouseestateagents.co.uk](http://www.inhouseestateagents.co.uk)