

WE VALUE



YOUR HOME



High Street, Dorchester-On-Thames  
£850,000





Set back from Dorchester's High Street on a lovely private and secluded plot, this detached family home is a real hidden gem! The expansive frontage provides ample off street parking and leads to the extended four-bedroom property with its highly versatile layout and plenty of homely features. With a stylish modern kitchen and family bathroom, plenty of reception space including a vaulted sun/breakfast room opening out to a private central courtyard, a generous study and lounge, a separate dining room and four good sized bedrooms, one with an en-suite, there's space to accommodate a growing families needs. With plenty of off-street parking and generous gardens to the front and rear, this fantastic property is perfect for those wanting to put down roots in this highly desirable village.







- FOUR BEDROOM DETACHED FAMILY HOME
- SPACIOUS & VERSATILE LAYOUT
- SUN ROOM WITH SECLUDED COURTYARD
- STUDY, UTILITY & CLOAKROOM
- AMPLE BUILT-IN STORAGE
- EN-SUITE & FAMILY BATHROOM
- FRONT & REAR GARDENS
- AMPLE OFF-STREET PARKING
- NO ONWARD CHAIN
- DORCHESTER-ON-THAMES

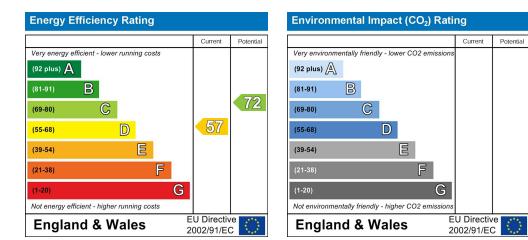

Energy Efficiency Graph





## Floor Plan

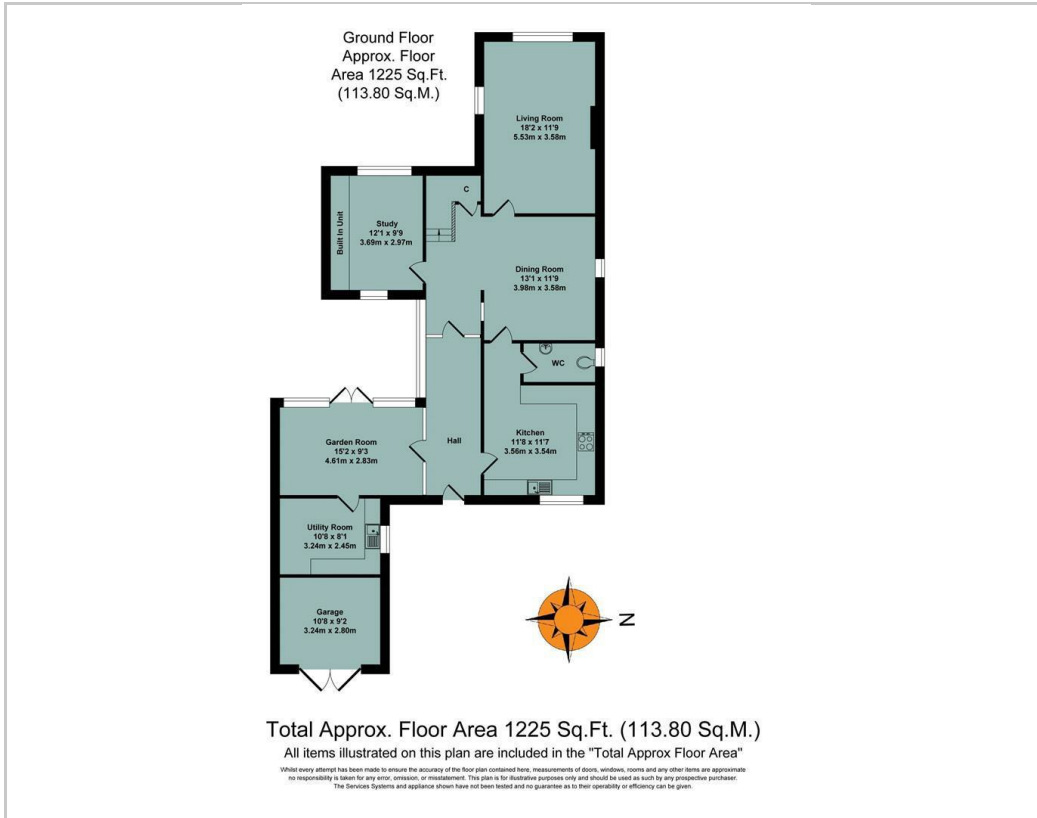

## Floor Plan

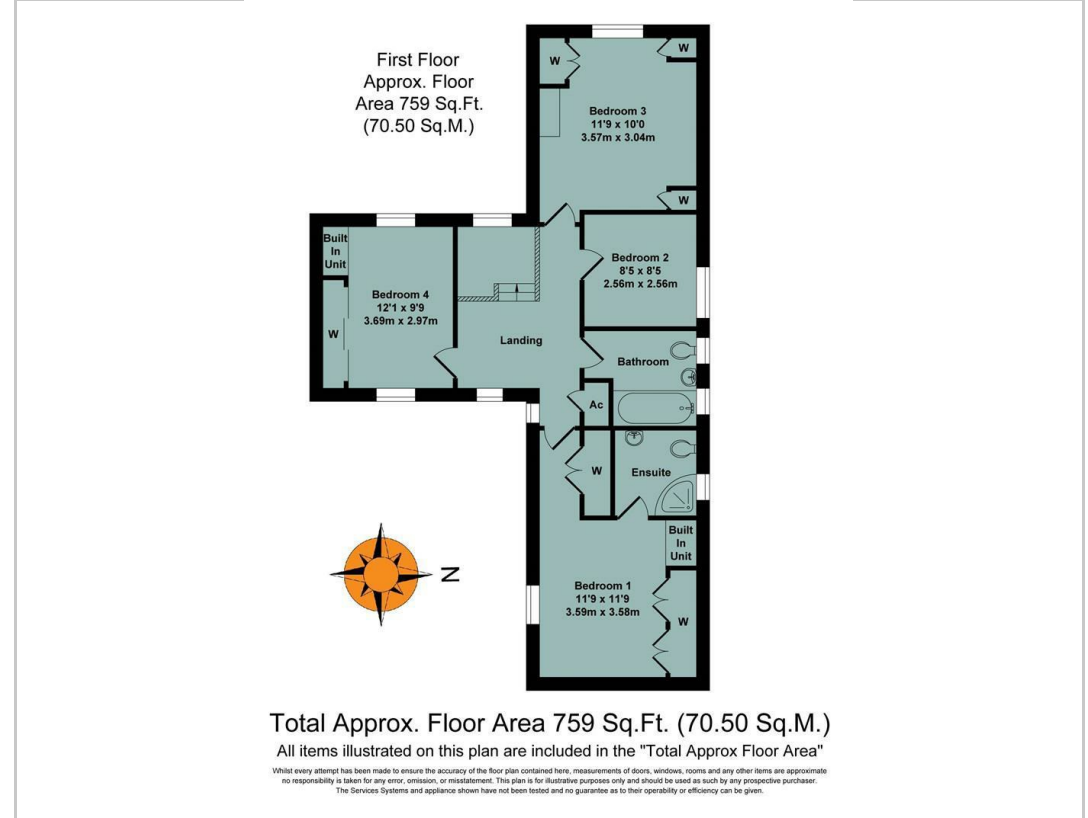

## Viewing

Please contact our In House Sales & Lettings Office on 01491 839999 opt.1  
if you wish to arrange a viewing appointment for this property or require further information.

These particulars, whilst believed to be accurate are set out as a general outline only for guidance and do not constitute any part of an offer or contract. Intending purchasers should not rely on them as statements of representation of fact, but must satisfy themselves by inspection or otherwise as to their accuracy. No person in this firms employment has the authority to make or give any representation or warranty in respect of the property.

28 St Martins Street, Wallingford, Oxfordshire, OX10 0AL  
Tel: 01491 839999 opt.1 Email: [sales@inhouseestateagents.co.uk](mailto:sales@inhouseestateagents.co.uk) [www.inhouseestateagents.co.uk](http://www.inhouseestateagents.co.uk)