

WE VALUE



YOUR HOME



Goring Road, Woodcote
Guide Price £600,000



Configured to make great use of space, this generous detached property is very well-presented both inside and out. Featuring spacious reception rooms with a lounge/diner measuring in excess of 26ft, a light and modern kitchen/breakfast room, three bedrooms with an en-suite to the master and separate shower room arranged over two floors, and to the outside space, a landscaped rear garden with raised decking, a beautifully maintained lawn, a garage and enough off-street parking for all the family and visitors too! If you are looking for a family home in a village location but don't want to compromise on space either inside or out, this Dorma-bungalow could be the perfect find!





- DETACHED DORMA BUNGALOW
- 26FT LOUNGE/DINER
- SPACIOUS KITCHEN/BREAKFAST ROOM
- EN-SUITE TO MAIN BEDROOM
- GARAGE & AMPLE OFF-STREET PARKING
- GENEROUS LANDSCAPED REAR GARDEN
- MODERN & LIGHT INTERIOR
- WELL-PRESENTED THROUGHOUT
- VILLAGE LOCATION WITH EASY ACCESS TO MAJOR TOWNS
- POTENTIAL TO EXTEND (SUBJECT TO PLANNING)

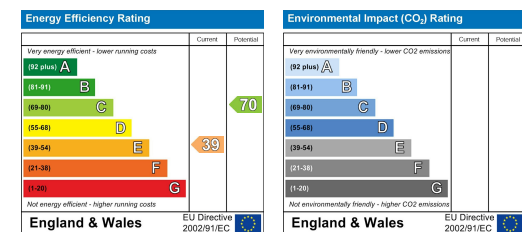

Energy Efficiency Graph

Floor Plan

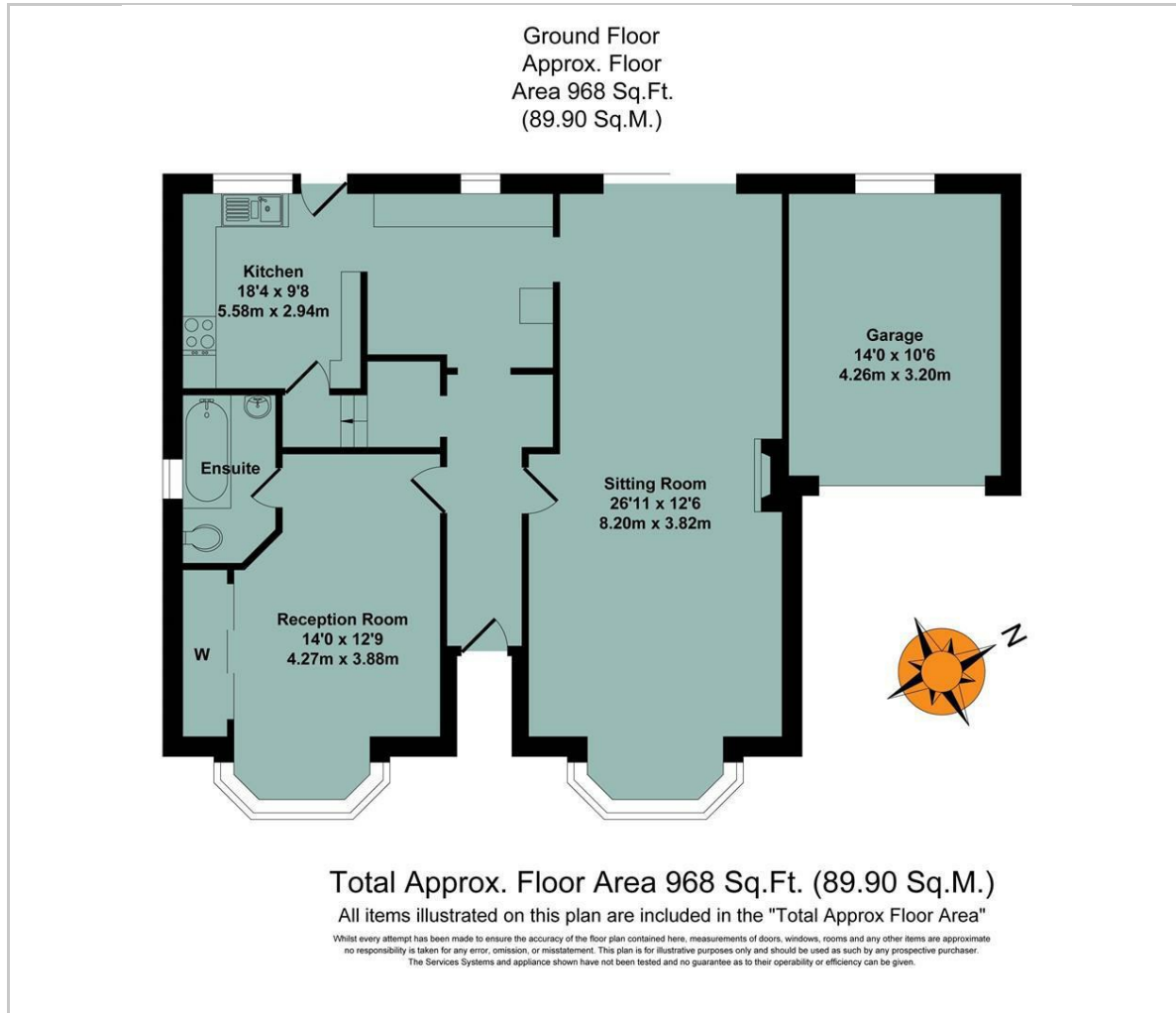

Area Map



Viewing

Please contact our In House Sales & Lettings Office on 01491 839999 opt.1
if you wish to arrange a viewing appointment for this property or require further information.

These particulars, whilst believed to be accurate are set out as a general outline only for guidance and do not constitute any part of an offer or contract. Intending purchasers should not rely on them as statements of representation of fact, but must satisfy themselves by inspection or otherwise as to their accuracy. No person in this firm's employment has the authority to make or give any representation or warranty in respect of the property.

28 St Martins Street, Wallingford, Oxfordshire, OX10 0AL
Tel: 01491 839999 opt.1 Email: sales@inhouseestateagents.co.uk www.inhouseestateagents.co.uk