

24, Bolton Road, Aspull, WN2 1YY





## 24, Bolton Road, Aspull, WN2 1YY

*Spacious two bed mid-terrace home located in Aspull village.*



- Spacious mid-terrace home
- Well equipped fitted kitchen
- Modern fitted family bathroom
- NO ONWARD CHAIN
- Two large reception rooms
- Two large double bedrooms
- Good sized rear yard
- 894 SQ. FT.

Situated in the ever-popular village of Aspull with the green to the front sits this impressive, two bed mid-terrace home. Bolton Road would make an ideal home for the first time buyer given its turn-key internal condition and having NO ONWARD CHAIN. The property offers excellent access to the village amenities Aspull has to offer along with great public transport links, Hindley train station, schools and access into Wigan, Horwich, Westhoughton and Bolton.

Internally the property has been finished to a great standard with the accommodation briefly comprising of spacious formal lounge / sitting room located to the front, large separate dining room located to the rear with double patio doors leading out on to the yard and then a well-equipped fitted kitchen. Up on the first floor there are two good sized double bedrooms and a modern fitted family bathroom.

Externally the property has the village green to the front with on street parking, to the rear there is a good sized and enclosed rear yard which is not overlooked. Internal inspection is recommended to appreciate the properties internal finish and its great location.







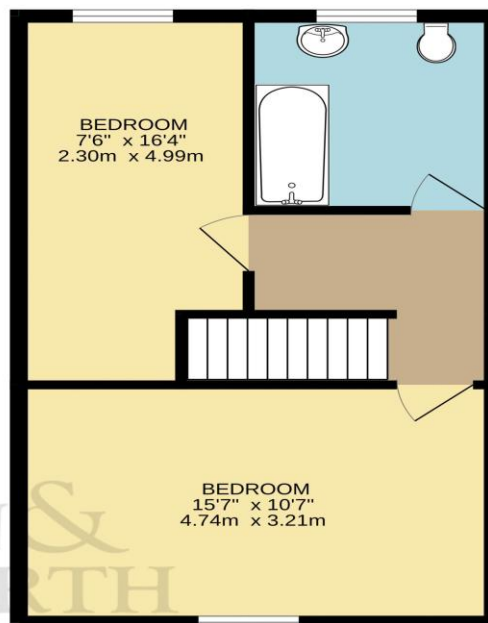
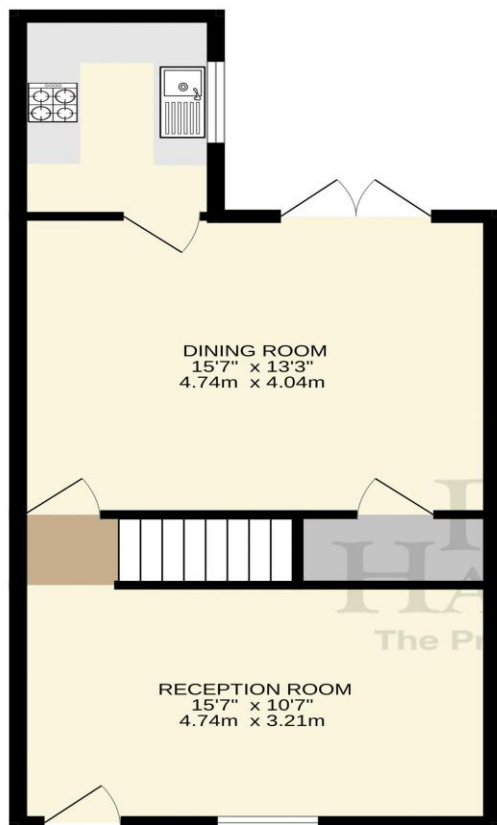

TOTAL FLOOR AREA : 894 sq.ft. (83.1 sq.m.) approx.  
 Whilst every attempt has been made to ensure the accuracy of the floorplan contained here, measurements of doors, windows, rooms and any other items are approximate and no responsibility is taken for any error, omission or mis-statement. This plan is for illustrative purposes only and should be used as such by any prospective purchaser. The services, systems and appliances shown have not been tested and no guarantee as to their operability or efficiency can be given.  
 Made with Metropix ©2025



rightmove

onTheMarket.com

The Property Ombudsman

LR Finance

We do our best to ensure that our sales particulars are accurate and are not misleading. We also ask our clients to check their own sales particulars and verify the information contained in them is correct. However, fixtures and fittings and appliances have not been tested and therefore no guarantee can be given that they are in working order. All measurements and land sizes are quoted approximately. **Tenure** - Regan & hallworth have not had sight of the title documents and therefore the buyer is advised to obtain verification from their solicitors or surveyor. **Council Tax** - You are advised to contact the local authority for details. **Wigan:** 01942 244991 | **West Lancashire:** 01695 585258 | **Chorley:** 01257 515151. If there is any point of particular interest to you please contact us and we will be pleased to check the information.

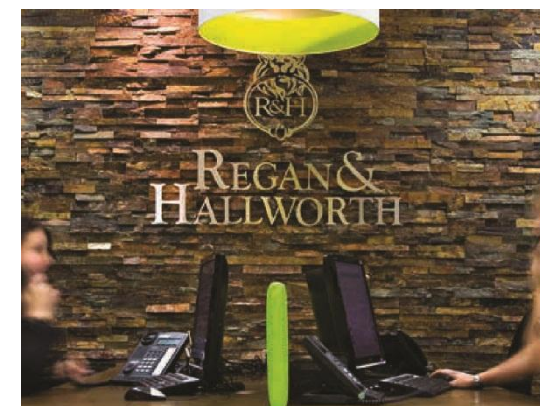

**WIGAN OFFICE**  
 4-6 Library Street, Wigan  
 Lancashire WN1 1NN  
 01942 205555  
[wigan@reganandhallworth.com](mailto:wigan@reganandhallworth.com)

**STANDISH OFFICE**  
 8 High Street, Standish  
 Wigan WN6 0HL  
 01257 473727  
[standish@reganandhallworth.com](mailto:standish@reganandhallworth.com)

**PARBOLD OFFICE**  
 5-7 Station Road, Parbold Village  
 Lancashire WN8 7NU  
 01257 464644  
[parbold@reganandhallworth.com](mailto:parbold@reganandhallworth.com)

 @reganhallworth

 Regan & Hallworth

 @reganandhallworth

 @reganhallworth

[www.reganandhallworth.com](http://www.reganandhallworth.com)