

10, Ashland Avenue, Ashton-In-Makerfield , WN4 9SP



## 10, Ashland Avenue, Ashton-In-Makerfield , WN4 9SP

*Excellent three bed, bay fronted end terrace home with gardens and large garage.*



- Exceptional bay fronted end-terrace home
- Modern fitted kitchen with cooker
- Three good sized bedrooms
- Close to schools and amenities
- Two superb sized reception rooms
- Family bathroom with shower
- Front and rear gardens and garage
- 981 SQ. FT.

Located along the ever-popular Ashland Avenue in Ashton-In-Makerfield sits this impressive, garden and bay fronted period end terrace home. The property has been finished to a superb standard offering deceptively spacious accommodation along with large garage / workshop to the rear.

Ashland Avenue is sat close to local amenities and the town centre, outstanding schools for all ages, great public transport links and is just a short drive to several major motorway networks. Internally the accommodation briefly comprises of entrance hallway, formal lounge / sitting room located to the front with bay window, large separate dining room / second sitting room to the rear, modern fitted kitchen offering a range of wall, base and drawer units and then a family bathroom comprising of wc, sink unit and corner shower unit. Up on the first floor there is a large master double bedroom located to the front of the property with two good sized single bedrooms located to the rear.

Externally Ashland Avenue has a yard style garden to the front and to the rear with parking to the front and garage to the rear. Internal inspection is highly recommended to truly appreciate the deceptive size, great finish and outstanding location.





GROUND FLOOR  
632 sq.ft. (58.7 sq.m.) approx.

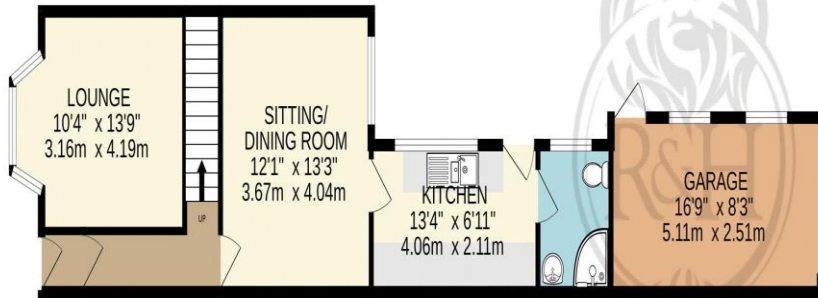

1ST FLOOR  
349 sq.ft. (32.4 sq.m.) approx.

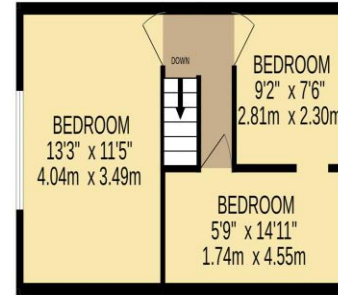

REGAN &  
HALLWORTH

The Professional Estate Agents

TOTAL FLOOR AREA : 981 sq.ft. (91.2 sq.m.) approx.

Whilst every attempt has been made to ensure the accuracy of the floorplan contained here, measurements of doors, windows, rooms and any other items are approximate and no responsibility is taken for any error, omission or mis-statement. This plan is for illustrative purposes only and should be used as such by any prospective purchaser. The services, systems and appliances shown have not been tested and no guarantee as to their operability or efficiency can be given.

Made with Metropix ©2024

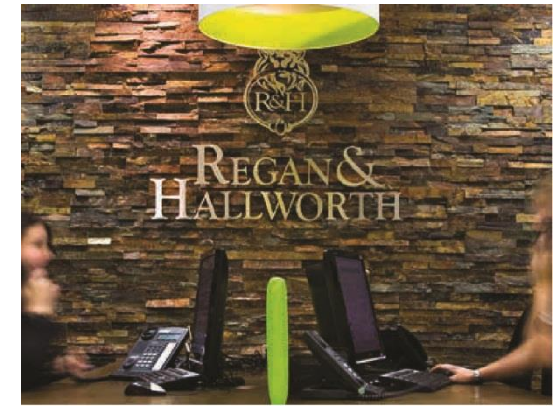

**WIGAN OFFICE**  
4-6 Library Street, Wigan  
Lancashire WN1 1NN  
01942 205555  
wigan@reganandhallworth.com

**STANDISH OFFICE**  
8 High Street, Standish  
Wigan WN6 0HL  
01257 473727  
standish@reganandhallworth.com

**PARBOLD OFFICE**  
5-7 Station Road, Parbold Village  
Lancashire WN8 7NU  
01257 464644  
parbold@reganandhallworth.com



We do our best to ensure that our sales particulars are accurate and are not misleading. We also ask our clients to check their own sales particulars and verify the information contained in them is correct. However, fixtures and fittings and appliances have not been tested and therefore no guarantee can be given that they are in working order. All measurements and land sizes are quoted approximately. **Tenure** - Regan & hallworth have not had sight of the title documents and therefore the buyer is advised to obtain verification from their solicitors or surveyor. **Council Tax** - You are advised to contact the local authority for details. **Wigan:** 01942 244991 | **West Lancashire:** 01695 585258 | **Chorley:** 01257 515151. If there is any point of particular interest to you please contact us and we will be pleased to check the information.

@reganhallworth

Regan & Hallworth

@reganandhallworth

@reganhallworth

[www.reganandhallworth.com](http://www.reganandhallworth.com)