

FOR SALE

3, Brookfield Road, Upholland, WN8 0NZ

REGAN & HALLWORTH
The Professional Estate & Letting Agents

ESTD
1996



3, Brookfield Road, Upholland, WN8 0NZ

Substantial detached true bungalow boasting 1078 SQFT & a quiet cul-de-sac setting



- Spacious detached true bungalow
- Wonderful overall plot
- Highly prized cul-de-sac setting
- Sunny westerly rear aspect
- 3 bedrooms / 1 reception room
- Stunning rear garden
- Beautifully presented throughout
- 1078 SQFT

Boasting beautiful internal presentation throughout & totalling a very generous 1078 square feet of living space - this substantial detached true bungalow is tucked away in one of Upholland's most coveted settings & would be the perfect purchase for any clients seeking the convenience of one floor living, coupled with a very quiet & peaceful semi-rural location. Internally the property is beautifully presented throughout & in brief comprises; a large 19ft main lounge with pretty feature fireplace, three bedrooms (or two beds & a dining room), a modern fitted kitchen with a range of integrated appliances, beyond which is a Upvc conservatory, plus a stunning principal bathroom suite. Externally the plot here is a key addition to the property with the rear garden opening up considerably & being particularly private & mature. The gardens are impeccably manicured & boast a generous Indian Stone patio area for sitting out, plus because of the westerly orientation the garden enjoys lots of late afternoon sun. To the front there is a driveway which provides off road parking & leads through to an attached garage. Early viewings are highly encouraged on this excellent detached bungalow.



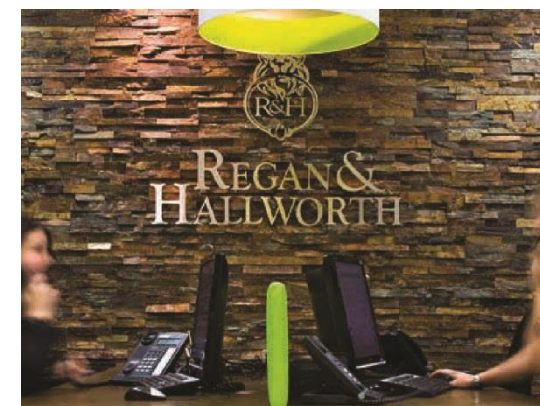
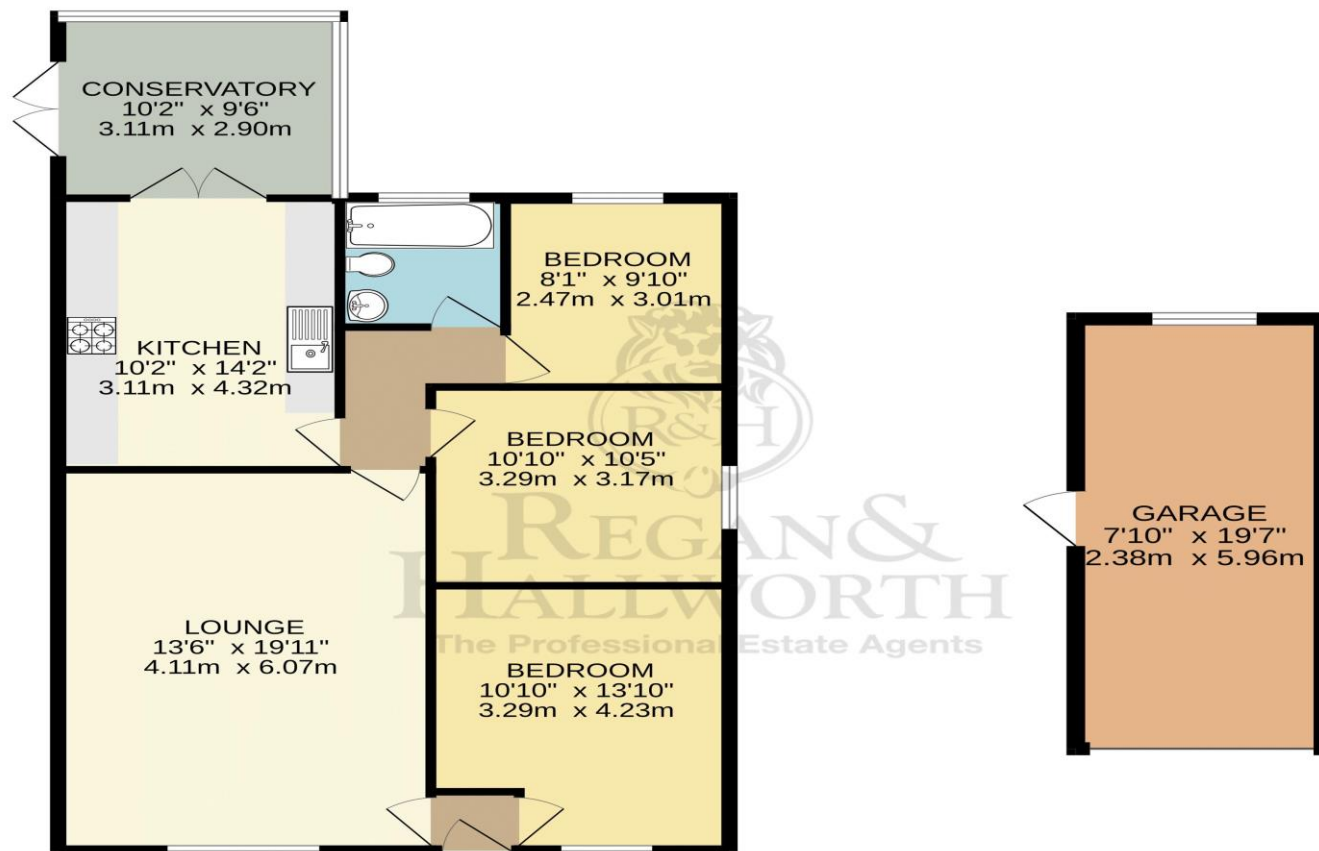

WIGAN OFFICE
4-6 Library Street, Wigan
Lancashire WN1 1NN
01942 205555
wigan@reganandhallworth.com

STANDISH OFFICE
8 High Street, Standish
Wigan WN6 0HL
01257 473727
standish@reganandhallworth.com

PARBOLD OFFICE
5-7 Station Road, Parbold Village
Lancashire WN8 7NU
01257 464644
parbold@reganandhallworth.com

TOTAL FLOOR AREA : 1078 sq.ft. (100.2 sq.m.) approx.
Whilst every attempt has been made to ensure the accuracy of the floorplan contained here, measurements of doors, windows, rooms and any other items are approximate and no responsibility is taken for any error, omission or mis-statement. This plan is for illustrative purposes only and should be used as such by any prospective purchaser. The services, systems and appliances shown have not been tested and no guarantee as to their operability or efficiency can be given.
Made with Metropix ©2024



We do our best to ensure that our sales particulars are accurate and are not misleading. We also ask our clients to check their own sales particulars and verify the information contained in them is correct. However, fixtures and fittings and appliances have not been tested and therefore no guarantee can be given that they are in working order. All measurements and land sizes are quoted approximately. **Tenure** - Regan & hallworth have not had sight of the title documents and therefore the buyer is advised to obtain verification from their solicitors or surveyor. **Council Tax** - You are advised to contact the local authority for details. **Wigan:** 01942 244991 | **West Lancashire:** 01695 585258 | **Chorley:** 01257 515151. If there is any point of particular interest to you please contact us and we will be pleased to check the information.

 @reganhallworth

 Regan & Hallworth

 @reganandhallworth

 @reganhallworth

www.reganandhallworth.com