

**FOR SALE**

20 Brideoake Court, Wellington Place, Standish, WN6 0FH

**REGAN & HALLWORTH**  
The Professional Estate & Letting Agents

ESTD  
1996





## 20 Brideoake Court, Wellington Place, Standish, WN6 0FH

*Smart, upper floor retirement apartment located in the heart of Standish Village.*



- Stunning retirement apartment
- Quality new development
- Pleasant communal lounge
- Lifts to all floors
- 1 bedroom / 1 reception room
- Central village location
- Modern finish
- 628 SQFT

Enviably located right in the very centre of the vibrant village of Standish - Brideoak Court is a stunning, newly built retirement development which is perfect for any retired clients seeking a high quality apartment conveniently situated a stone's throw to the area's shops, amenities, doctors surgery and restaurants.

In brief the apartment comprises; an inner hallway with useful store & utility room, large main lounge / diner, smart fitted kitchen, spacious master bed with built in units and a modern shower room.

Externally there are beautifully manicured & professionally landscaped gardens, a dedicated on-site house manager, intelligent video entry system & 24hr emergency call system. Viewings are highly recommended.







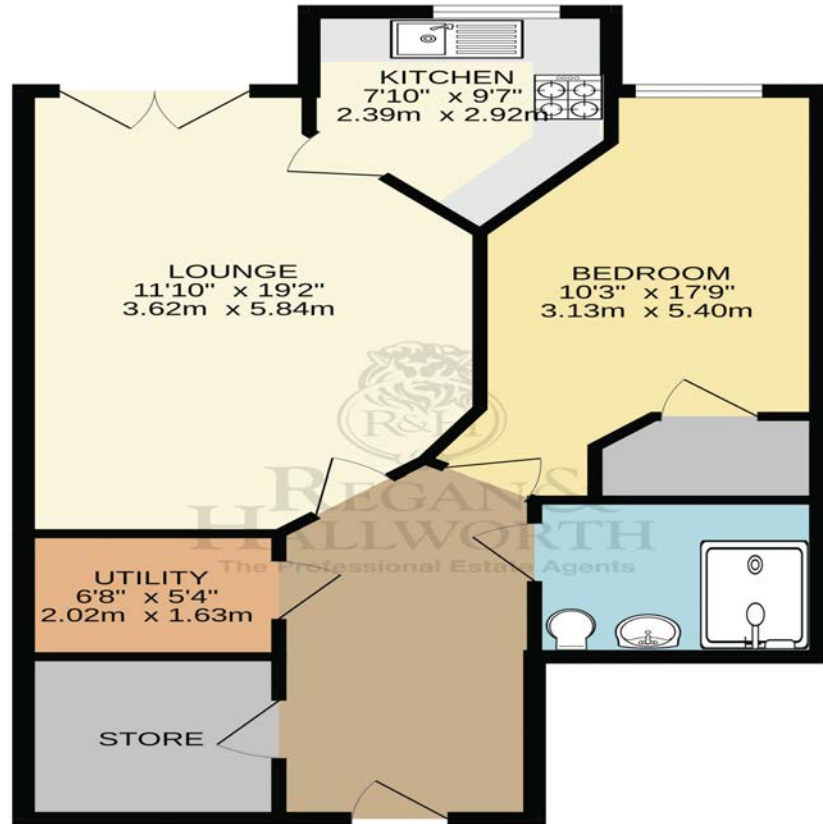

**TOTAL FLOOR AREA : 628 sq.ft. (58.3 sq.m.) approx.**  
 Whilst every attempt has been made to ensure the accuracy of the floorplan contained here, measurements of doors, windows, rooms and any other items are approximate and no responsibility is taken for any error, omission or mis-statement. This plan is for illustrative purposes only and should be used as such by any prospective purchaser. The services, systems and appliances shown have not been tested and no guarantee as to their operability or efficiency can be given.  
 Made with Metropix ©2024



We do our best to ensure that our sales particulars are accurate and are not misleading. We also ask our clients to check their own sales particulars and verify the information contained in them is correct. However, fixtures and fittings and appliances have not been tested and therefore no guarantee can be given that they are in working order. All measurements and land sizes are quoted approximately. **Tenure** - Regan & hallworth have not had sight of the title documents and therefore the buyer is advised to obtain verification from their solicitors or surveyor. **Council Tax** - You are advised to contact the local authority for details. **Wigan:** 01942 244991 | **West Lancashire:** 01695 585258 | **Chorley:** 01257 515151. If there is any point of particular interest to you please contact us and we will be pleased to check the information.

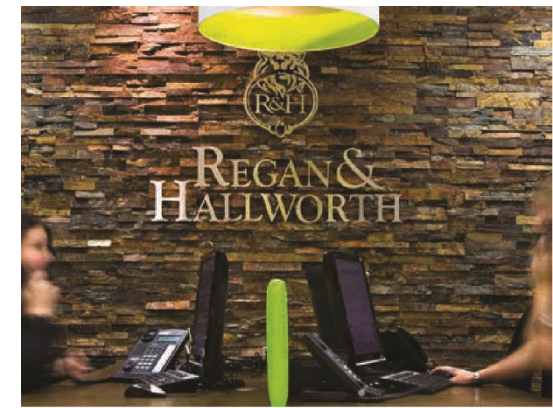

**WIGAN OFFICE**  
 4-6 Library Street, Wigan  
 Lancashire WN1 1NN  
 01942 205555  
[wigan@reganandhallworth.com](mailto:wigan@reganandhallworth.com)

**STANDISH OFFICE**  
 8 High Street, Standish  
 Wigan WN6 0HL  
 01257 473727  
[standish@reganandhallworth.com](mailto:standish@reganandhallworth.com)

**PARBOLD OFFICE**  
 5-7 Station Road, Parbold Village  
 Lancashire WN8 7NU  
 01257 464644  
[parbold@reganandhallworth.com](mailto:parbold@reganandhallworth.com)

@reganhallworth

Regan & Hallworth

@reganandhallworth

@reganhallworth

[www.reganandhallworth.com](http://www.reganandhallworth.com)