



For Sale

9 Chaucer Crescent, Kidderminster

£350,000

4

2

1

0.06 ac

775 sq ft

David Jones

07958 915717

david.jones@thepropertyexperts.co.uk

Extended Four Bedroom Detached House In Desirable Location On The Fringe Of The Popular Offmore Farm Development, Providing Ideal Family Accommodation With Excellent Conservatory Style Rear Garden Room.

Situated on the fringe of the popular Offmore Farm neighbourhood, on the Birmingham side of town, this extended detached property now provides larger than average accommodation well deserving of a personal inspection.

Council Tax Band - C

EPC Rating - E

Tenure - Freehold



 **The Property Experts**

The Property Experts UK

01562546606



Approximate Gross Internal Area = 1355 sq. feet / 125.9 sq. metres

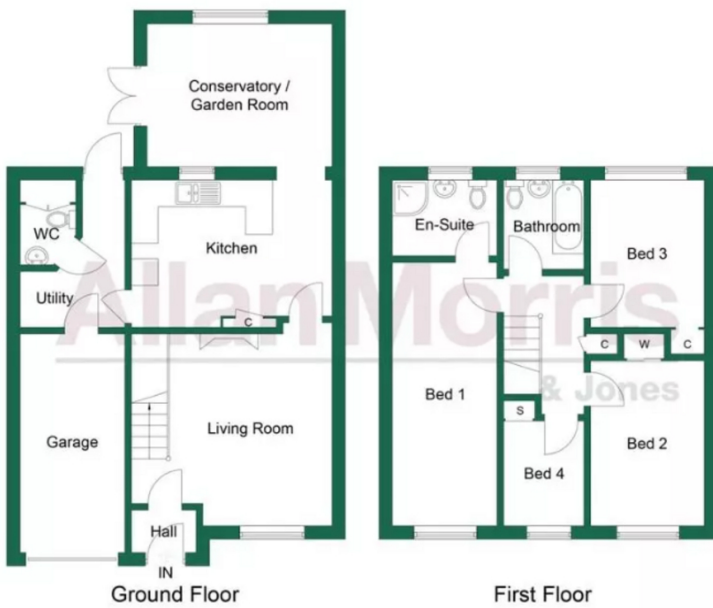

Illustration for identification purposes only, measurements are approximate, not to scale. FloorplansUsketch.com © 2022 (ID891394)

- Lounge With Ornamental Fireplace
- Kitchen Opening Through To Garden Room
- Utility Room & WC
- 17' Master Bedroom
- Bathroom & En-Suite Shower Room
- Integral Garage
- EPC Rating E

