



Energy Efficiency Rating		
	Current	Potential
Very energy efficient - lower running costs		
(92 plus) A		
(81-91) B		
(69-80) C		
(55-68) D		
(39-54) E		
(21-38) F		
(1-20) G		
Not energy efficient - higher running costs		
England & Wales	EU Directive 2002/91/EC	

Environmental Impact (CO ₂) Rating		
	Current	Potential
Very environmentally friendly - lower CO ₂ emissions		
(92 plus) A		
(81-91) B		
(69-80) C		
(55-68) D		
(39-54) E		
(21-38) F		
(1-20) G		
Not environmentally friendly - higher CO ₂ emissions		
England & Wales	EU Directive 2002/91/EC	

Stoke Place, London, NW10 6EH

£2,900 PCM

Subject to Contract

- Newly redurbished three or four bedroom house
- Contemporary white laquered kitchen with compound worktops
- Newly fitted bathroom combined W.C
- Rear garden
- Gas central heatin
- Excellent transport links



Stoke Place, NW10 6EH

Newly refurbished and full of character, this charming three-bedroom mid-terrace railway cottage offers a perfect blend of period features and contemporary elegance. Spanning over 1,019 sq. ft. across two floors, the home features timber-style flooring, high ceilings, and a delightful patio garden.

The ground floor comprises a welcoming reception room or bedroom with a feature fireplace, a separate bright dining room overlooking the garden, and a contemporary white lacquered kitchen with composite worktops and direct access to the outdoor space. A stylish modern bathroom with WC completes this level. Upstairs, the property offers three well-proportioned bedrooms, ideal for families, professionals, or those needing flexible living space.

Perfectly positioned just moments from Willesden Junction Overground and Bakerloo Line station, the home benefits from excellent transport links, along with nearby shops and local amenities.

A rare opportunity to rent a truly unique and stylish railway cottage in a highly sought-after location.

Available now.

Stoke Place, NW10 6EH

Approx Gross Internal Area = 94.7 sq m / 1019 sq ft

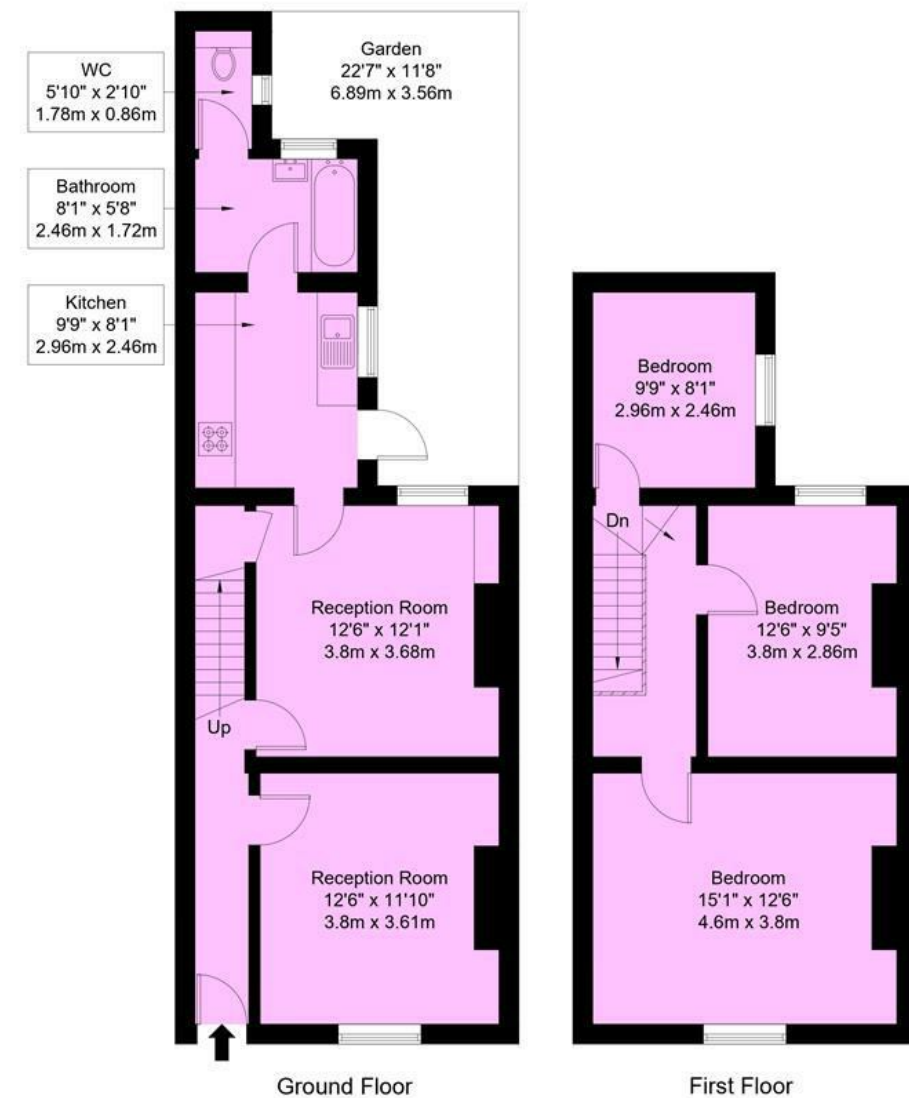
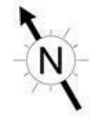

The Floor plan is not to scale and measurements and areas shown are approximate and therefore should be used for illustrative purposes only. The plan has been prepared in accordance with the RICS code of Measuring Practice and whilst we have confidence in the information produced it must not be relied on. Maximum lengths and widths are represented on the floor plan. If there is any aspect of particular importance, you should carry out or commission your own inspection of the property. Copyright @ BleuPlan

Tenure

Price £2,900 PCM Subject to Contract

Viewing by appointment , through joint sole agents Warwick Estate Agents



Tel: +44 (0)2 8960 9988
Fax: +44 (0)2 8960 9989

Email: mail@warwickestateagency.co.uk
warwickestateagents.tv | warwickestateagents.co.uk

69 Chamberlayne Road, London NW10 3ND
Tel: +44 (0)20 8960 9988 Fax: +44 (0)20 8960 9989