

Shelley Road, Harlesden, NW10 8NW

Asking Price £670,000

Subject to Contract

Energy Efficiency Rating		
	Current	Potential
Very energy efficient - lower running costs		
(92 plus) A		87
(81-91) B		
(69-80) C	74	
(55-68) D		
(39-54) E		
(21-38) F		
(1-20) G		

Environmental Impact (CO ₂) Rating		
	Current	Potential
Very environmentally friendly - lower CO ₂ emissions		
(92 plus) A		88
(81-91) B		
(69-80) C	73	
(55-68) D		
(39-54) E		
(21-38) F		
(1-20) G		

We have endeavoured to supply this information as accurate as possible. Before making an offer, buying or renting this property please seek independent or professional advice.

- Four bedrooms
- Sizeable kitchen
- Bathroom combined W.C
- South/easterly facing rear garden
- Double glazing
- French doors leading out to garden from reception room
- Dining area
- Guest W.C
- Off street parking
- Gas central heating



Tel: +44 (0)2 8960 9988
Fax: +44 (0)2 8960 9989

Email: mail@warwickstateagency.co.uk
warwickstateagents.tv | warwickstateagents.co.uk

69 Chamberlayne Road, London NW10 3ND
Tel: +44 (0)20 8960 9988 Fax: +44 (0)20 8960 9989



Shelley Road, NW10 8NW

Suitable for a multitude of uses...

storey town house, with sunny rear garden & off street parking to front. French doors leading out to private south/easterly facing rear garden from reception room, fitted kitchen with dining area, modern fitted bathroom and guest W.C, additional benefits include timber style flooring and gas central heating.

Conveniently located in a side street just off Acton Lane, in close proximity of local shops, only a stone's throw of Harlesden (Bakerloo line) tube and alternative transport facilities.

WARWICK
ESTATE AGENTS
25 YEARS
EXPERIENCE

SHELLEY ROAD, NW10
TOTAL APPROX. FLOOR PLAN AREA 1133 SQ.FT. (105 SQ.M.)

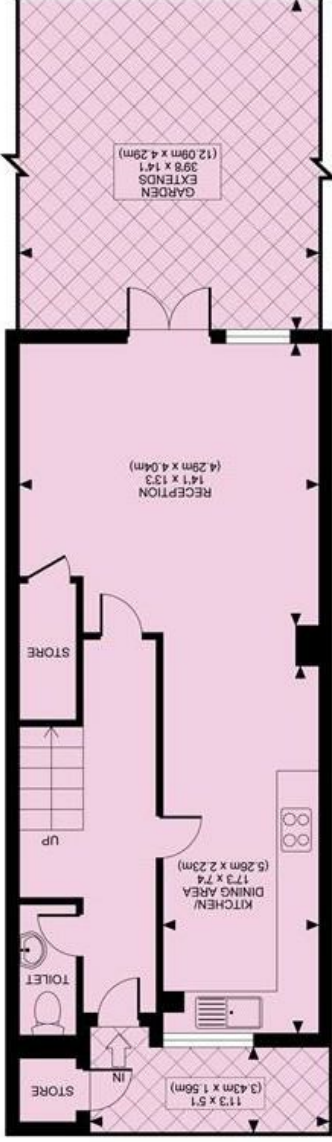
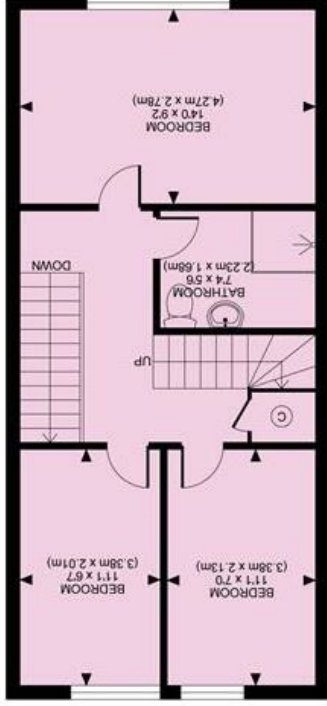
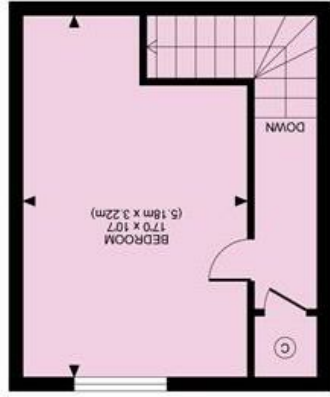

All measurements walls, doors, windows, fittings and their appliances, their size and locations are shown conventionally and are approximate only and cannot be regarded as being a representation either by the seller or his agent nor Zentuvo www.zentuvo.co.uk

Zentuvo

69 Chamberlayne Road, London NW10 3ND
 Email: mail@warwickestateagency.co.uk | warwickestateagents.co.uk
 Tel: +44 (0)20 8960 9988 Fax: +44 (0)20 8960 9989

Tel: +44 (0)2 8960 9988
 Fax: +44 (0)2 8960 9989

