



£1,500 pcm  
Charcot Road, Colindale



 1  
Bedroom

 1  
Bathroom

211 Edgware Rd, London, NW9 6LP |  
colindale@warrenbradleystates.co.uk

020 8200 7007



£1,500 pcm  
Charcot Road, Colindale



Warren Bradley Estates are pleased to offer for rent this spacious studio/1 bedroom apartment with a separate bedroom on the fourth floor flat with lift, situated in the Pulse Development. Located close to Colindale tube station this property is ideal for professionals. Benefitting from a large separate sleeping area, fully fitted kitchen with fridge/freezer, washing machine, oven and dishwasher, a fully tiled bathroom and double glazing.

Offered fully furnished the property is available from 30th May 2025.





### Crawford Court

Approx. 34.6 sq. metres (372.9 sq. feet)

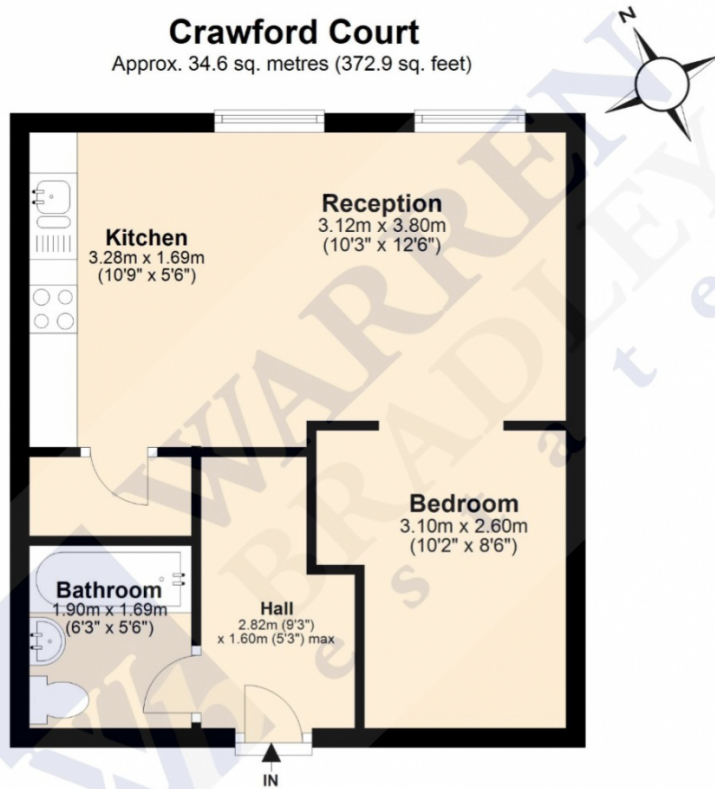

Disclaimer: Please note this floor plan is for marketing purposes and is to be used as a guide only.  
Plan produced using PlanUp.

Energy Efficiency Rating		Current	Potential
Very energy efficient - lower running costs			
(92-100) <b>A</b>			
(81-91) <b>B</b>		83	83
(69-80) <b>C</b>			
(55-68) <b>D</b>			
(39-54) <b>E</b>			
(21-38) <b>F</b>			
(1-20) <b>G</b>			
Not energy efficient - higher running costs			
England, Scotland & Wales		EU Directive 2002/91/EC	

Environmental Impact (CO <sub>2</sub> ) Rating		Current	Potential
Very environmentally friendly - lower CO <sub>2</sub> emissions			
(92-100) <b>A</b>		97	97
(81-91) <b>B</b>			
(69-80) <b>C</b>			
(55-68) <b>D</b>			
(39-54) <b>E</b>			
(21-38) <b>F</b>			
(1-20) <b>G</b>			
Not environmentally friendly - higher CO <sub>2</sub> emissions			
England, Scotland & Wales		EU Directive 2002/91/EC	

