



1

Bedroom



1

Bathroom



We are pleased to offer to rent this one bedroom first floor purpose built flat.

This furnished property is offered in good condition and has the additional benefits of double glazing, gas cooking, entryphone and an allocated parking space. Located on the popular 'Bird' development. The property is a few minutes from Colindale's Northern Line Underground Station and local shops. The property is offered part furnished and is available 01/06/2024.

Yellowhammer Court

Approx. 33.6 sq. metres (361.4 sq. feet)

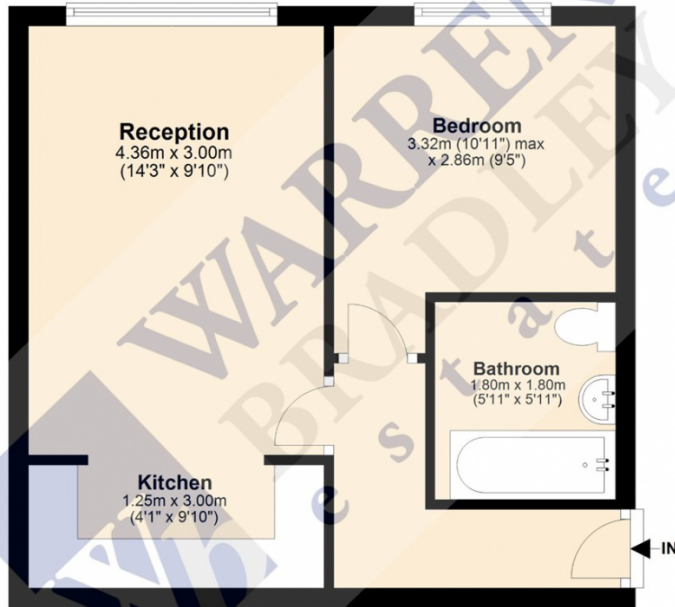

Total area: approx. 33.6 sq. metres (361.4 sq. feet)

Disclaimer: Please note this floor plan is for marketing purposes and is to be used as a guide only.

Plan produced using PlanUp.

Score	Energy rating	Current	Potential
92+	A		
81-91	B	82 B	82 B
69-80	C		
55-68	D		
39-54	E		
21-38	F		
1-20	G		

The graph shows this property's current and potential energy rating.

