



**15 Beech Hurst Close, Maidstone, Kent, ME15 7PG**  
**Price Guide £350,000**



PRICE GUIDE: £350,000 - £375,000. A WELL PRESENTED THREE BEDROOM SEMI- DETACHED FAMILY HOME SITUATED IN A SOUGHT AFTER CUL DE SAC SETTING WITHIN CLOSE PROXIMITY OF MAIDSTONE TOWN CENTRE AND REPUTABLE GRAMMAR SCHOOLS.

This attractive three bedroom family home offers spacious accommodation which includes a downstairs cloakroom, spacious lounge, dining room, kitchen, a converted garage which could be utilised as either an office or games room. In addition there is a conservatory, where the roof has recently been replaced with a view to retaining the heat internally. The first floor consists of three bedrooms, the principal bedroom benefits from an en-suite shower room, there is a family bathroom. A driveway provides off road parking and there is a pleasant low maintenance garden to the rear. Internal viewing is highly recommended. Contact: PAGE & WELLS King Street office 01622 756703.

EPC rating: C  
Council tax band: D  
Tenure: Freehold



## LOCATION

Situated in a poplar cul de sac setting within walking distance of the town centre, primary schools and two grammar schools.

## PROPERTY INFORMATION

A well presented three bedroom semi-detached family home, with an en-suite, converted garage and conservatory.

## KEY FEATURES

Downstairs cloakroom

En-suite shower to principal bedroom

Conservatory

Office/Games Room

Cul de sac location

## ROOMS

### GROUND FLOOR

Lounge: 15'5 x 11'10 (4.70m x 3.61m)

Dining Room: 11'4 x 7'5 (3.45m x 2.26m)

Kitchen: 11'4 x 7'6 (3.45m x 2.29m)

Office/Games Room: 11'1 x 7'7 (3.38m x 2.31m)

Conservatory: 11'7 x 7'10 (3.53m x 2.39m)

### FIRST FLOOR:

Landing

Principal Bedroom: 12'1 x 9'9 (3.68m x 2.97m)

En-suite Shower Room

Bedroom 2: 9'10 x 8'6 (3.00m x 2.59m)

Bedroom 3: 8'8 x 6'6 (2.64m x 1.98m)

Family Bathroom

### EXTERNALLY:

There is a driveway providing off road parking facilities and a pleasant garden to the rear.

### VIEWING

Viewing strictly by arrangements with the Agent's Head Office:  
52-54 King Street, Maidstone, Kent ME14 1DB  
Tel. 01622 756703

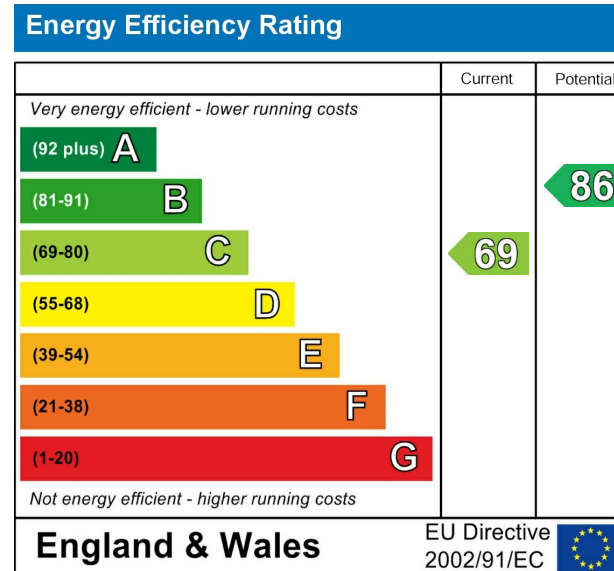

Page & Wells limited for themselves and for the vendors of this property whose agents they are give notice that: 1. These particulars do not constitute any part of, an offer or a contract. 2. All statements contained in these particulars as to this property are made without responsibility on the part of Page & Wells Limited or the Vendor. 3. None of the statements contained in these particulars as to the property is to be relied on as statements or representations of fact. 4. Any intending purchaser must satisfy himself by inspection or otherwise as to the correctness of each of the statements contained in these particulars. 5. The vendor does not make or give, and neither Page & Wells Limited nor any person in their employment has any authority to make or give any representation whatsoever in relation to this property. These particulars are supplied on the understanding that all negotiations are carried out throughout Page & Wells Limited. Properties with a reference prefixes EAA are those which Page & Wells Limited disclose an interest in accordance with the provisions of the Estates Agents Act 1979



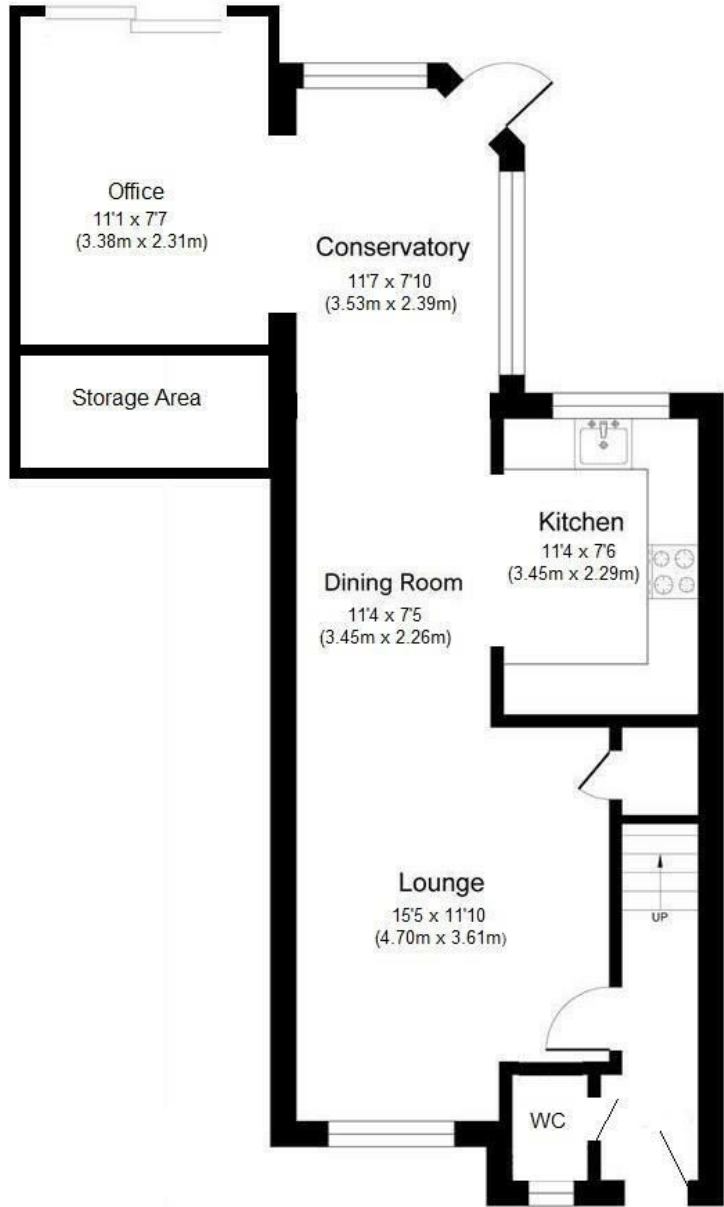

**Ground Floor**

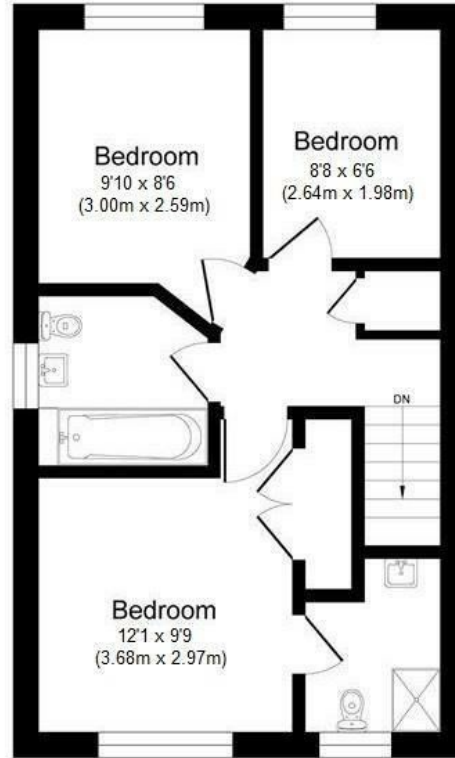

**First Floor**

