



Johnson Drive, Leighton Buzzard, LU7 4RT

Offers In Excess Of £325,000

3 1 2 C

- Three Bedrooms
- Spacious End of Terrace House
- Two Allocated Parking Spaces
- 17Ft Kitchen/Diner
- 17Ft X 17Ft Living Room
- Short Walk to Astral Lake & Park
- Downstairs WC
- Low Maintenance Rear Garden
- Great Family Home or First Time Buy
- Excellent for Commuting to M1 & A5





Floor Plan

Ground Floor

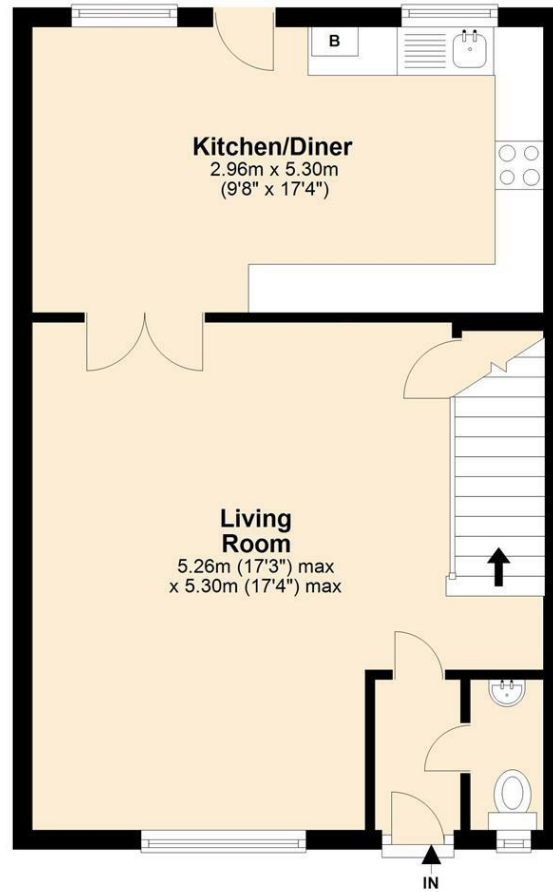

First Floor

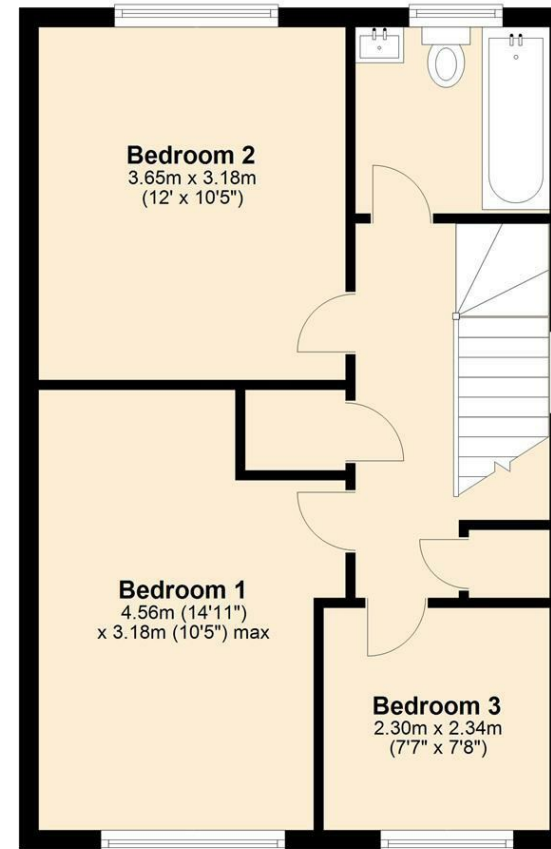

Viewing

Please contact our Leighton Buzzard Office on 01525 377733.
If you wish to arrange a viewing appointment for this property or require further information.

IMPORTANT: Whilst we aim to make our details accurate and reliable, if there is any point of particular concern to you, please contact the office. The apparatus, equipment, fittings and services have not been checked and therefore it is in the purchaser's interest to establish the working condition of the appliance included. Personal items such as furnishings which may be shown in the photographs are not included in the asking price. No survey has been carried out by M & M Properties. Measurements have a tolerance of +/- 3". Please note that this floorplan has not been drawn to scale and is therefore for room layout purposes only. It does not constitute or form part of a contract. Doors may be hung in opposite directions.