



Lilac Place, Kettering **Freehold** £260,000 O.I.E.O.

**Pattison  
Lane**



# Key Features

🛏️ 4 🚿 1 💡 C 🏠 B

- Four Double Sized Bedrooms
- Two Reception Rooms
- Substantial Corner Plot
- End of Terraced Family Home
- Gated Off Road Parking

Welcome to the market, occupying a substantial corner position within a quiet cul-de-sac, this significantly extended four-bedroom end of terrace family home offers an exceptional balance of space and serenity.

Perfectly positioned within a short stroll away from Kettering Town Centre and within close proximity to local shops, schools and the railway station, this home represents a prime choice for growing families and commuters alike.





The ground floor is designed for both relaxation and entertaining. A welcoming entrance hall leads to a traditional front reception room, while the heart of the home is a sprawling, dual-aspect living/dining room featuring elegant LVT flooring. The generous kitchen offers ample utility space while the bright conservatory, creates a bright and airy space, seamlessly connection to the garden.

Upstairs, the sense of scale continues with four impressively proportioned bedrooms. The principal bedroom includes integrated storage, and all are served by a comprehensive four-piece family bathroom, complete with a corner bath and a separate walk-in shower.

The property's corner plot ensures a wrap-around feel with low-maintenance frontage and substantial gated off-road parking. The private rear garden is fully enclosed by timber fencing, offering a manicured lawn and a patio area perfect for alfresco dining.

Viewings are highly advised to appreciate all this family home has to offer!



GROUND FLOOR

1ST FLOOR

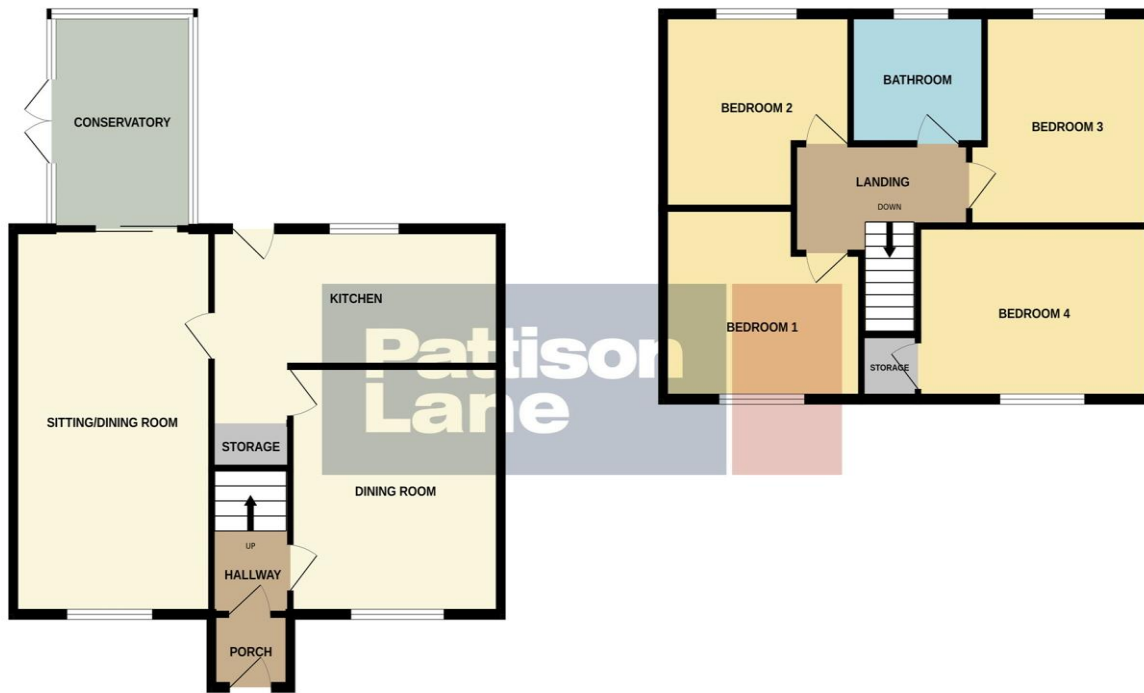

Whilst every attempt has been made to ensure the accuracy of the floorplan contained here, measurements of doors, windows, rooms and any other items are approximate and no responsibility is taken for any error, omission or mis-statement. This plan is for illustrative purposes only and should be used as such by any prospective purchaser. The services, systems and appliances shown have not been tested and no guarantee as to their operability or efficiency can be given.  
Made with Metropix ©2026

The accommodation comprises:

ENTRANCE PORCH

HALLWAY

DINING ROOM 13'6 x 12'9 (4.11m x 3.88m)

KITCHEN 17' x 7'6 (5.18m x 2.28m)

SITTING / DINING ROOM 21' x 12' (6.40m x 3.65m)

CONSERVATORY 11'9 x 8'7 (3.58m x 2.61m)

FIRST FLOOR LANDING

BEDROOM ONE 12' x 10'5 (3.65m x 3.17m)

BEDROOM TWO 12' x 10'4 (3.65m x 3.14m)

BEDROOM THREE 11'3 x 10'1 (3.42m x 3.07m)

BEDROOM FOUR 14'1 x 9'5 (4.29m x 2.87m)

BATHROOM 8'1 x 7'7 (2.46m x 2.31m)

OUTSIDE

FRONT GARDEN

REAR GARDEN

GATED OFF ROAD PARKING

To view this property call Pattison Lane on:  
**01536 524425**



# Selling your property?

Contact us to arrange a **FREE** home valuation.

 01536 524425

 68-70 Gold Street, Kettering, Northamptonshire, NN16 8JB

 [kettering@pattisonlane.co.uk](mailto:kettering@pattisonlane.co.uk)

 [www.pattisonlane.co.uk](http://www.pattisonlane.co.uk)



 SCAN ME



 SCAN ME



Sharman Quinney Holdings Limited is registered in England and Wales under company number 4174227, Registered Office is Cumbria House, 16-20 Hockliffe Street, Leighton Buzzard, Bedfordshire, LU7 1GN. VAT Registration Number is 500 2481 05.

1: These particulars do not constitute part or all of an offer or contract. 2: The measurements indicated are supplied for guidance only and as such must be considered incorrect. 3: Potential buyers are advised to recheck the measurements before committing to any expense. 4: Sharman Quinney has not tested any apparatus, equipment, fixtures, fittings or services and it is the buyers interests to check the working condition of any appliances. 5: Sharman Quinney has not sought to verify the legal title of the property and buyers must obtain verification from their legal representative. 6: Intending purchasers will be asked to produce identification documentation at a later stage and we would ask your co-operation in order that there will be no delay in agreeing the sale. Ref: KPL206645 - 0002

