



Terry Smith Avenue, Rothwell Kettering **Freehold** £310,000

**Pattison
Lane**

Key Features

 3  2   D

- Three Bedroom Detached House
- Garage & Driveway
- En Suite to Master Bedroom
- Downstairs Cloakroom
- Looking Out To Green Space

Situated within a sought-after contemporary development in the vibrant market town of Rothwell, this three-bedroom detached residence is presented in immaculate decorative order. Combining modern architectural design with a high-specification finish.

The home is perfectly positioned for those requiring seamless access to the A14 and wider commuter networks while remaining close to the heart of a historic market community.

The ground floor accommodation is designed for both functionality and style, centered around an expansive open-plan kitchen and dining area that serves as the social hub of the home. This bright and airy space is complemented by a welcoming entrance hall and a convenient guest cloakroom.



To the first floor, the property offers three well-proportioned bedrooms, including a principal suite complete with a private en-suite shower room, alongside a modern family bathroom.

Externally, the property truly excels with a professionally landscaped rear garden. This private sanctuary features a substantial decked terrace, meticulously designed for outdoor entertaining and alfresco dining. Further benefits include a private driveway and a detached garage, providing ample off-road parking and storage. Offered to the market in "turn-key" condition, an internal viewing is essential to appreciate the quality and lifestyle opportunity on offer.

The accommodation comprises:

ENTRANCE HALL

CLOAKROOM

LIVING ROOM

KITCHEN / DINING ROOM

FIRST FLOOR LANDING

BEDROOM ONE



GROUND FLOOR

1ST FLOOR

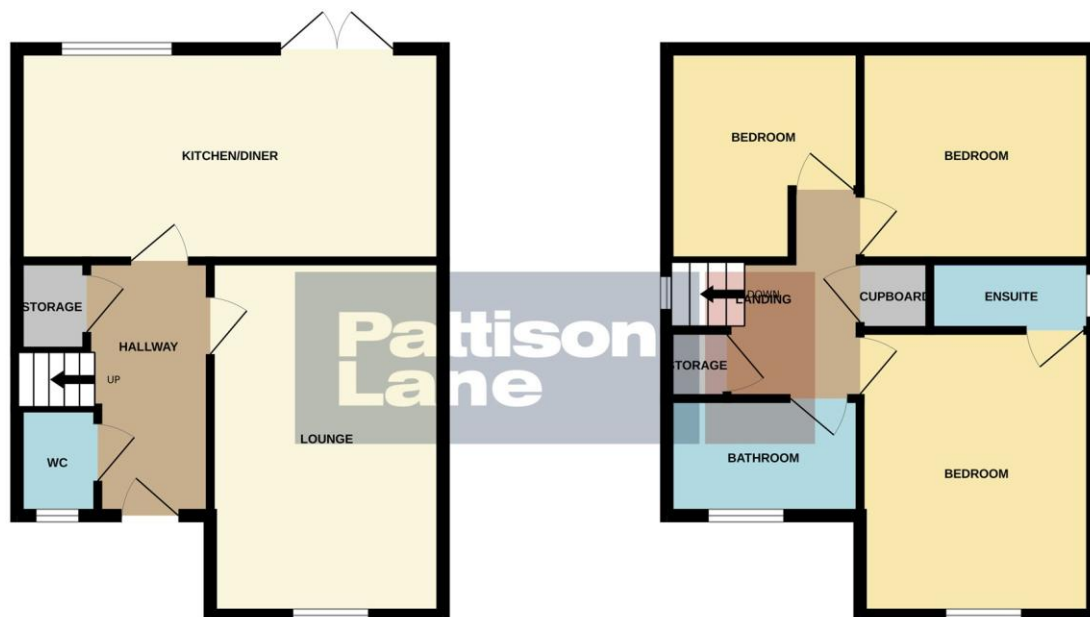

Whilst every attempt has been made to ensure the accuracy of the floorplan contained here, measurements of doors, windows, rooms and any other items are approximate and no responsibility is taken for any error, omission or mis-statement. This plan is for illustrative purposes only and should be used as such by any prospective purchaser. The services, systems and appliances shown have not been tested and no guarantee as to their operability or efficiency can be given.
Made with Metropix ©2025

EN SUITE

BEDROOM TWO

BEDROOM THREE

BATHROOM

OUTSIDE

FRONT GARDEN

GARAGE & DRIVEWAY

REAR GARDEN

To view this property call Pattison Lane on:
01536 524425

Selling your property?

Contact us to arrange a **FREE** home valuation.

 01536 524425

 68-70 Gold Street, Kettering, Northamptonshire, NN16 8JB

 kettering@pattisonlane.co.uk

 www.pattisonlane.co.uk



 SCAN ME



 SCAN ME



Sharman Quinney Holdings Limited is registered in England and Wales under company number 4174227, Registered Office is Cumbria House, 16-20 Hockliffe Street, Leighton Buzzard, Bedfordshire, LU7 1GN. VAT Registration Number is 500 2481 05.

1: These particulars do not constitute part or all of an offer or contract. 2: The measurements indicated are supplied for guidance only and as such must be considered incorrect. 3: Potential buyers are advised to recheck the measurements before committing to any expense. 4: Sharman Quinney has not tested any apparatus, equipment, fixtures, fittings or services and it is the buyers interests to check the working condition of any appliances. 5: Sharman Quinney has not sought to verify the legal title of the property and buyers must obtain verification from their legal representative. 6: Intending purchasers will be asked to produce identification documentation at a later stage and we would ask your co-operation in order that there will be no delay in agreeing the sale. Ref: KPL206545 - 0001

