



Otter Street, Rothwell **Freehold** £350,000 Offers Over

**Pattison
Lane**

Key Features

 4  2  B  D

- Four Bedroom Detached House
- Garage & Driveway
- Large Living Areas
- Modern Kitchen / Dining Area
- En Suite to Master Bedroom

Situated in a highly desirable location, this property offers an exceptional blend of style and practicality. Benefits include a spacious kitchen/dining area, separate living room, downstairs cloakroom, a garage and driveway providing parking for two cars. Viewing recommended.

Discover the allure of modern family living in this stunning four-bedroom detached home, meticulously crafted by Persimmon Homes.

Situated in a highly desirable location, this property offers an exceptional blend of style and practicality. Imagine welcoming guests into the spacious kitchen/dining area, the heart of the home, or relaxing in the separate living room. Convenience is key with a downstairs cloakroom, a



garage, and a driveway providing parking for two vehicles.

Upstairs, the first floor presents a serene master bedroom complete with built-in wardrobes and an en-suite, alongside a generously sized second double bedroom and a well-appointed family bathroom.

Ascend to the second floor to find two further double bedrooms and a convenient upstairs WC, offering flexibility for a growing family or visiting guests.

Outside, a large, low-maintenance garden with a patio awaits, perfect for outdoor enjoyment. The property also benefits from a garage.

Early viewing is highly recommended to fully appreciate all this exceptional home has to offer.

ENTRANCE HALL

LOUNGE 18'6 x 10'2 (5.63m x 3.09m)

KITCHEN/DINING ROOM 10'5 x 18'5 (3.17m x 5.361m)

CLOAKROOM

FIRST FLOOR



GROUND FLOOR



1ST FLOOR

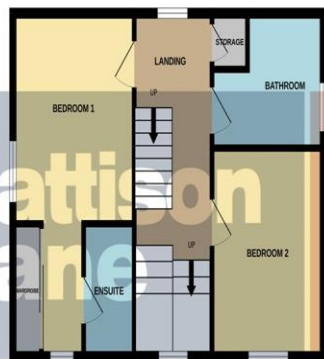

2ND FLOOR

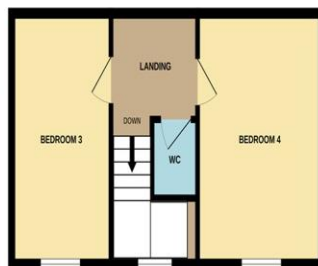

Whilst every attempt has been made to ensure the accuracy of the floorplan contained here, measurements of doors, windows, rooms and any other items are approximate and no responsibility is taken for any error, omission or mis-statement. This plan is for illustrative purposes only and should be used as such by any prospective purchaser. The services, systems and appliances shown have not been tested and no guarantee as to their operability or efficiency can be given.
Made with Metropix ©2025

MASTER BEDROOM 10'4 x 18'6 (3.14m x 5.63m)

DRESSING AREA & EN SUITE

BEDROOM TWO 9'4 x 11'3 (2.84m x 3.42m)

SECOND FLOOR

CLOAKROOM

BEDROOM THREE 8'4 x 13'6 (2.54m x 4.11m)

BEDROOM FOUR 10'5 x 13'7 (3.17m x 4.14m)

OUTSIDE

DRIVEWAY & SINGLE SIZE GARAGE

REAR GARDEN

To view this property call Pattison Lane on:
01536 524425

Selling your property?

Contact us to arrange a **FREE** home valuation.

 01536 524425

 68-70 Gold Street, Kettering, Northamptonshire, NN16 8JB

 kettering@pattisonlane.co.uk

 www.pattisonlane.co.uk



 SCAN ME



 SCAN ME



Sharman Quinney Holdings Limited is registered in England and Wales under company number 4174227, Registered Office is Cumbria House, 16-20 Hockliffe Street, Leighton Buzzard, Bedfordshire, LU7 1GN. VAT Registration Number is 500 2481 05.

1: These particulars do not constitute part or all of an offer or contract. 2: The measurements indicated are supplied for guidance only and as such must be considered incorrect. 3: Potential buyers are advised to recheck the measurements before committing to any expense. 4: Sharman Quinney has not tested any apparatus, equipment, fixtures, fittings or services and it is the buyers interests to check the working condition of any appliances. 5: Sharman Quinney has not sought to verify the legal title of the property and buyers must obtain verification from their legal representative. 6: Intending purchasers will be asked to produce identification documentation at a later stage and we would ask your co-operation in order that there will be no delay in agreeing the sale. Ref: KPL206104 - 0004

