



Hatton Avenue, Wellingborough **Freehold** £475,000 O.I.E.O.

**Pattison
Lane**

Key Features

 3  2  B  E

- Three Bedroom Detached Bungalow
- Garage & Driveway
- Integrated Kitchen Appliances
- En Suite to Master Bedroom
- Log Burning Stove & Under Floor Heating

****Secluded Style and Modern Luxury**** Nestled discreetly on the coveted Hatton Avenue, this contemporary detached bungalow offers an unparalleled sense of privacy and a truly captivating aesthetic. Both inside and out, this property exudes a remarkable 'wow factor' that is sure to impress.



At the heart of the home lies an expansive open-plan living space, a haven of modern luxury.

Featuring a stunning fitted kitchen, a cozy log-burning stove, and bi-fold doors that bathe the room in natural light from two sides, this area is perfect for both relaxation and entertaining.

The front of the property houses three generous double bedrooms, a stylish family bathroom, and a luxurious en-suite to the master bedroom. Outside, beautifully landscaped gardens offer multiple decked areas, an inviting outdoor bar, and ample space for alfresco dining. To complete this exceptional package, a garage and off-street parking are also provided.

This is an extraordinary opportunity to acquire a home that effortlessly blends style, comfort, and outdoor living.



GROUND FLOOR
1338 sq.ft. (124.3 sq.m.) approx.

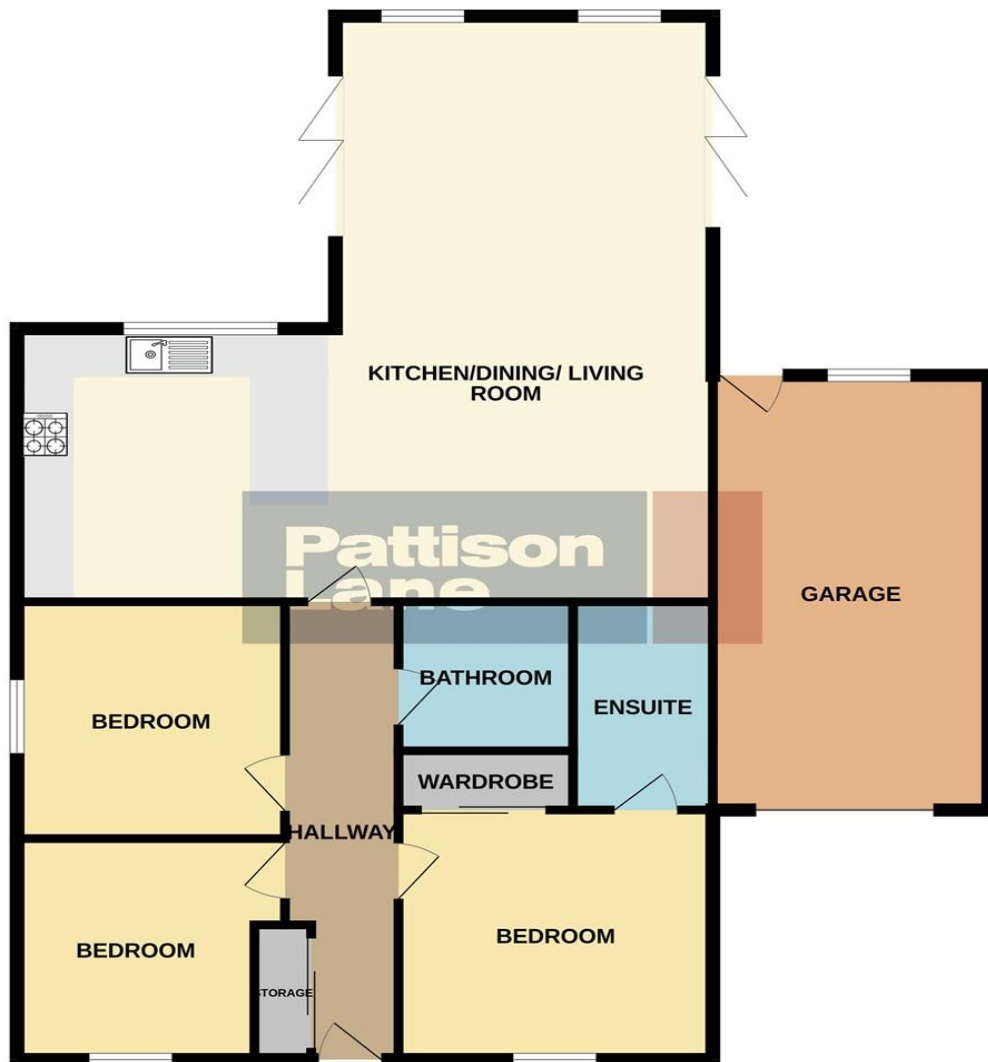

The Accommodation Comprises of;

ENTRANCE HALL

OPEN PLAN KITCHEN / DINING / LIVING ROOM
(L shape) 27'10 max x 26'8 max (8.48m x 8.12m)

BEDROOM ONE 11'9 plus recess x 11'4 plus
wardrobe (3.58m x 3.45m)

EN SUITE

BEDROOM TWO 10'6 x 10'2 (3.20m x 3.09m)

BEDROOM THREE 10'6 x 10'1 (3.20m x 3.07m)

BATHROOM

OUTSIDE

FRONT GARDEN

LARGE DRIVEWAY & GARAGE

REAR GARDEN

To view this property call Pattison Lane on:
01536 524425

TOTAL FLOOR AREA : 1338 sq.ft. (124.3 sq.m.) approx.

Whilst every attempt has been made to ensure the accuracy of the floorplan contained here, measurements of doors, windows, rooms and any other items are approximate and no responsibility is taken for any error, omission or mis-statement. This plan is for illustrative purposes only and should be used as such by any prospective purchaser. The services, systems and appliances shown have not been tested and no guarantee as to their operability or efficiency can be given.
Made with Metropix ©2024

Selling your property?

Contact us to arrange a **FREE** home valuation.

 01536 524425

 68-70 Gold Street, Kettering, Northamptonshire, NN16 8JB

 kettering@pattisonlane.co.uk

 www.pattisonlane.co.uk



 SCAN ME



 SCAN ME



Sharman Quinney Holdings Limited is registered in England and Wales under company number 4174227, Registered Office is Cumbria House, 16-20 Hockliffe Street, Leighton Buzzard, Bedfordshire, LU7 1GN. VAT Registration Number is 500 2481 05.

1: These particulars do not constitute part or all of an offer or contract. 2: The measurements indicated are supplied for guidance only and as such must be considered incorrect. 3: Potential buyers are advised to recheck the measurements before committing to any expense. 4: Sharman Quinney has not tested any apparatus, equipment, fixtures, fittings or services and it is the buyers interests to check the working condition of any appliances. 5: Sharman Quinney has not sought to verify the legal title of the property and buyers must obtain verification from their legal representative. 6: Intending purchasers will be asked to produce identification documentation at a later stage and we would ask your co-operation in order that there will be no delay in agreeing the sale. Ref: KPL205629 - 0001

