



Avalon Court Cross Street, Rothwell **Leasehold** £140,000

**Pattison  
Lane**

# Key Features

2 1 D A

- Two Bedroom Maisonette
- Lounge / Dining Room
- Modern Fitted Kitchen
- Modern Fitted Bathroom
- Off Road Parking

We think that this split level two bedroom maisonette represents a fantastic first time purchase. Highlights to include a refitted kitchen, two well-proportioned bedrooms and two parking spaces to the rear. Viewing advised.



## ENTRANCE

Reached via main front door. Stairs rising to entrance hall.

## HALLWAY

Doors to bedroom two, lounge / dining room and kitchen. Stairs rising to first floor landing. Under stairs storage cupboard.

LOUNGE / DINING ROOM 19'8 x 10'2 max  
(5.99m x 3.09m)

Window to front aspect.

KITCHEN 7'1 x 10'8 (2.15m x 3.25m)

Fitted with modern units to base and wall with work surfaces over and tiles splashback surrounds. Stainless steel sink and drainer unit with mixer tap over. Integrated oven. Inset hob with chimney style cooker hood over. Plumbing and space for washing machine. Space for fridge / freezer. Floor lighting. Window to rear aspect.

BEDROOM TWO 14' x 5'10 (4.26m x 1.77m)

Window to rear aspect.

## FIRST FLOOR LANDING

Doors to bedroom one and bathroom. Airing cupboard.



GROUND FLOOR

1ST FLOOR

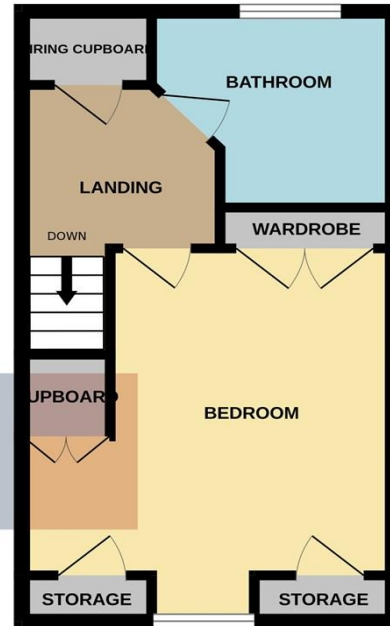
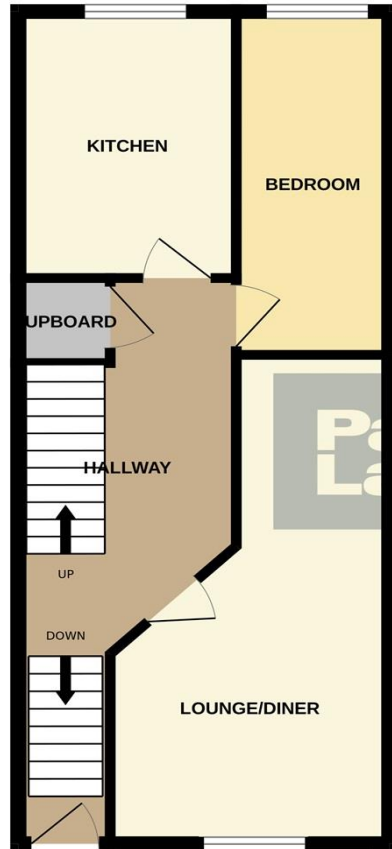

BEDROOM ONE 13'4 plus wardrobe x 9'11 plus recess (4.06m x 3.02m)  
Window to front aspect. Built in wardrobes.  
Storage cupboard.

### BATHROOM

Suite comprising a panelled bath with shower screen and shower over, wash hand basin and WC. Frosted window to rear aspect.

### AGENTS NOTE:

Length of lease 189 Years from 25 May 1990  
Service charge including ground rent: £362.99  
half yearly

Whilst every attempt has been made to ensure the accuracy of the floorplan contained here, measurements of doors, windows, rooms and any other items are approximate and no responsibility is taken for any error, omission or mis-statement. This plan is for illustrative purposes only and should be used as such by any prospective purchaser. The services, systems and appliances shown have not been tested and no guarantee as to their operability or efficiency can be given.  
Made with Metropix ©2024

To view this property call Pattison Lane on:  
**01536 524425**

# Selling your property?

Contact us to arrange a **FREE** home valuation.

 01536 524425

 68-70 Gold Street, Kettering, Northamptonshire, NN16 8JB

 [kettering@pattisonlane.co.uk](mailto:kettering@pattisonlane.co.uk)

 [www.pattisonlane.co.uk](http://www.pattisonlane.co.uk)



 SCAN ME



Sharman Quinney Holdings Limited is registered in England and Wales under company number 4174227, Registered Office is Cumbria House, 16-20 Hockliffe Street, Leighton Buzzard, Bedfordshire, LU7 1GN. VAT Registration Number is 500 2481 05.

1: These particulars do not constitute part or all of an offer or contract. 2: The measurements indicated are supplied for guidance only and as such must be considered incorrect. 3: Potential buyers are advised to recheck the measurements before committing to any expense. 4: Sharman Quinney has not tested any apparatus, equipment, fixtures, fittings or services and it is the buyers interests to check the working condition of any appliances. 5: Sharman Quinney has not sought to verify the legal title of the property and buyers must obtain verification from their legal representative. 6: Intending purchasers will be asked to produce identification documentation at a later stage and we would ask your co-operation in order that there will be no delay in agreeing the sale. Ref: KPL205410 - 0004

