



17 Brickfield Court Bath Road, Slough, SL1 3FX
Offers in excess of £150,000

 **HORLER**

17 Brickfield Court Bath Road, Slough, SL1 3FX

Located in the heart of Slough, this beautifully presented one-bedroom first-floor apartment in Brickfield House on Bath Road offers a perfect blend of comfort and convenience. The property is ideally situated, providing easy access to local amenities and excellent transport links, making it an attractive option for both professionals and couples.

Call today on 01753 621234 to arrange a viewing



Property Summary

Located in the heart of Slough, this beautifully presented one-bedroom first-floor apartment in Brickfield House on Bath Road offers a perfect blend of comfort and convenience. The property is ideally situated, providing easy access to local amenities and excellent transport links, making it an attractive option for both professionals and couples.

Upon entering the apartment, you are greeted by a spacious living room that seamlessly integrates with a well-appointed kitchen area. This open-plan design creates a welcoming atmosphere, perfect for both relaxation and entertaining guests. The large living space is filled with natural light, enhancing the overall appeal of the home.

The double bedroom is a tranquil retreat, featuring fitted wardrobes that provide ample storage space while maintaining a clean and tidy aesthetic. The bathroom is well-designed, offering modern fixtures and a soothing environment for your daily routines.

This apartment not only boasts a stylish interior but also benefits from its prime location, allowing residents to enjoy the vibrant community of Slough. With its proximity to shops, restaurants, and transport options, this property is an excellent choice for those seeking a comfortable and convenient lifestyle as well as having its own gymnasium and underground parking.

In summary, this one-bedroom apartment in Brickfield House is a delightful opportunity for anyone looking to settle in a well-connected area of Slough. With its appealing features and prime location, it is sure to attract interest from a variety of potential buyers or renters.

General Information

Service Charge £1468.21 annually

Ground Rent £185 every 6 months

Length of lease 990-992 years

Legal Note

Although these particulars are thought to be materially correct their accuracy cannot be guaranteed and they do not form part of any contract.





Brickfield House SL1

Approximate Gross Internal Floor Area = 35.6 sq m / 384 sq ft

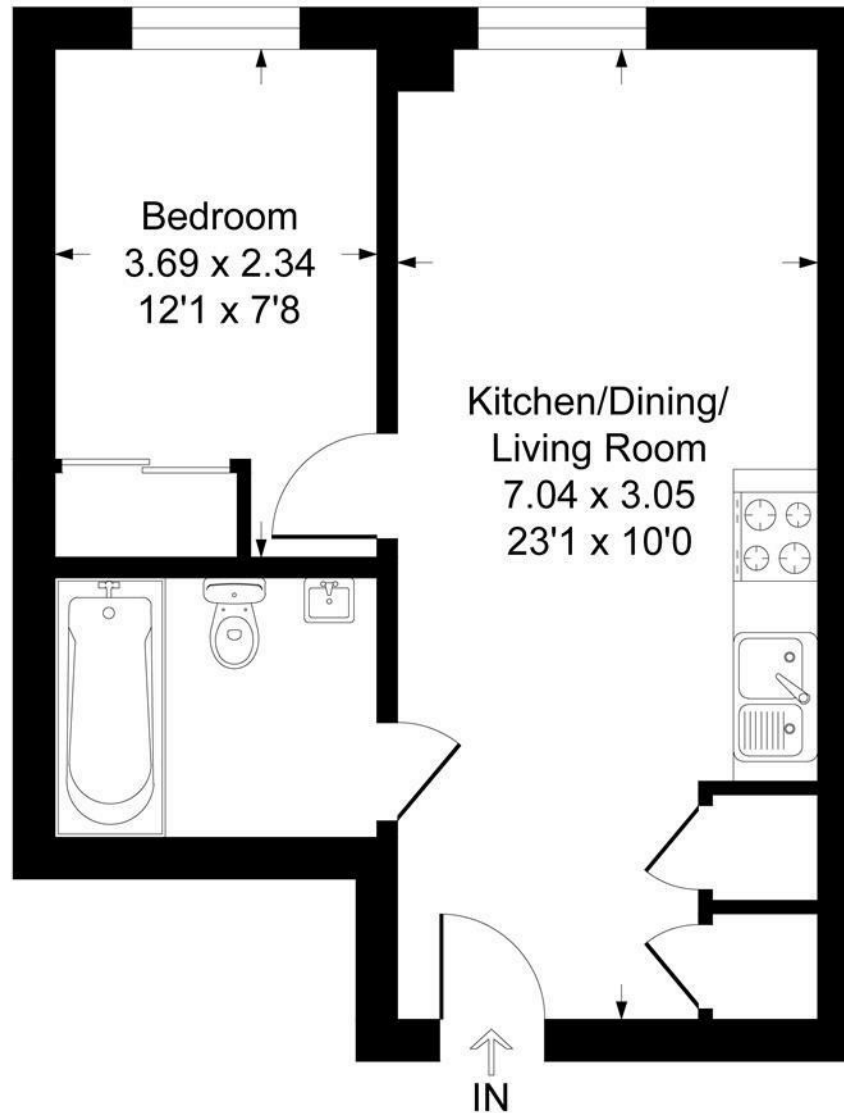

Illustration for identification purposes only, measurements are approximate, not to scale.
Produced By Esjay Property Marketing