



2b Ruddlesway, Windsor, Berkshire, SL4 5SQ
£1,250,000

2b Ruddlesway, Windsor, Berkshire, SL4 5SQ

Nestled in the charming area of Ruddlesway, Windsor, this recently extended and beautifully renovated four-bedroom detached family home offers an exceptional living experience. Spanning over 2400 square feet, the property is ideally suited for growing families seeking both space and comfort.



Key Features.

*Central air conditioning 1st floor and 2 split units ground floor.

*-Ground floor boasts complete underfloor heating. With recently installed complete central heating system, designer radiators and top of the range megaflo boiler system as well as air heating and summer cooling system.

*-Recently installed double glazing and bifold doors.

*-Fitted wardrobes in all the bedrooms

*-Branded kitchen appliances

Property Summary.

Nestled in the charming area of Ruddlesway, Windsor, this recently extended and beautifully renovated four-bedroom detached family home offers an exceptional living experience. Spanning over 2400 square feet, the property is ideally suited for growing families seeking both space and comfort.

Upon entering, you are greeted by three elegantly designed reception rooms, perfect for entertaining guests or enjoying quiet family time. The outdoor space is equally impressive, featuring a fully fitted summer house that extends your living area into the garden, making it an ideal spot for relaxation or social gatherings.

The home boasts four generously sized double bedrooms, ensuring ample space for everyone. The principle bedroom is particularly noteworthy, complete with a modern ensuite shower room that adds a touch of luxury to your daily routine.

The West-facing gardens provide a delightful outdoor retreat, allowing you to bask in the afternoon sun. Additionally, the property offers off-street parking for at least three vehicles, ensuring convenience for you and your guests.

This stunning home in Windsor combines modern living with a family-friendly atmosphere, making it a perfect

choice for those looking to settle in a vibrant community. Don't miss the opportunity to make this exquisite property your new family haven.

Legal note

Although these particulars are thought to be materially correct, their accuracy cannot be guaranteed and they do not form part of any contract.





Ruddlesway SL4

Approximate Gross Internal Floor Area = 216.9 sq m / 2335 sq ft

Outbuilding Area = 14.3 sq m / 154 sq ft

Total Area = 231.2 sq m / 2489 sq ft

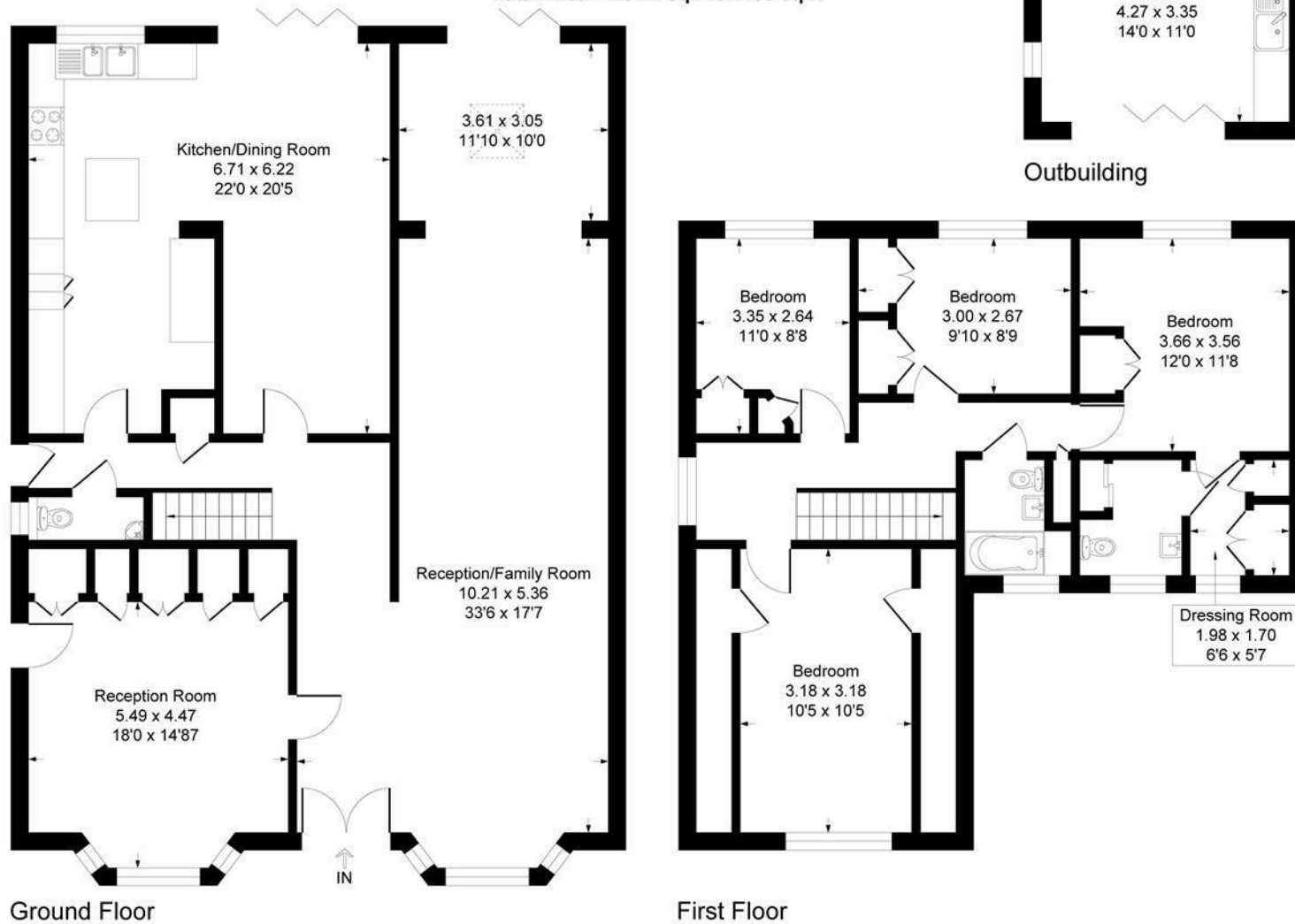

Illustration for identification purposes only, measurements are approximate, not to scale.
Produced By Esjay Property Marketing