



41 Stewart Close, Fifield, Berkshire, SL6 2PD
£695,000

 **HORLER**

41 Stewart Close, Fifield, Berkshire, SL6 2PD

Nestled in the charming cul-de-sac of Stewart Close in Fifield, Maidenhead, this exquisite semi-detached house offers a delightful blend of modern living and serene surroundings. With a generous footprint of nearly 1800 square feet, the property boasts four well-appointed bedrooms and three inviting reception rooms, making it an ideal family home.



Lettings Limited has an interest in this property.

Property Summary.

Nestled in the charming cul-de-sac of Stewart Close in Fifield, Maidenhead, this exquisite semi-detached house offers a delightful blend of modern living and serene surroundings. With a generous footprint of nearly 1900 square feet, the property boasts four well-appointed bedrooms and three inviting reception rooms, making it an ideal family home.

The heart of this residence is undoubtedly the stunning kitchen and living area, which has been thoughtfully extended by the current owners. This space is equipped with state-of-the-art appliances, including an induction hob, double Bosch ovens, and an integrated Bosch coffee machine, ensuring that culinary enthusiasts will feel right at home. The instant hot water Quooker tap adds a touch of convenience, keeping the elegant stone worktops free from clutter.

Bifold doors seamlessly connect the interior to a raised decked area, flooding the space with natural light and providing a perfect setting for outdoor entertaining while enjoying the uninterrupted west-facing views to the rear.

In addition to the main living areas, the property features a utility room and extra storage space, catering to all your organisational needs. The beautifully presented interiors create a warm and inviting atmosphere throughout, making it easy to envision yourself settling in.

Parking is a breeze with off-road space for Three vehicles, ensuring that you and your guests will always have a convenient place to park. This home is not just a property; it is a lifestyle choice, set in a picturesque semi-rural location that offers both tranquillity and accessibility to local amenities. This is a rare opportunity to acquire a beautifully maintained home in a sought-after area. Located within the catchment for Holyport College.

Legal Note

Please Note:- A Director of Horler and associates

****Although these particulars are thought to be materially correct, their accuracy cannot be guaranteed and they do not form part of any contract.****





Total Approximate Floor Area
1872 Square feet
174 Square metres

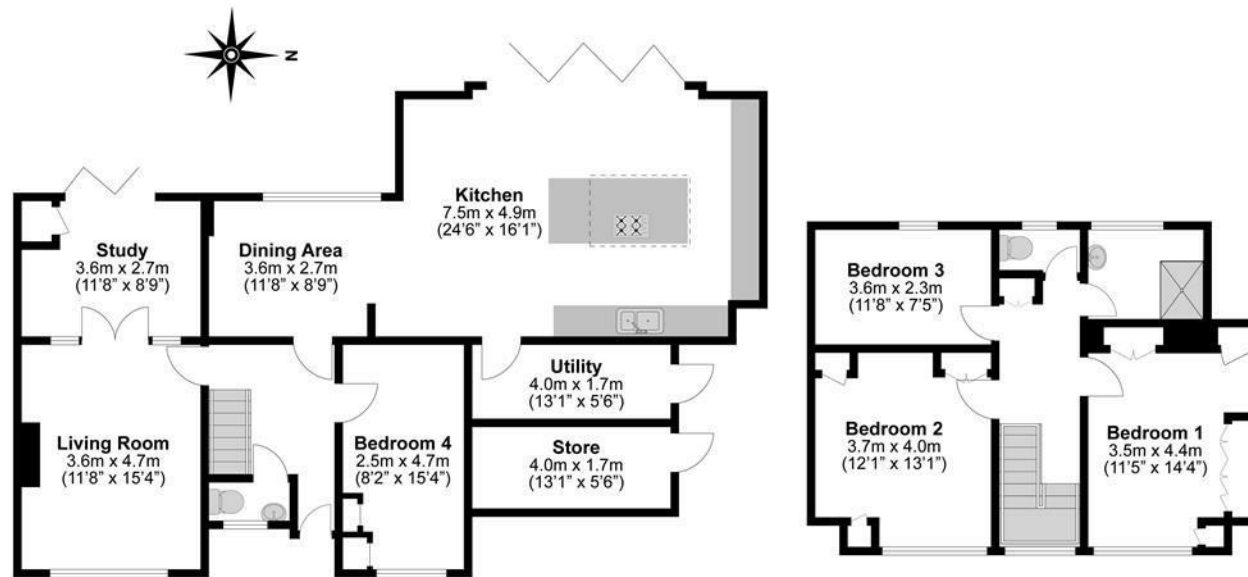

**Illustrations are for identification purposes only,
measurements are approximate, not to scale.**