



4a Centre Road Willows Riverside Park, Windsor, SL4 5TU
£225,000

4a Centre Road Willows Riverside Park, Windsor, SL4 5TU

2 bed double unit located Willows Riverside Park to the West of Windsor and close to local amenities, schools and transport links. Large living room with adjacent kitchen/diner. Family shower room. Wrap around garden with patio area and off road parking to the front of the property for 2 vehicles.

Located within the scenic surroundings of Willows Riverside Park, to the west of Windsor, this well-presented double unit offers a delightful living experience. The property boasts two spacious double bedrooms, each equipped with fitted wardrobes, providing ample storage for your belongings.



Property Summary

The large living room is a perfect space for relaxation and entertainment, seamlessly connecting to the adjacent kitchen and dining area, making it ideal for family gatherings or hosting friends. The family shower room is conveniently located, ensuring comfort and practicality for everyday living. This unit can comes fully furnished being less than a year old, and being minuets walk to private river access.

One of the standout features of this home is the wrap-around garden, which includes a charming patio area, perfect for enjoying al fresco dining or simply unwinding in the fresh air. Which will gain sunlight all day around. In addition there is a garden shed.

Additionally, the property benefits from off-street parking at the front, for up to two cars, offering convenience and ease for residents and visitors alike.

This charming home in Willows Riverside Park is not just a property; it is a lifestyle choice, combining comfort, space, and a picturesque setting. Whether you are looking to settle down or seeking a peaceful retreat, this residence is sure to impress.

General Information

No Onward Chain

Council Tax Band 'A'

Family Park - No Age Restrictions - NO PETS ALLOWED

Months Site Fees - TBC

Mains Gas

No Stamp Duty

Legal Note

Although these particulars are thought to be materially correct, their accuracy cannot be guaranteed and they do not form part of any contract.





Centre Road SL4

Approximate Gross Internal Floor Area = 52.1 sq m / 562 sq ft

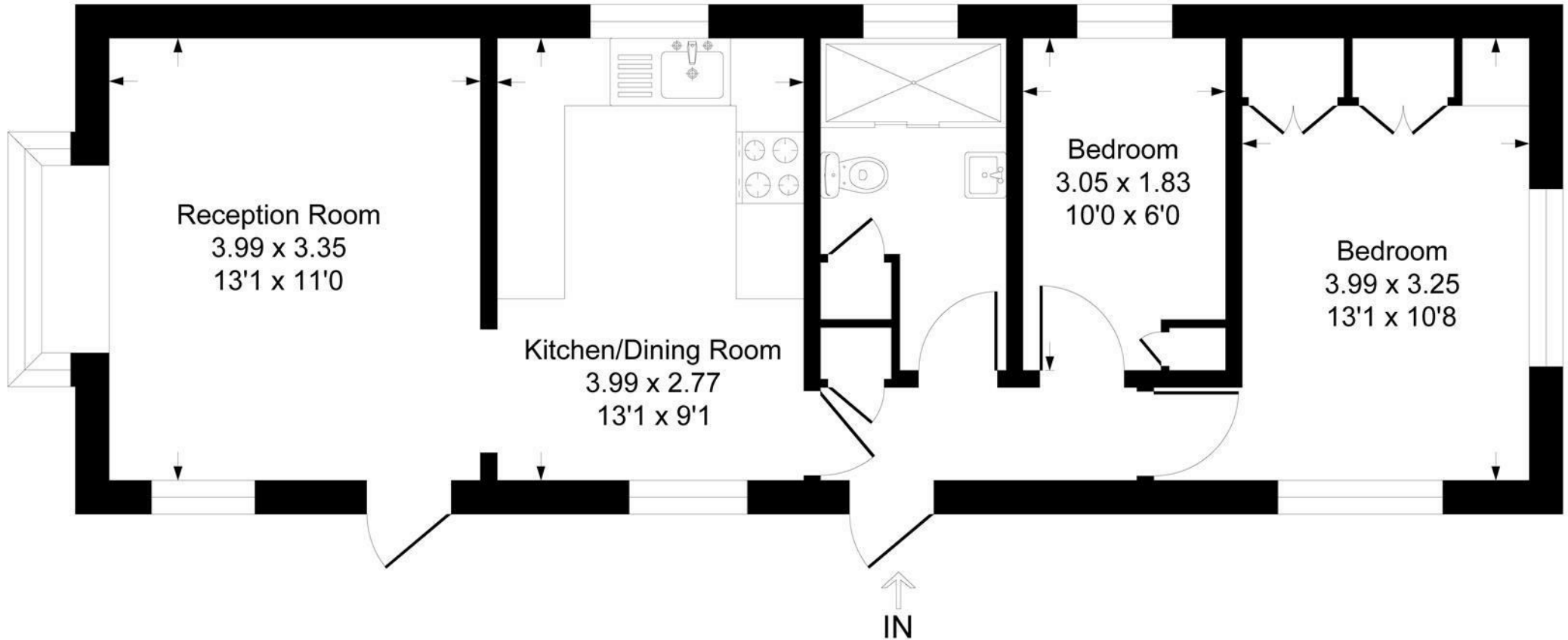

Illustration for identification purposes only, measurements are approximate, not to scale.
Produced By Esjay Property Marketing