



59 St. Andrews Crescent, Windsor, SL4 4EP
£550,000

 **HORLER**

59 St. Andrews Crescent, Windsor, SL4 4EP

Nestled in the prestigious St. Andrews Crescent in Windsor, this two-bedroom detached bungalow presents a rare opportunity for those seeking a property with immense potential. The generous rear garden offers ample space for outdoor activities and relaxation, while the off-street parking can accommodate multiple vehicles with ease.



The property boasts good-sized double rooms, providing comfortable living spaces for individuals or families. Situated within walking distance of local schools, amenities, and transport links, this home offers convenience and accessibility at its finest.

With the possibility of development, subject to planning permission, this property is not just a home but a canvas for your imagination. Don't miss out on the chance to own a piece of this sought-after crescent in Windsor.

General Information:

Council Tax Band: E

Freehold

Legal Note:

****Although these particulars are thought to be materially correct their accuracy cannot be guaranteed and they do not form part of any contract**.**





St Andrews Crescent SL4

Approximate Gross Internal Floor Area = 77.5 sq m / 835 sq ft

Garage Area = 13.5 sq m / 146 sq ft

Total Area = 91.0 sq m / 981 sq ft

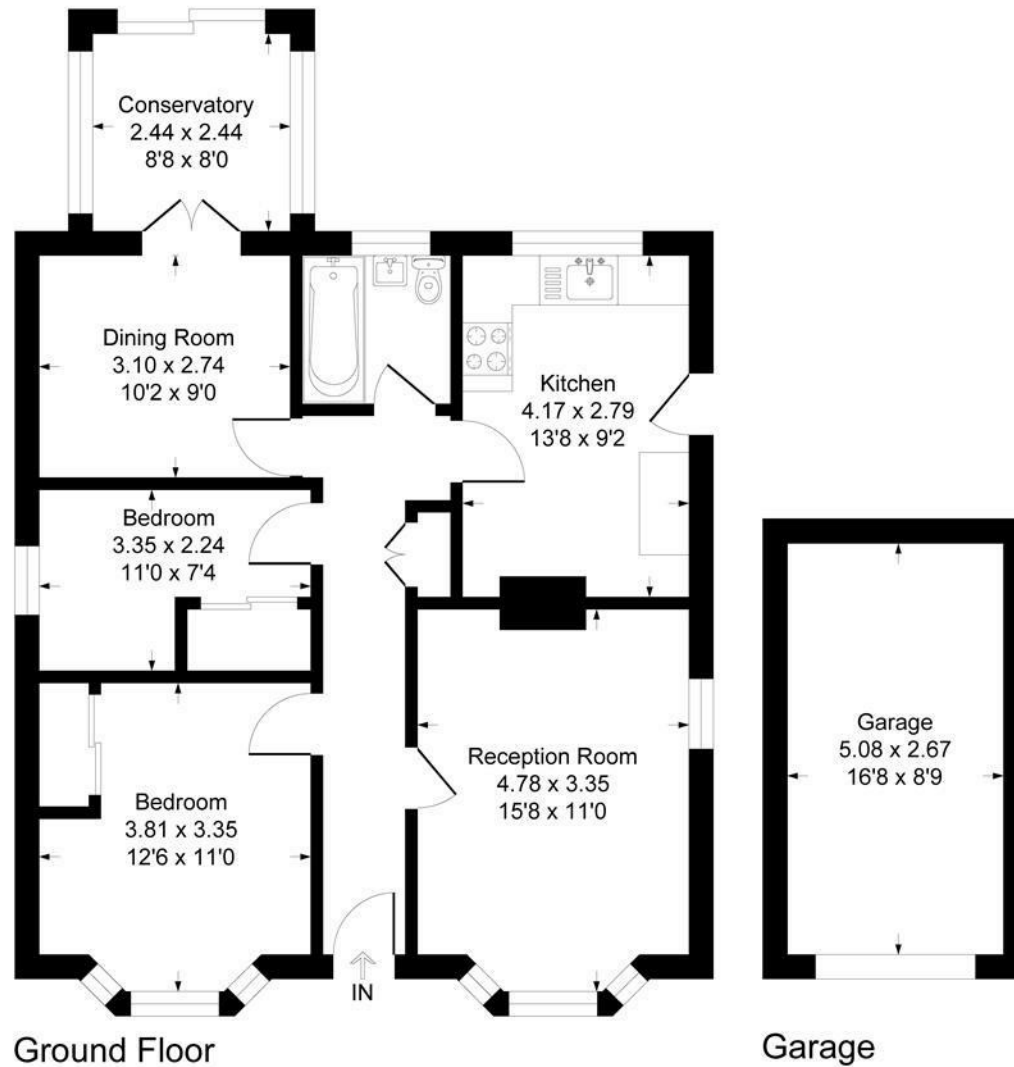

Illustration for identification purposes only, measurements are approximate, not to scale.
Produced By Esjay Property Marketing