



11, Cleves Court Firs Avenue, Windsor, Berkshire, SL4 4EF  
£285,000

 **HORLER**

## 11, Cleves Court Firs Avenue, Windsor, Berkshire, SL4 4EF

Located on the prestigious Firs Avenue in Windsor, this stunning top floor apartment is a gem waiting to be discovered. Boasting 2 bedrooms and 2 bathrooms, this property is perfect for those seeking a comfortable and modern living space.



As you step inside, you are greeted by a beautifully presented interior that exudes elegance and style. The spacious bedrooms offer a peaceful retreat, with the master bedroom featuring its own ensuite for added convenience.

The fully fitted and modern kitchen, offering not only functionality but also stunning views overlooking Clewer Green and West Windsor.

The apartment also features a generously sized living room, perfect for relaxing or entertaining guests. With allocated parking for 2 vehicles, parking will never be an issue for you or your visitors.

The property also offers triple glazed windows throughout and access to a communal garden to the rear of the development.

Conveniently situated within walking distance to a variety of local amenities, schools, and transport links, this property offers the perfect blend of comfort and accessibility. Whether you're looking to run daily errands or explore the beauty of Windsor, everything you need is just a stone's throw away.

Don't miss out on this fantastic opportunity to own a piece of luxury in one of Windsor's most desirable locations. With the added benefit of being offered with No Onward Chain, this apartment is ready and waiting for you to make it your own.

#### **General Information:**

Lease Length Remaining: 152 years

Service Charge: £2,431.33 per Annum

Ground Rent: Nil

Council Tax: D

#### **Legal Note:**

\*\*Although these particulars are thought to be materially correct, their accuracy cannot be guaranteed and they do not form part of any contract.\*\*





# Cleves Court SL4

Approximate Gross Internal Floor Area = 57.7 sq m / 622 sq ft

Kitchen  
2.74 x 2.44  
9'0 x 8'0

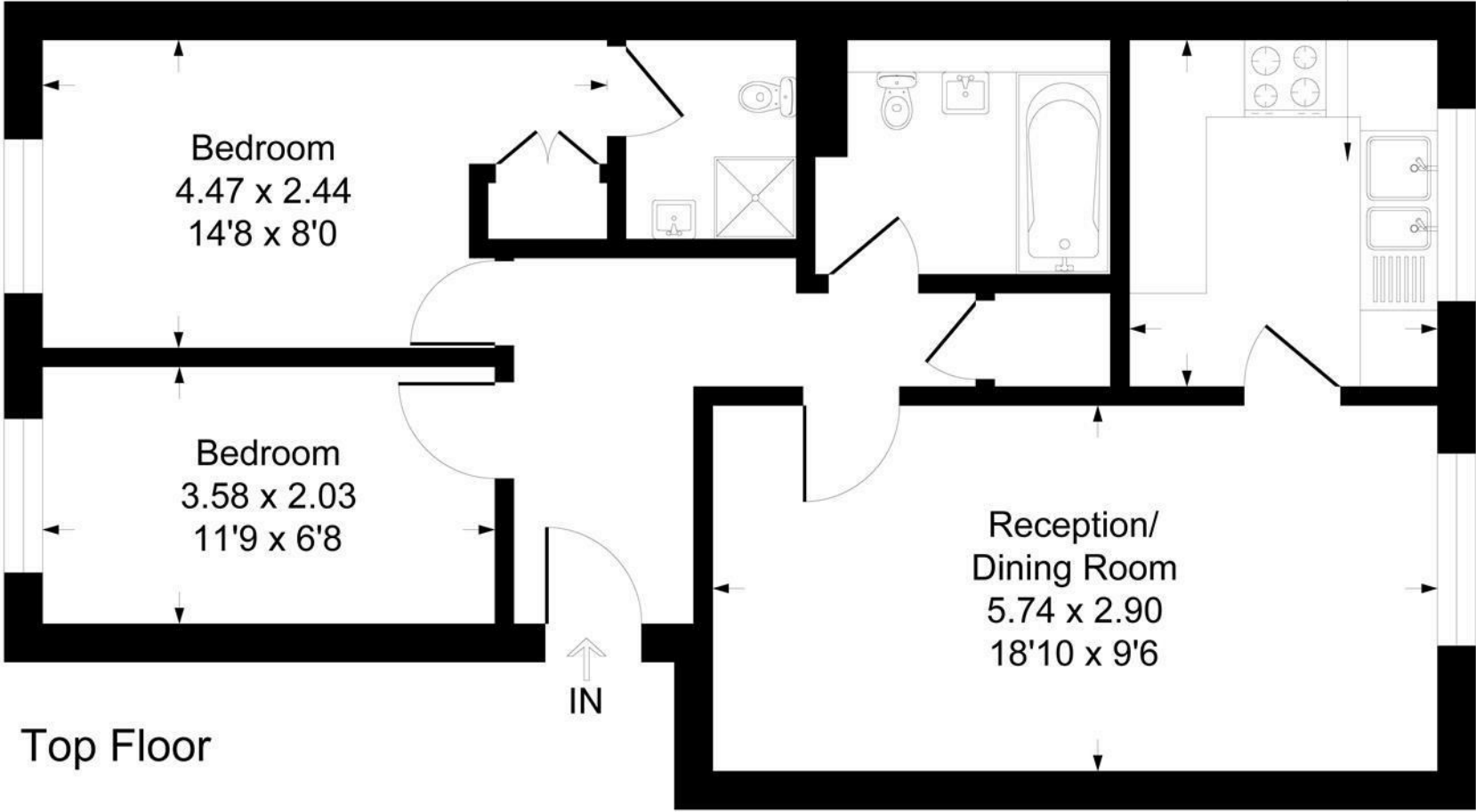

Top Floor

Illustration for identification purposes only, measurements are approximate, not to scale.  
Produced By Esjay Property Marketing