



**8 Croft Corner, Old Windsor, Windsor, SL4 2PJ**  
**£450,000**

 **HORLER**



## 8 Croft Corner, Old Windsor, Windsor, SL4 2PJ

Located in the charming village of Old Windsor, this delightful three-bedroom terraced house at Croft Corner. Boasting a prime location in the heart of the village, this family home offers ample potential and the opportunity to extend, making it a perfect canvas for your dream living space.



### **Property Summary.**

Located in the charming village of Old Windsor, this delightful three-bedroom terraced house at Croft Corner. Boasting a prime location in the heart of the village, this family home offers ample potential and the opportunity to extend, making it a perfect canvas for your dream living space.

The property features a lovely West-facing garden, ideal for enjoying sunny afternoons and al fresco dining. With the added convenience of a garage in a separate block with its own access, you'll have plenty of space for storage or parking. Additionally, the off-road parking to the front ensures that you and your guests will always have a convenient place to park.

Step inside to find a cosy lounge that seamlessly flows into an extended living room at the rear, providing a versatile space for relaxing and entertaining. The fitted kitchen is basic at the moment but does have heaps of potential to be remodelled in to the living space across the back of the home with doors leading to the gardens.

Don't miss out on the opportunity to make this property your own and create a warm and inviting home in the heart of Old Windsor. With its desirable location, potential for extension, and a range of features to enjoy, this house is just waiting for you to add your personal touch and make it truly special.

### **Legal Note.**

**\*\*Although these particulars are thought to be materially correct their accuracy cannot be guaranteed and they do not form part of any contract\*\***

### **Council tax band D.**











# Croft Corner SL4

Approximate Gross Internal Floor Area = 96.7 sq m / 1042 sq ft

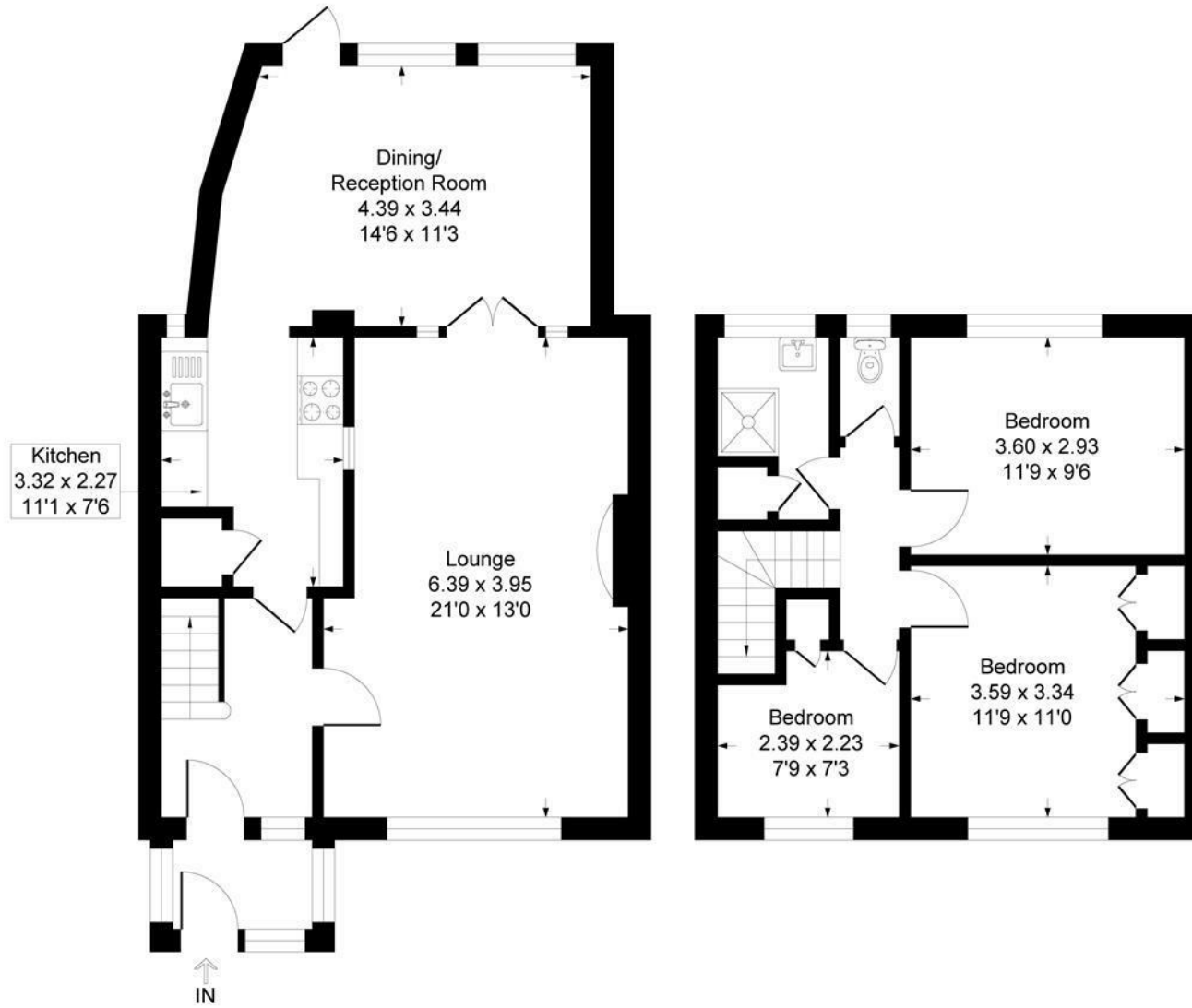

Ground Floor

First Floor

Illustration for identification purposes only, measurements are approximate, not to scale.  
Produced By Esjay Property Marketing