



**9, Oliver Court Patricia Close, Slough, SL1 5HE**  
**£299,950**

 **HORLER**



## 9, Oliver Court Patricia Close, Slough, SL1 5HE

Nestled in the charming Patricia Close, Slough, this delightful 1st-floor 2-bedroom, 2-bathroom apartment in Oliver Court, Cippenham, offers a perfect blend of comfort and convenience



## Property Summary

As you step inside this delightful 2 bed/2 bathroom apartment you are greeted by an inviting open plan living/dining room, ideal for relaxing or entertaining guests. The separate fully fitted kitchen boasts both base and high level units, along with integral appliances, making meal preparations a breeze.

The main double bedroom comes complete with an ensuite shower providing private sanctuary within your home. Additionally, there is a cosy single bedroom and a separate family bathroom ensuring ample space for all your needs.

This property also features an entry phone system for added security and peace of mind, as well as allocated parking space, making coming home a stress free experience.

With its prime location close to local amenities, this apartment offers a wonderful opportunity to embrace a comfortable life style in the heart of Cippenham. Don't miss out on the opportunity to make this charming property your new home.

## General Information

Lease length 981 years

Service charge £113.96 per month

Council Tax Band 'D'

Ground Rent £200.00 per annum

## Legal Note

\*\*\*Although these particulars are thought to be materially correct their accuracy cannot be guaranteed and they do not form part of any contract\*\*\*











**Total Approximate Floor Area**

807 Square feet  
75 Square metres

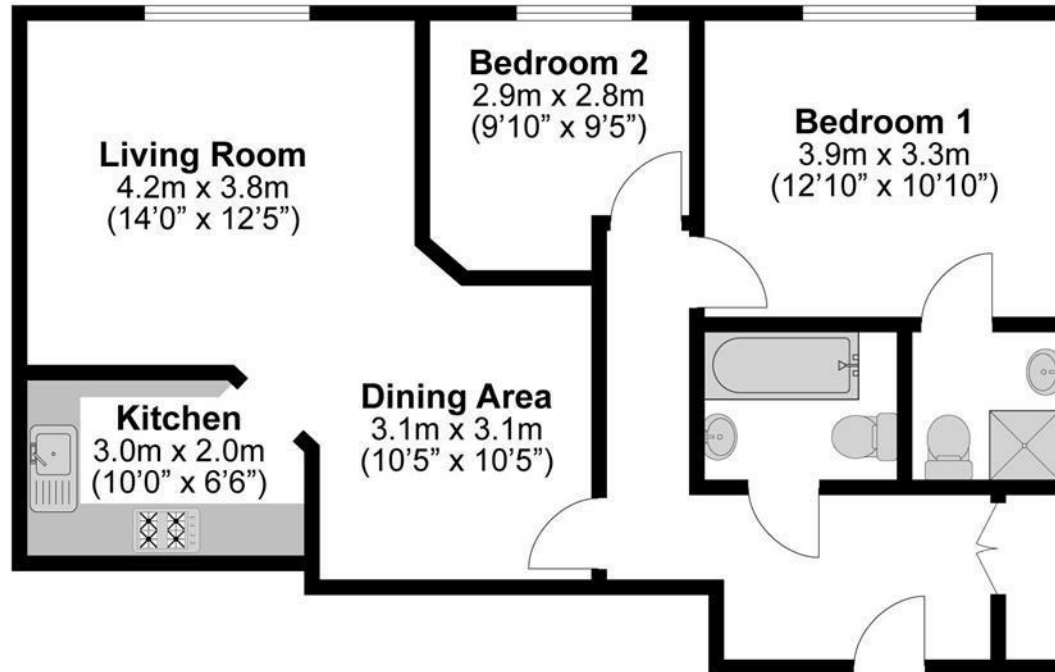

**Illustrations are for identification purposes only,  
measurements are approximate, not to scale.**