



19 The Meads Green Lane, Windsor, Berkshire, SL4 3TP  
£160,000

 **HORLER**

## 19 The Meads Green Lane, Windsor, Berkshire, SL4 3TP

A rarely available two double bedroom, first floor RETIREMENT APARTMENT located on the South side of this popular block. The property has just been redecorated throughout comprising a living through dining room, fitted kitchen, shower room, two double bedrooms. Also benefitting from having communal lounge, laundry room with washing/drying facilities and communal gardens. Residents' parking immediately in front of the property.

Viewings highly recommended, no onward chain. Please call 01753 621234 for immediate viewings.



### **Entrance**

Through a wooden front door into the hall which comprises of two cupboards housing the meters, water tank and provides ample storage, power point, doors leading to:

### **Living through dining room**

A bright room with a window overlooking the South side communal gardens, TV, telephone and power points, ample space for freestanding furniture, double glass panelled doors leading to:

### **Kitchen**

A fitted kitchen with a range of eye and base level units, integrated waist height oven, four ring electric hob with extractor fan above, inset stainless steel sink with drainer, under counter space for two appliances, window over South aspect, tiled walls, power points.

### **Bedroom one**

A double bedroom with a large range of fitted drawers, cupboards and wardrobes comprising of hanging and shelving space, window overlooking the gardens, wall mounted electric heater, aerial, TV and power points.

### **Bedroom two**

A second double bedroom with a window over the gardens, space for freestanding furniture, wall mounted electric heater and power points.

### **Bathroom**

A three piece white suite (recently fitted) benefitting from a double shower cubicle, vanity wash hand basin with cupboards beneath, low level W.C, wall mounted mirror unit with light and shaver points, heated towel rail, tiled walls and vinyl flooring.

### **General Information**

Annual Service Charge £4953.68 paid 6 monthly (01Mar-31Aug/01Sep-28Feb) - Water rates included.  
Annual Ground Rent £570.12 paid 6 monthly (01Mar-31Aug/01Sep-28Feb)  
93 years left on lease  
Council Tax Band 'D'

### **Legal note**

**\*\*Although these particulars are thought to be materially correct, their accuracy cannot be guaranteed and they do not form part of any contract.\*\***





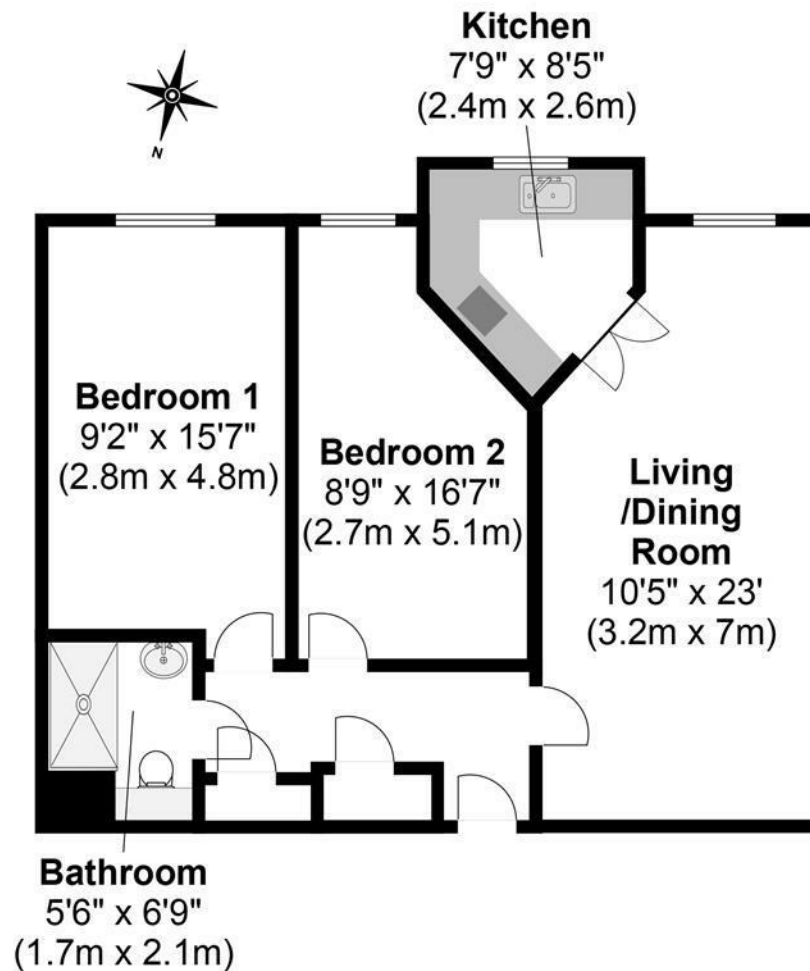

**Illustrations are for identification purposes only,  
measurements are approximate, not to scale.**