



19 Shepherds Hill, Bracknell, RG12 2LS
Guide price £675,000

 **HORLER**

19 Shepherds Hill, Bracknell, RG12 2LS

DETACHED FAMILY HOME WITH ANNEXE Located within a short proximity to Bracknell Town Centre, is this well-presented five bedroom detached family home offered to the market with **NO ONWARD CHAIN**.

To the ground floor is an entrance hallway, a spacious living room & dining room with sliding doors to the rear, kitchen, utility room, study and downstairs washroom. The first floor consists of a master bedroom with fitted wardrobe space and the benefit of a four-piece bath & shower suite. Furthermore a second double bedroom, also with fitted wardrobes, third and fourth bedrooms and a family bathroom with a bath-suite piece.

Externally the property has its own detached annexe acting as a one bedroom studio with a kitchen area and bathroom. Driveway to the front for multiple cars and a well-maintained rear garden. Viewings are highly recommended.







Total Approximate Floor Area

1712 Square Feet

159 Square metres

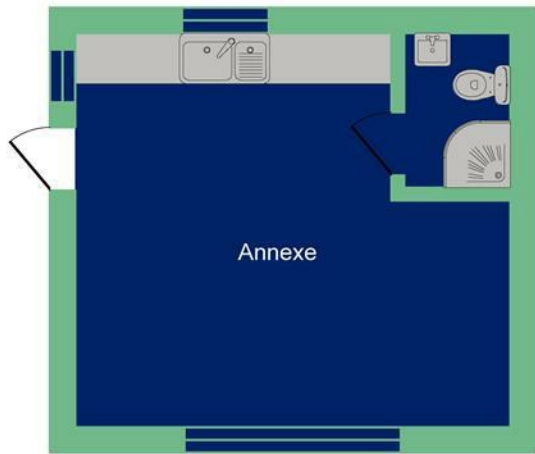

Outbuilding



Ground Floor

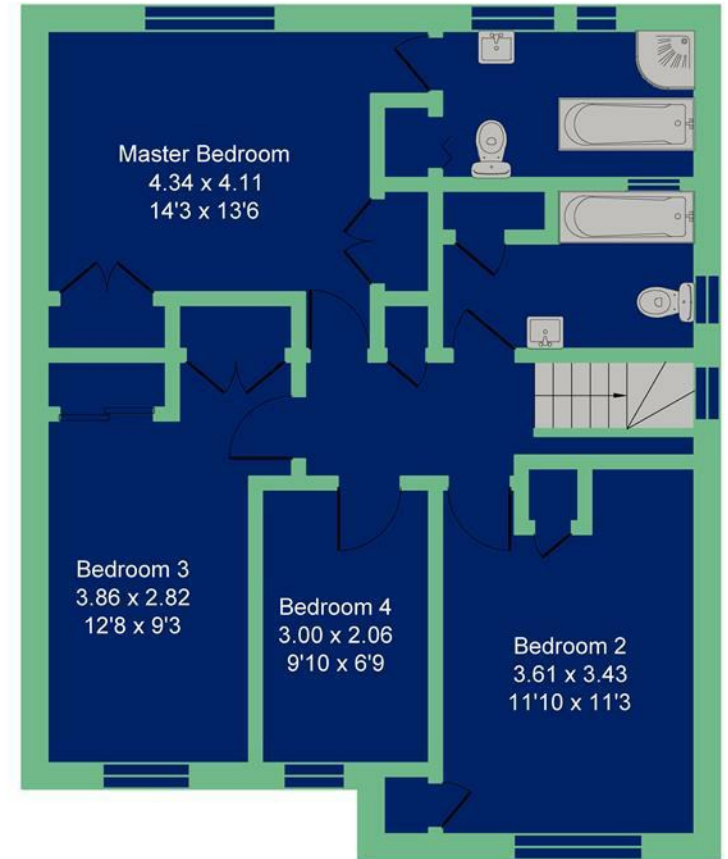

First Floor

Illustration for identification purposes only,
measurements are approximate, not to scale.