



251 Dedworth Road, Windsor, SL4 4JS
£495,000

 **HORLER**

251 Dedworth Road, Windsor, SL4 4JS

An end of terrace town house property situated to the West of Windsor and close to local amenities, schools and catchment areas. The property has 4/5 bedrooms and is laid out over three floors with 2 kitchens and 2 bathrooms with open plan living areas on the ground and first floor. There is a secluded garden to the rear of the property with a patio and lawn.

Don't delay.....please call today on 01753 621234 for viewings.



Entrance - First Floor apartment

Enter through a partially glazed UPVC front door with access to staircase leading to first floor.

Livingroom:

With front aspect UPVC double glazed window, wall mounted radiator, low level TV and power points, staircase leading to first floor and open doorway to kitchen.

Kitchen:

With dual rear aspect UPVC double glazed windows, a range of eye and base level units, built in oven, gas hob with overhead extractor fan, inset kitchen sink with hot and cold mixer tap, space for freestanding washing machine, drier and fridge freezer, laminated wood flooring and power points.

Bedroom One:

With front aspect UPVC double glazed window, power points, radiator, fitted storage and laminate wood flooring.

Bedroom Two:

With rear aspect UPVC double glazed window, fitted wardrobe, laminate wood flooring, radiator and power points.

Bedroom Three:

With front aspect UPVC double glazed window, fitted storage, radiator, laminate wood flooring and power points.

Bathroom:

With rear aspect frosted UPVC double glazed window, fitted bath, low level wc, wall mounted wash hand basin, radiator, tiled walls and laminate flooring.

Entrance - Ground floor apartment

Enter through partially glazed UPVC front door with doorway to downstairs reception room with front aspect UPVC double glazed window, built in storage, laminate flooring and radiator.

Livingroom (Bedroom)

With front aspect UPVC double glazed window, fitted storage, radiator, laminate flooring and power points.

Bathroom:

With side aspect UPVC double glazed window, fitted bath, pedestal wash hand basin, low level wc, tiled walls and laminate flooring.

Kitchen/living/dining room

Galley style kitchen area with laminate tiled flooring, a range of eye and base level units with complementary work surface, double oven with gas hob and overhead extractor fan, space for freestanding washing machine, drier and fridge/freezer, power points and leading to open plan living/dining area with UPVC double glazed French doors to back garden, wood laminate flooring, radiator and power points.

Garden:

Paved patio area adjacent to the property and the remainder laid to lawn with timber fence surround.

Legal Note

Although these particulars are thought to be materially correct their accuracy cannot be guaranteed and they do not form part of any contract.

General information





Dedworth Road SL4

Approximate Gross Internal Floor Area = 114.0 sq m / 1227 sq ft

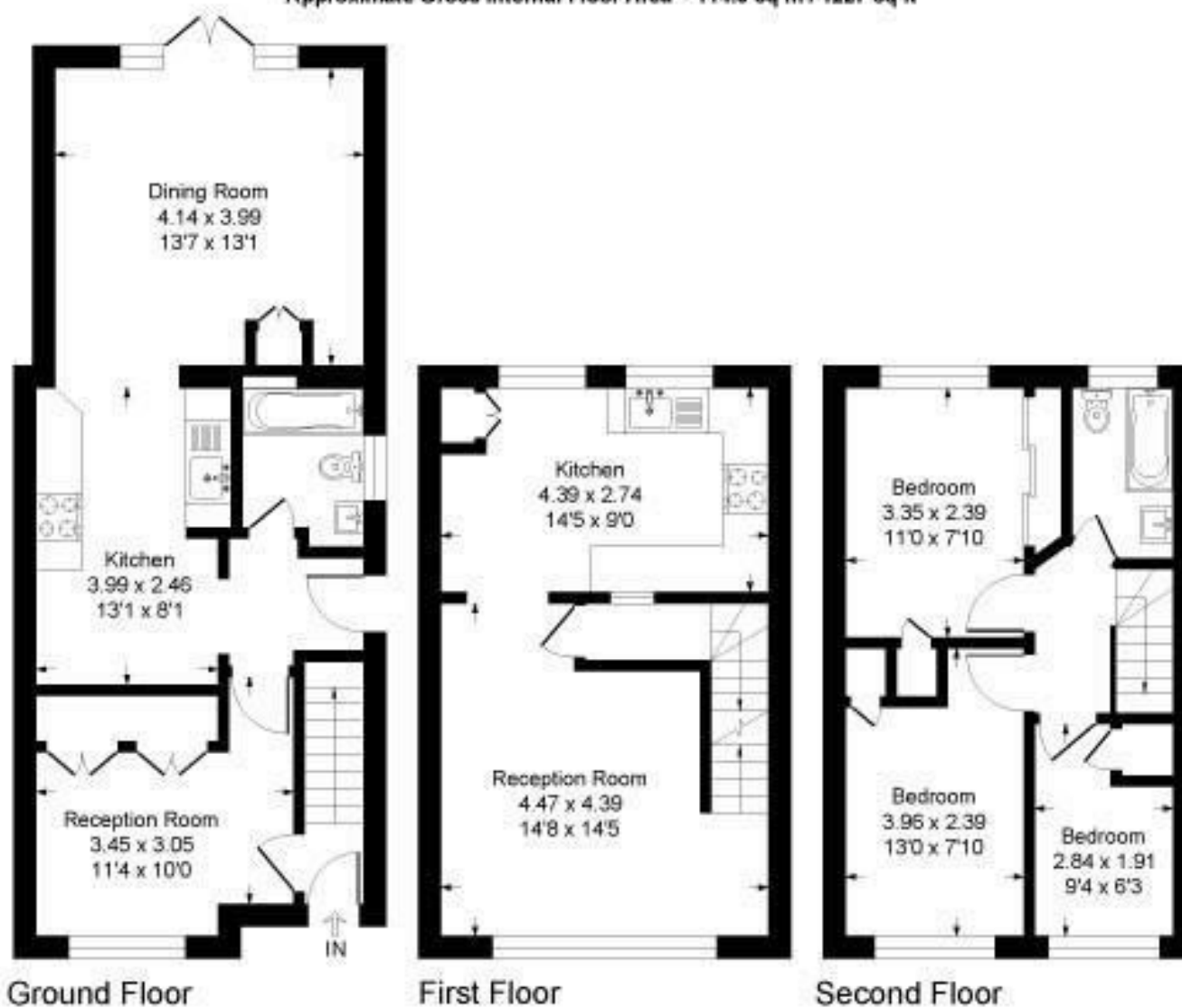

Illustration for identification purposes only, measurements are approximate, not to scale.
Produced By Esjay Property Marketing