



**11 Somerset Grove, Warfield, Bracknell, RG42 3TN**  
**Offers in the region of £950,000**

 **HORLER**

## 11 Somerset Grove, Warfield, Bracknell, RG42 3TN

Nestled in the charming Somerset Grove of Warfield, this prime property by Horler is a dream come true for those seeking a spacious family home. Boasting three reception rooms and four bedrooms spread across this detached house, there is no shortage of living space for the whole family to enjoy.

As you step into this inviting family home, you are greeted by an elegant entrance hallway that sets the tone for the rest of the house. The living room offers a cosy retreat, perfect for relaxing evenings with loved ones. The real gem of this home is the beautifully presented kitchen and dining room, complete with a stylish island, integrated appliances, and bi-folding doors that seamlessly blend the indoor and outdoor spaces. Imagine hosting gatherings with friends and family in this delightful setting, with ample space for both dining and lounging.

Additionally, the ground floor features a convenient utility room with a sink, adding a practical touch to this already impressive property. With three bathrooms spread throughout the house, morning routines will be a breeze for everyone in the family.

Located in a sought-after cul-de-sac within Warfield Village, this family home offers not just a place to live, but a lifestyle to be enjoyed. Don't miss the opportunity to make this well-presented property your own and create lasting memories in this wonderful space.









### Total Approximate Floor Area

2209 Square Feet

205 Square metres



Ground Floor

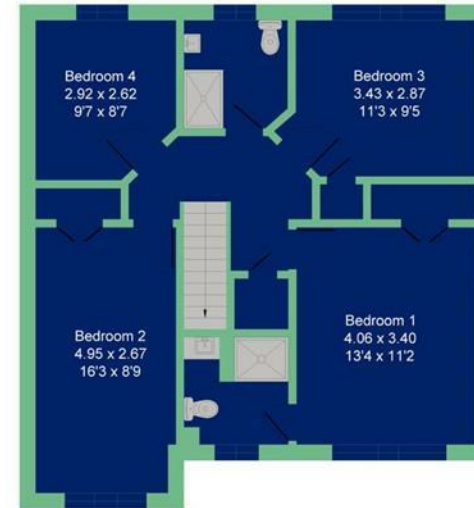

First Floor

Illustration for identification purposes only,  
measurements are approximate, not to scale.